

## BPAS Series



### Features

- RoHS compliant
- Low Rdc and high saturation current for portable DC to DC converter line
- High magnetic shielding construction provides high resolution for EMC protection
- Support lead-free soldering

### Applications

- Notebook PC
- Set top box
- LCD TV
- LCD displays
- Portable communication device
- DC/DC converters

### Product Identification

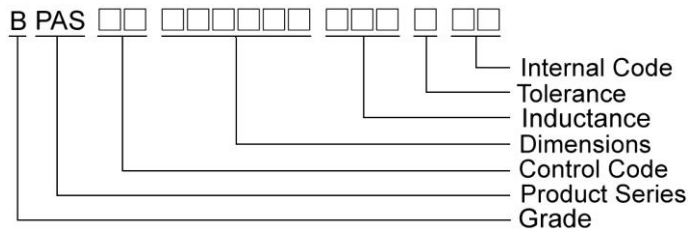

### Shape and Dimensions

### Recommended Pattern

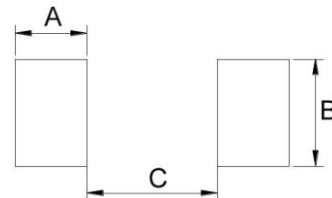
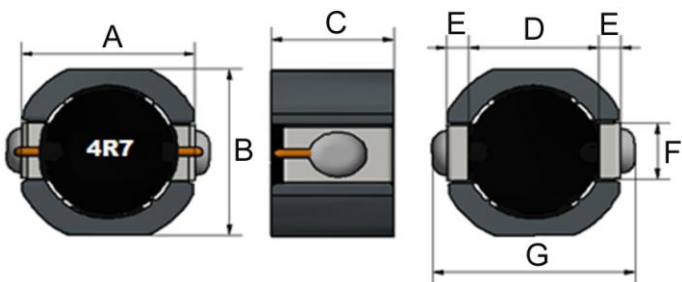

Dimensions in mm

TYPE	Shape and Dimensions							Recommended Pattern		
	A	B	C	D	E	F	G	A	B	C
BPAS00080845	7.5±0.5	7.5±0.5	4.5Max	3.6	2.0	2.0	9.5Max	2.4	2.2	3.3

## SMD Shielded Power Inductors – BPAS Series

### Standard Specifications

Part Number	Inductance (uH)	Tolerance (±%)	Test Frequency (kHz)	RDC (Ω)	Isat (A)Max	Irms (A)Typ	Marking
BPAS000808451R0□00	1.0	30	100	0.009±30%	8.5	11	1R0
BPAS000808451R5□00	1.5	30	100	0.010±30%	6.3	8.6	1R5
BPAS000808452R2□00	2.2	30	100	0.013±30%	6.2	6.3	2R2
BPAS000808453R3□00	3.3	30	100	0.016±30%	4.7	6.0	3R3
BPAS000808454R7□00	4.7	30	100	0.018±30%	4.1	4.8	4R7
BPAS000808456R8□00	6.8	30	100	0.022±30%	3.1	4.1	6R8
BPAS00080845100□00	10	20,30	100	0.033±20%	3.0	3.4	100
BPAS00080845150□00	15	20,30	100	0.055±20%	2.3	2.8	150
BPAS00080845220□00	22	20,30	100	0.069±20%	1.7	2.4	220
BPAS00080845270□00	27	20,30	100	0.083±20%	1.65	2.1	330
BPAS00080845330□00	33	20,30	100	0.097±20%	1.60	1.9	330
BPAS00080845470□00	47	20,30	100	0.13±20%	1.26	1.6	470
BPAS00080845680□00	68	20,30	100	0.17±20%	1.08	1.3	680
BPAS00080845101□00	100	20,30	100	0.26±20%	0.81	1.1	101
BPAS00080845151□00	150	20,30	100	0.43±20%	0.69	0.95	151

**Note: When ordering, please specify tolerance code. Tolerance: M=±20% , T=±30%**

- Operating temperature range - 40°C ~ 125°C(Including self - temperature rise)
- Isat for Inductance drop 30% from its value without current
- I rms for a 40°C temperature rise from 25°C ambient with current
- Rated DC Current : The less value which is Isat or I rms

# SMD Shielded Power Inductors – BPAS Series

## Packaging Specifications

Tape Dimensions

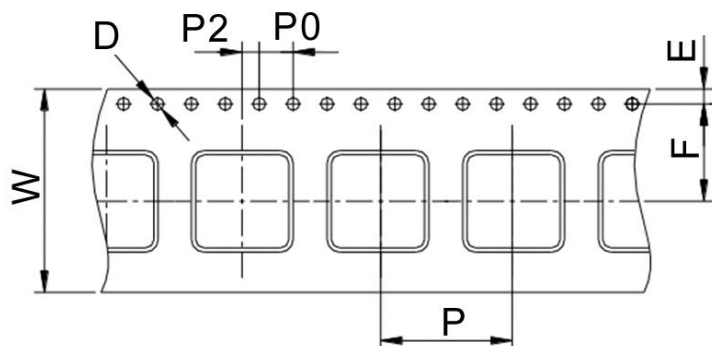

Reel Dimensions

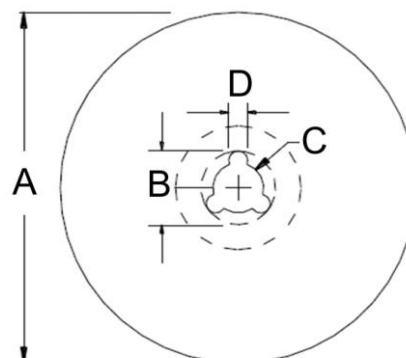

### Dimensions in mm

TYPE	Tape Dimensions							Reel Dimensions				Quantity
	W	D	E	F	P	P0	P2	A	B	C	D	PCS / Reel
BPAS00080845	16	1.5	1.75	7.5	12	4	2	330	20	13	2	1000