

SAW Filter 480 MHz

MODEL NO.: TA2479A

REV. NO.:1

A. MAXIMUM RATING:

1. Input Power Level: 10 dB_m
2. DC voltage: 3 V
3. Operating Temperature: -40°C to +85°C
4. Storage Temperature: -40°C to +85°C
5. Moisture Sensitivity Level: Level 1
6. ESD 50V(MM) 100V(HBM)

RoHS Compliant
Lead free
Lead-free soldering

Electrostatic Sensitive Device (ESD)

B. ELECTRICAL CHARACTERISTICS:

Reference temperature: 25°C

Item	Unit	Min.	Type.	Max.	
Center frequency F _c	MHz	-	480	-	
Insertion Loss IL _{min} (reference level)	dB	-	1.6	2.8	
2dB Bandwidth BW _{-2dB}	MHz	20	24.3	-	
Absolute Attenuation:(Reference level from 0dB)					
F _c -45 to F _c -100	MHz	dB	40	56	-
F _c +45 to F _c +55	MHz	dB	30	56	-
F _c +55 to F _c +100	MHz	dB	40	54	-
Temperature coefficient of frequency	ppm/k	-	-36	-	
Source impedance Z _s	Ω	-	50	-	
Load impedance Z _L	Ω	-	50	-	

Note: IL_{min} is the minimum of the pass band attenuation. The center frequency F_c is the mean value of the upper and lower frequencies at the 2dB filter attenuation level relative to the IL_{min}.

C. MEASUREMENT CIRCUIT:

HP Network analyzer

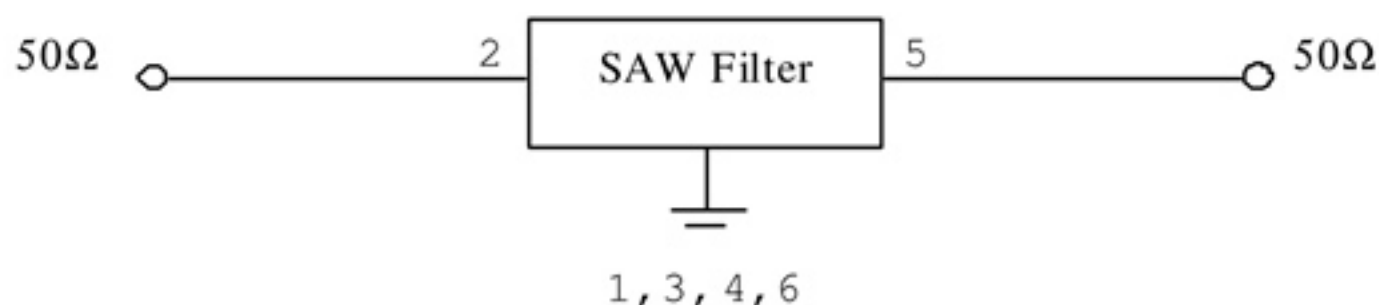

D. Frequency Characteristics :



E.OUTLINE DRAWING:

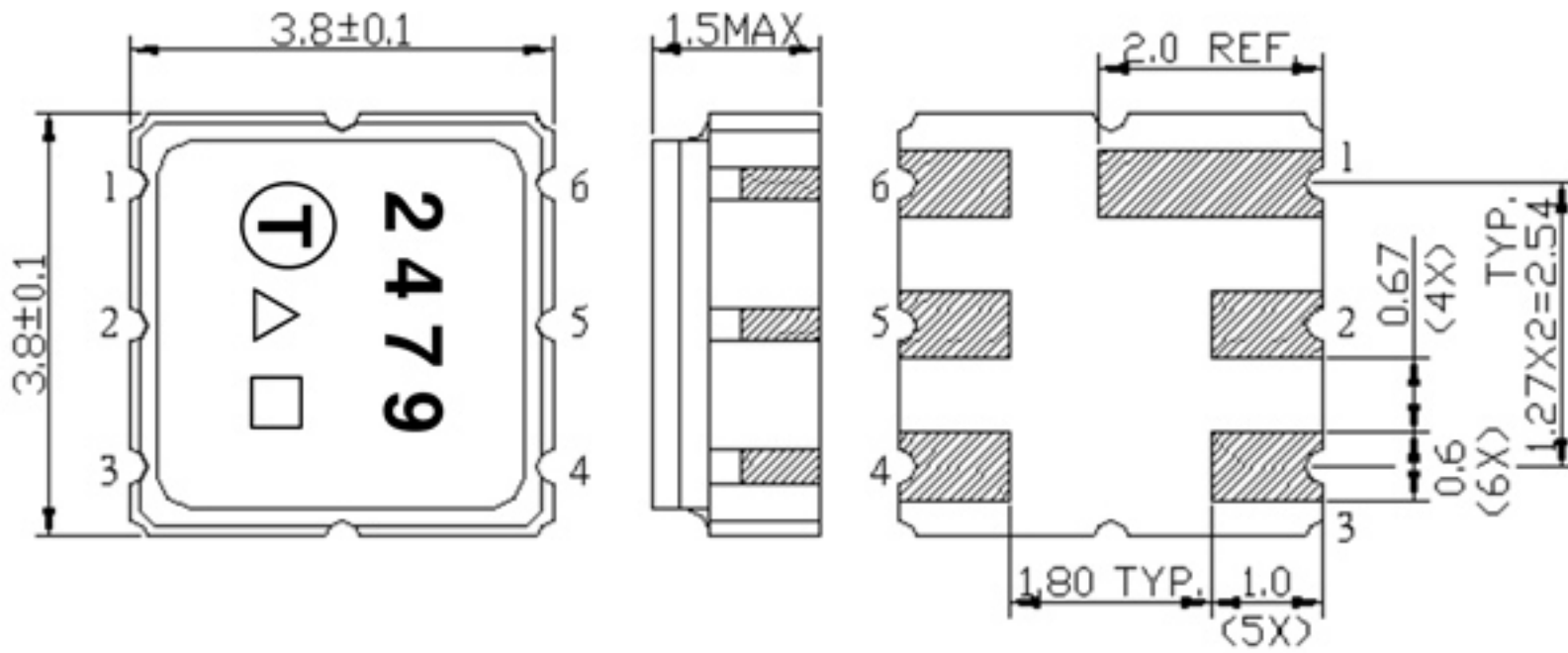

Marking name :2479

△ : Year Code

□ : Date Code (W01->A, W02->B,...W52->z)

2 : Input

5: Output

1,3,4,6: Ground

Unit: mm

Product Year Code

Year	2017 2021	2018 2022	2019 2023	2020 2024
Product Code	A	a	A	a

PCB Footprint:

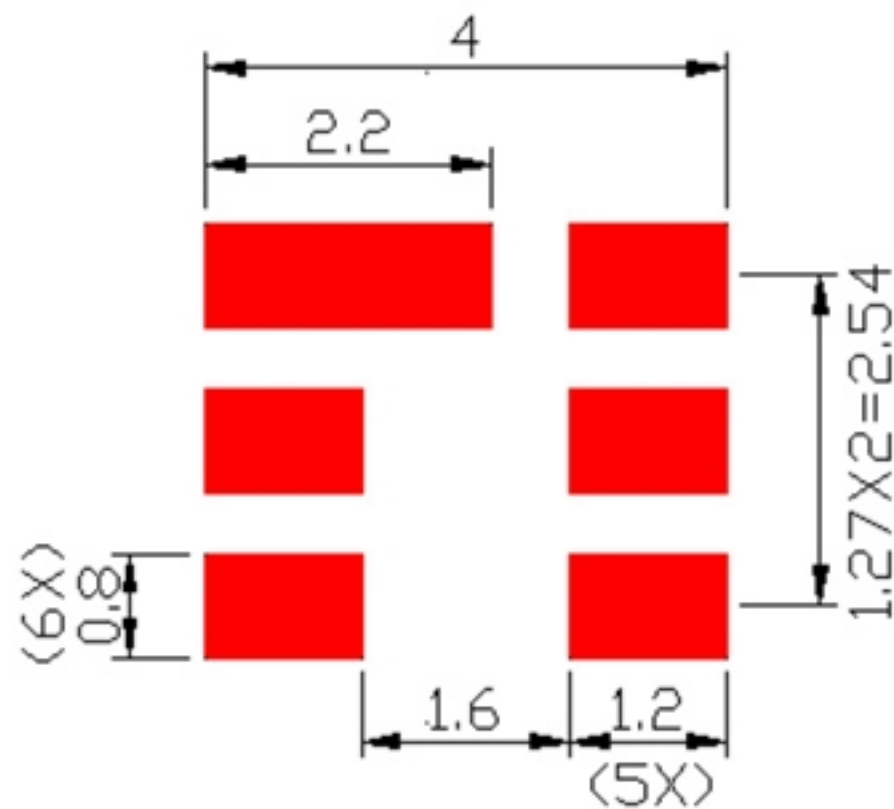

G. PACKING:

1. REEL DIMENSION

(Please refer to FR-75D10 for packing quantity)

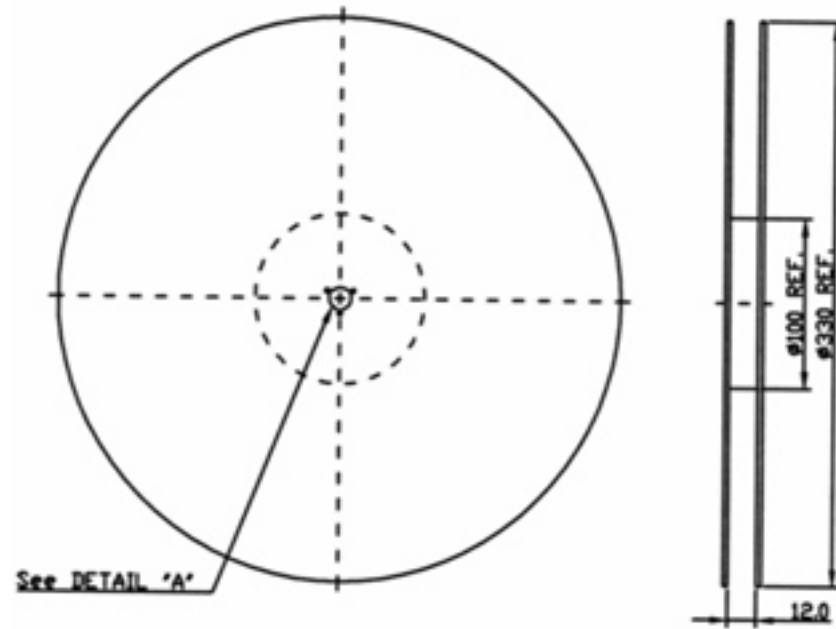

2. TAPE DIMENSION

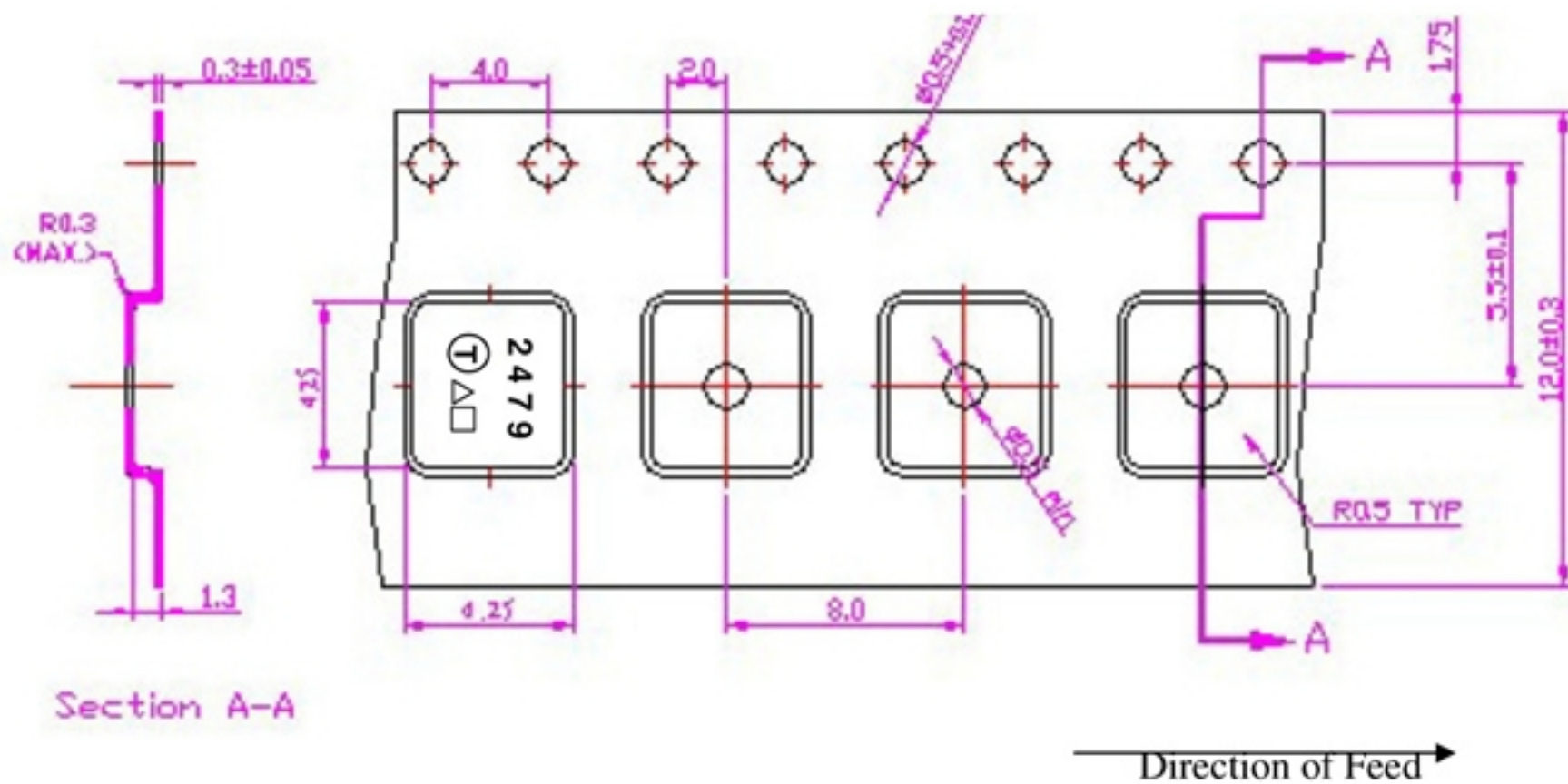

H. RECOMMENDED REFLOW PROFILE :

1. Preheating shall be fixed at 150~180°C for 60~90 seconds.
2. Ascending time to preheating temperature 150°C shall be 30 seconds min.
3. Heating shall be fixed at 220°C for 50~80 seconds and at 245~260°C peak (min. 10sec).
4. Time : 2 times.

