

# SAW Filter 619 MHz

MODEL NO.: TA2423A

REV. NO.:3

## A. MAXIMUM RATING:

1. Input Power Level: 20 dB<sub>m</sub>(CW for 70000hrs at 25 °C)
2. DC voltage: 5 V
3. Operating Temperature: -40°C to +105°C
4. Storage Temperature: -40°C to +105°C
5. Moisture Sensitivity Level: Level 1(**MSL1**)

RoHS Compliant  
Lead free  
Lead-free soldering

Electrostatic Sensitive Device (**ESD**)

## B. ELECTRICAL CHARACTERISTICS:

Item	Unit	min	type	Max	
Center Frequency Fc	MHz		619		
Insertion Loss 602~636MHz(0°C to +50°C)	dB		2.8	3.5	
Insertion Loss 602~636MHz (-40°C to +105°C)	dB		2.8	6.5	
Return Loss 602~636MHz(0°C to +50°C)	dB	12	14		
Pass band 602~636MHz	MHz	34	41		
<b>Attenuation</b> (Reference level from 0dB)					
10~410 MHz	dB	48	52		
410~520 MHz	dB	35	46		
700~980 MHz	dB	38	43		
980~1200 MHz	dB	32	39		
Temperature Coefficient of Frequency	ppm/°C	-75 typ			

## C. MEASUREMENT CIRCUIT:

HP Network analyzer

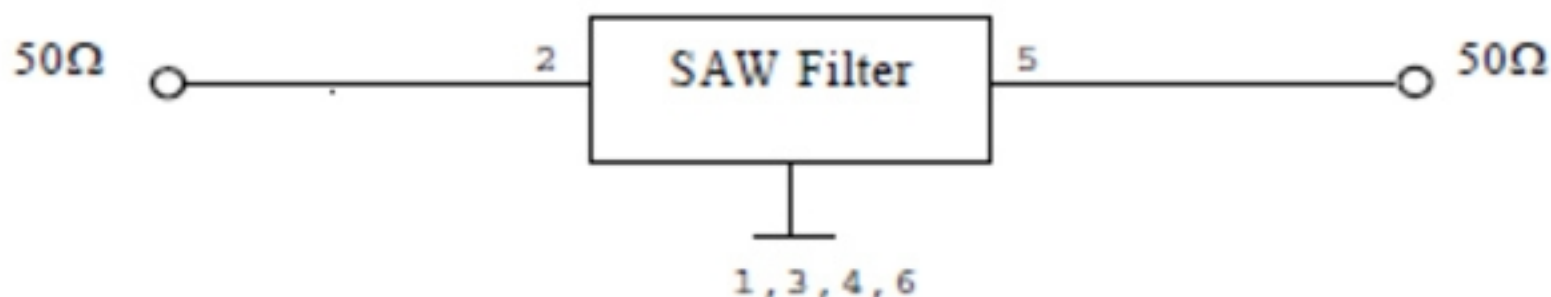

**D. OUTLINE DRAWING:**

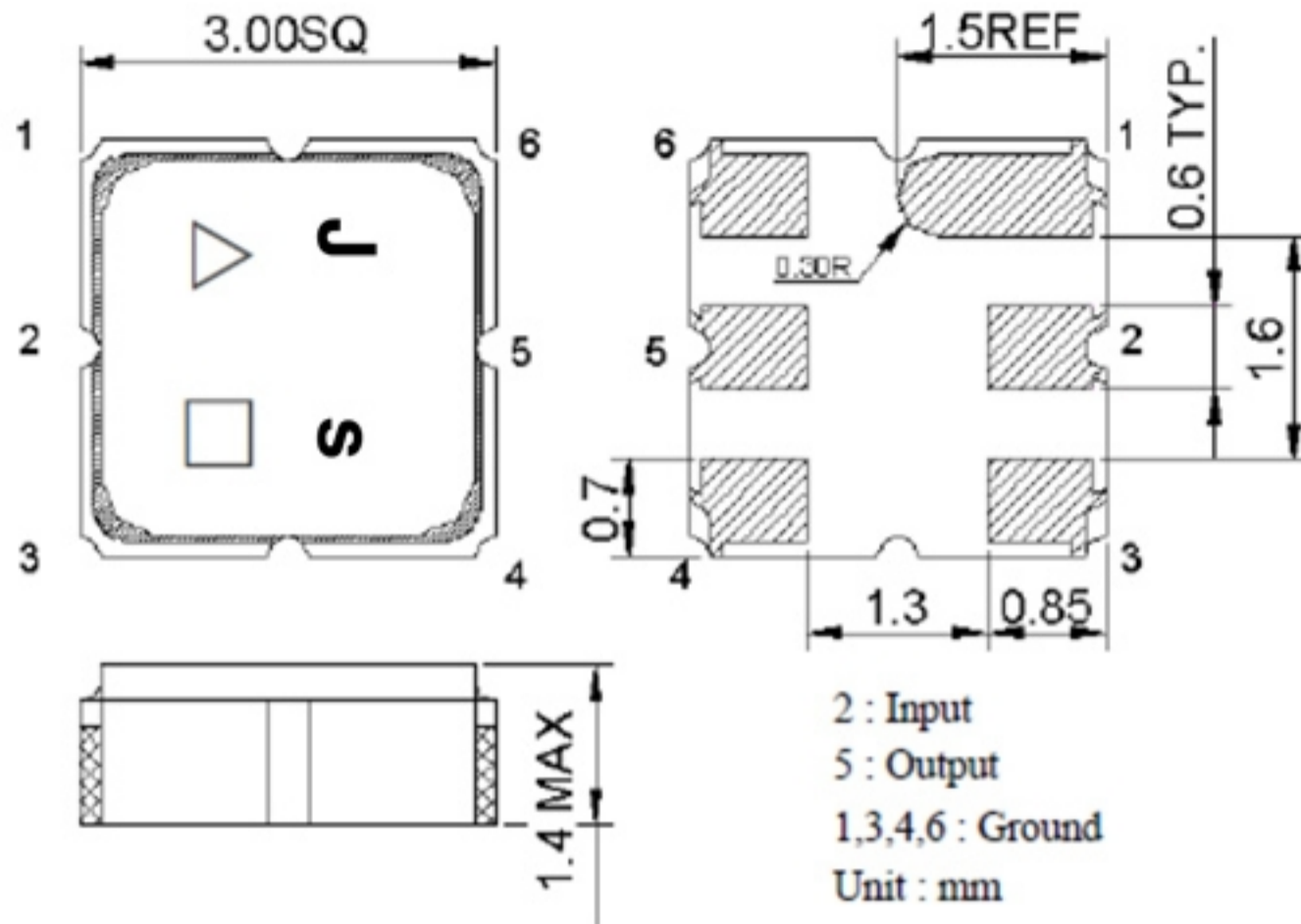

△ : Year Code (2009->9, 2010->0, ..., 2018->8)  
 □ : Date Code (Follow the table from planner each year)

Date Code Table

WK01	WK02	WK03	WK04	WK05	WK06	WK07	WK08	WK09	WK10	WK11	WK12	WK13
A	B	C	D	E	F	G	H	I	J	K	L	M
WK14	WK15	WK16	WK17	WK18	WK19	WK20	WK21	WK22	WK23	WK24	WK25	WK26
N	O	P	Q	R	S	T	U	V	W	X	Y	Z
WK27	WK28	WK29	WK30	WK31	WK32	WK33	WK34	WK35	WK36	WK37	WK38	WK39
a	b	c	d	e	f	g	h	i	j	k	l	m
WK40	WK41	WK42	WK43	WK44	WK45	WK46	WK47	WK48	WK49	WK50	WK51	WK52
n	o	p	q	r	s	t	u	v	w	x	y	z

**E. PCB Footprint:**

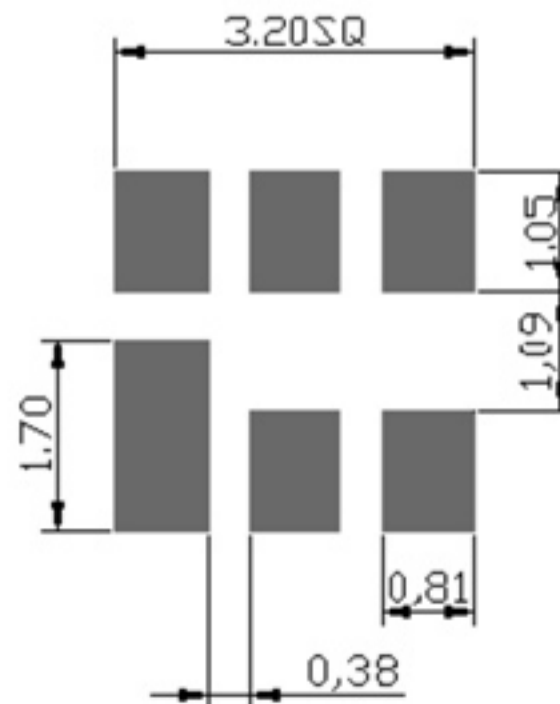

## F. Frequency Characteristics:

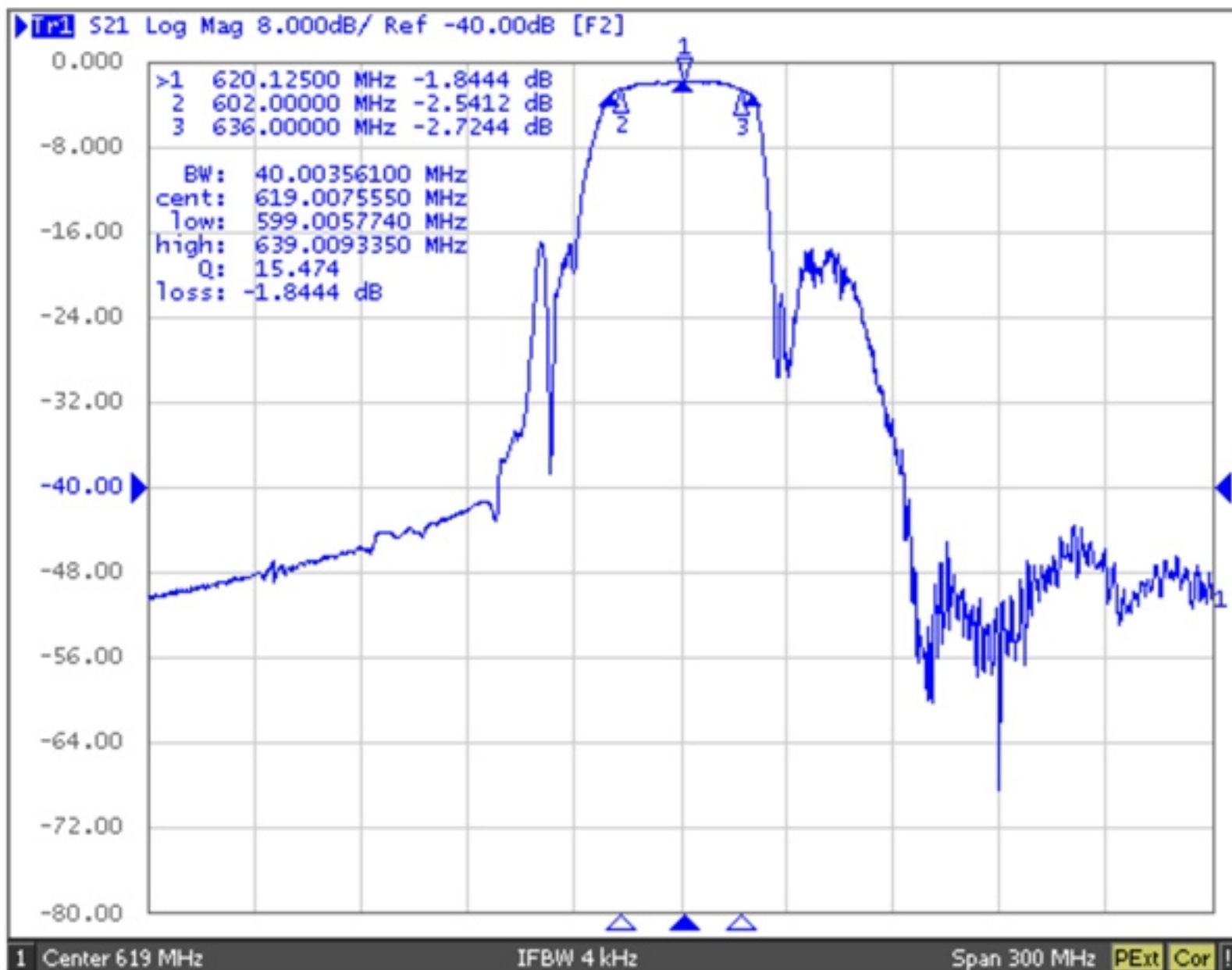
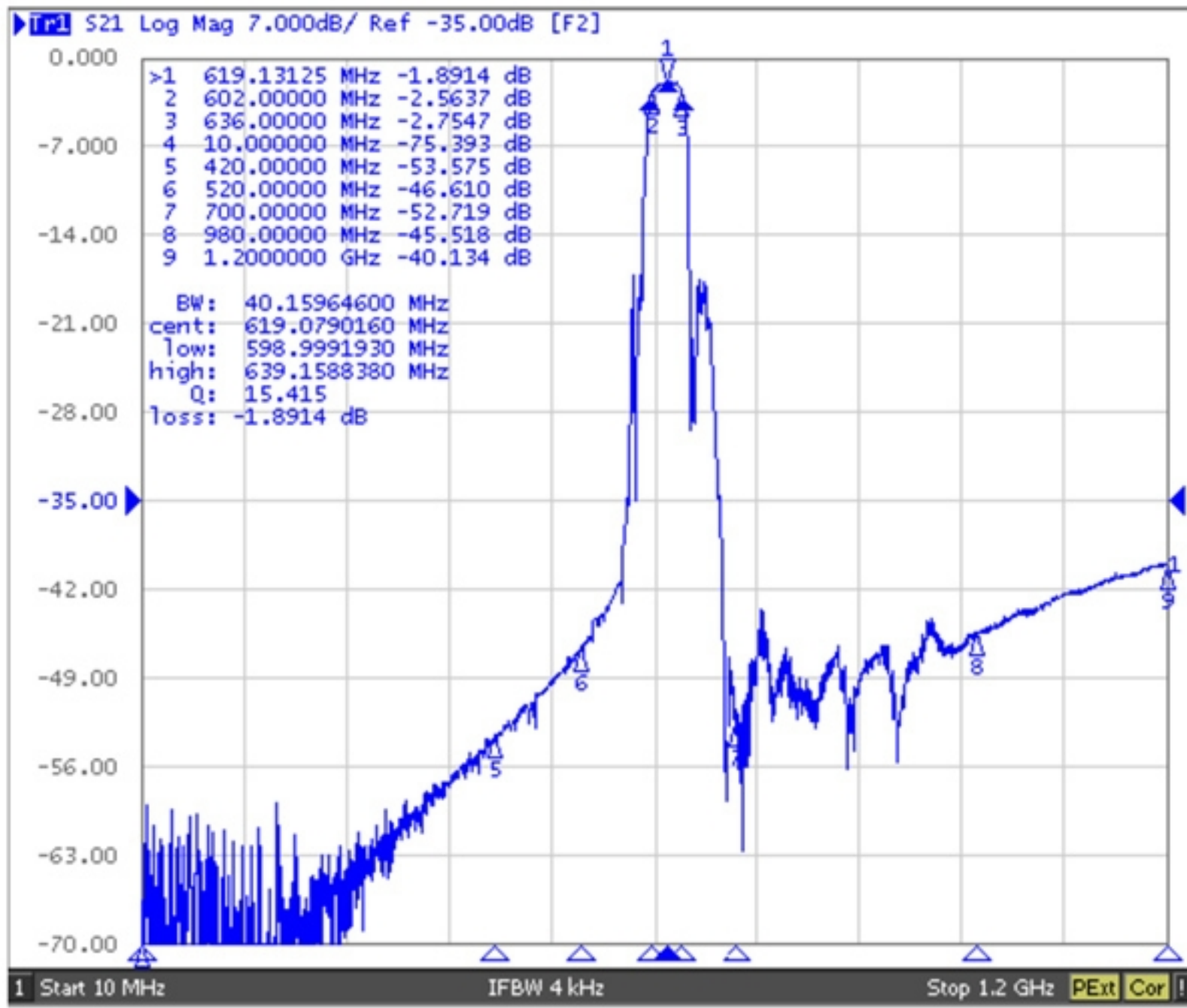

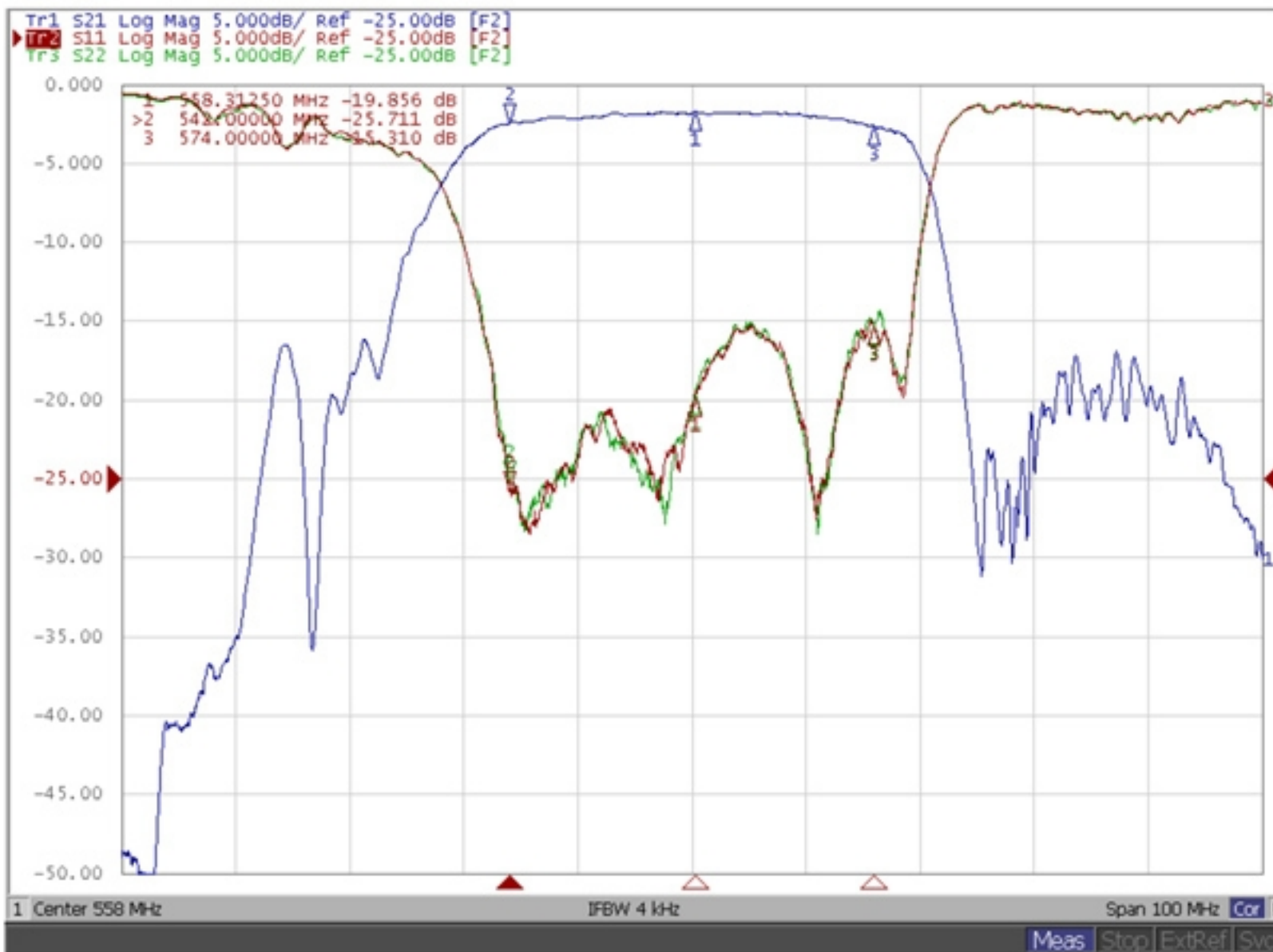
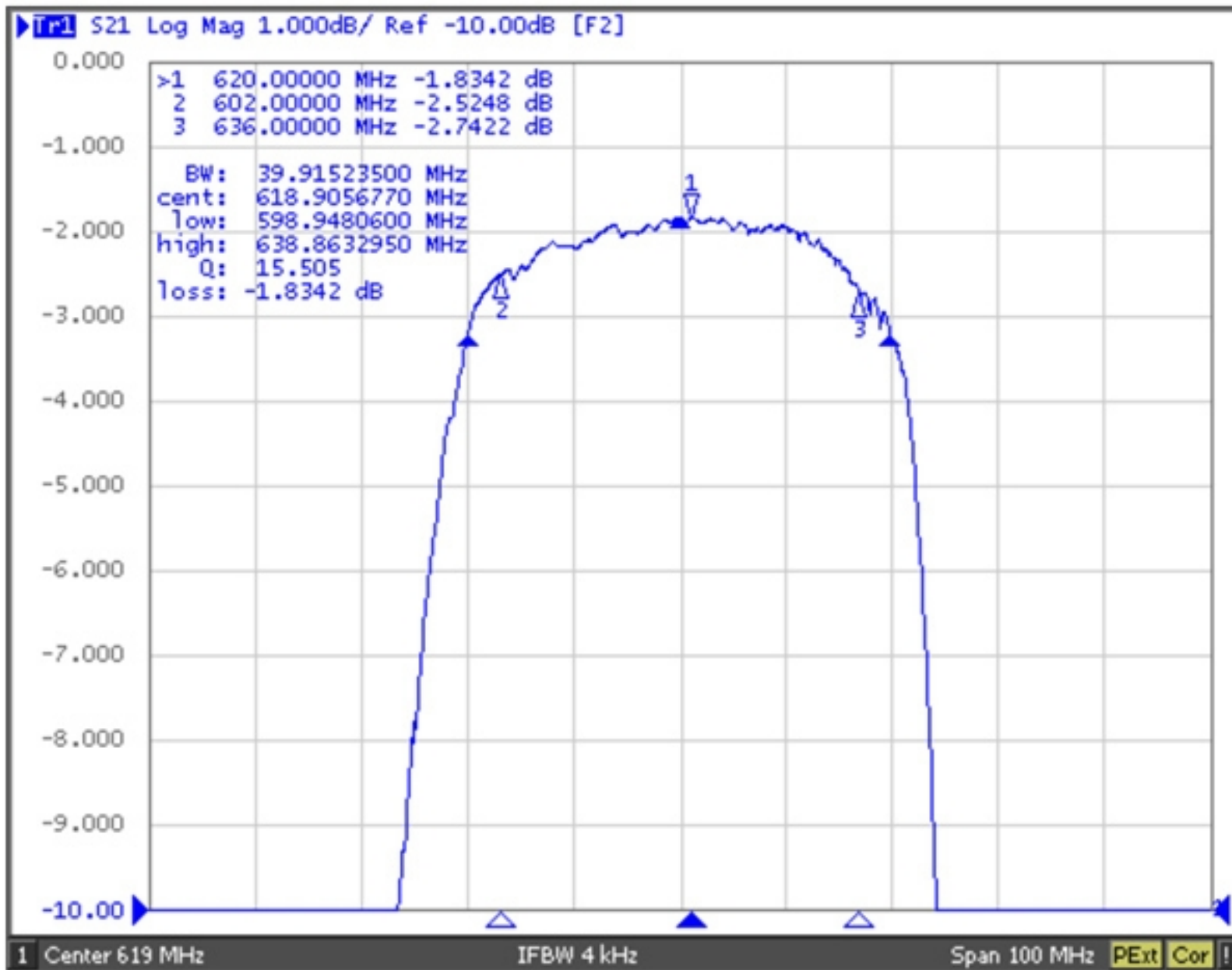

## G. PACKING: (Ref. WI-75M03)

### 1. REEL DIMENSION

(Please refer to FR-75D10 for packing quantity)

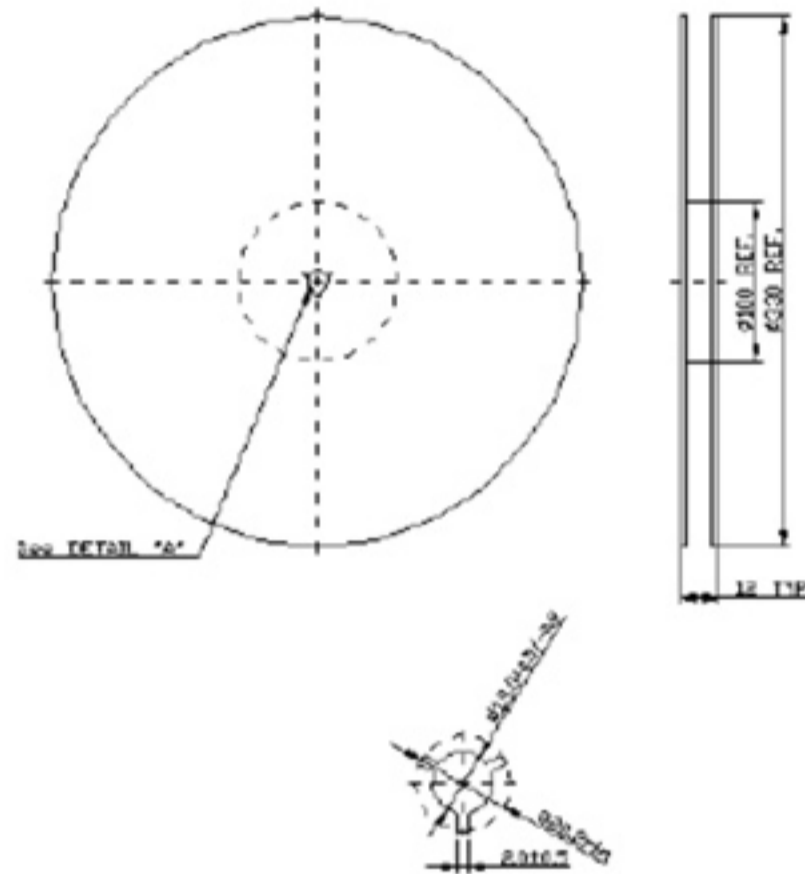

### 2. TAPE DIMENSION

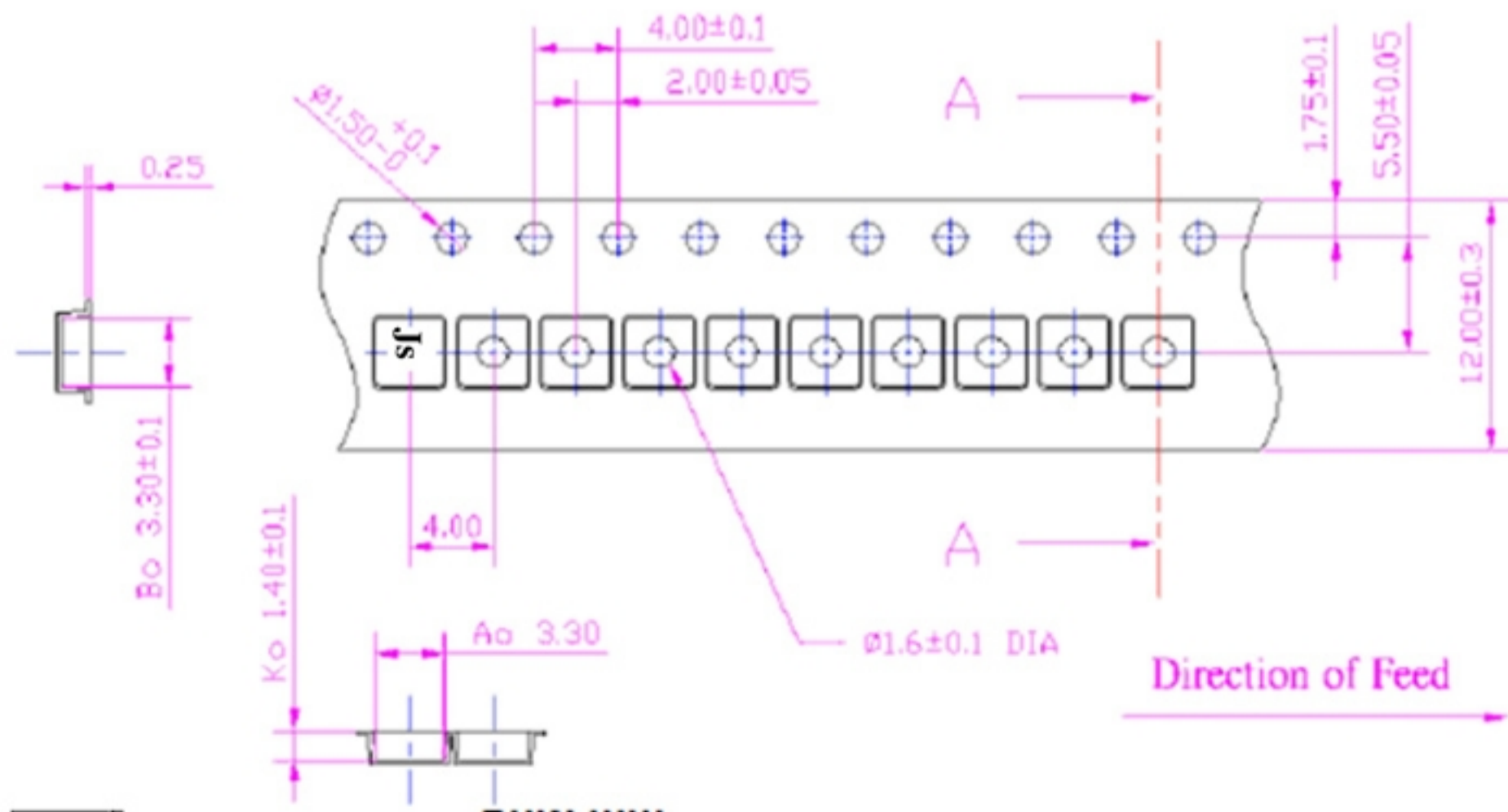

## H. Recommended Reflow Profile:

1. Preheating shall be fixed at 150~180°C for 60~90 seconds.
2. Ascending time to preheating temperature 150°C shall be 30 seconds min.
3. Heating shall be fixed at 220°C for 50~80 seconds and at 260°C +0/-5°C peak (20~40sec).
4. Time: 2 times.

