

SAW Filter 433.92 MHz

MODEL NO.: TA2492A

REV. NO.:1

A. MAXIMUM RATING:

1. Input Power Level: 10 dB_m
2. DC voltage: 3 V
3. Operating Temperature: -40°C to 85°C
4. Storage Temperature: -40°C to +85° C
5. Moisture Sensitivity Level: Level 1(**MSL1**)

RoHS Compliant
Lead free
Lead-free soldering

Electrostatic Sensitive Device (ESD)

B. CHARACTERISTICS:

Item	Unit	Min.	Typical	Max.
Center frequency F_c	MHz	-	433.92	-
Insertion loss (433.05 ~ 434.79 MHz) IL	dB	-	1.6	3.0
Amplitude ripple (433.05 ~ 434.79 MHz)	dB	-	0.2	1.4
VSWR (433.05 ~ 434.79 MHz)	-	-	1.3	2.2
Attenuation (Reference level from 0 dB)				
10.0 ~ 380.00 MHz	dB	58	65	-
380.00 ~ 423.42 MHz	dB	46	53	-
443.42 ~ 453.42 MHz	dB	25	32	-
453.42 ~ 460.00 MHz	dB	35	45	-
460.00 ~ 700.00 MHz	dB	50	59	-
700.00 ~ 1000.00 MHz	dB	42	61	-
Source impedance Z_s	Ω	-	50	-
Load impedance Z_L	Ω	-	50	-

Note. No matching network required for operation at 50Ω

C. MEASUREMENT CIRCUIT:

HP Network analyzer

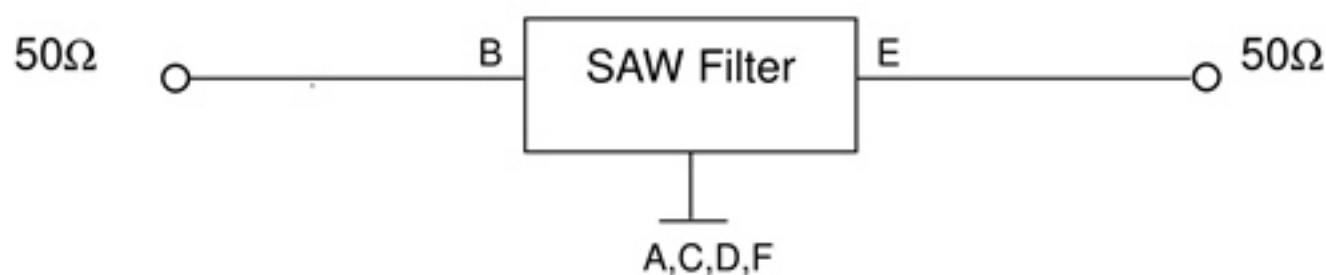

D. OUTLINE DRAWING:

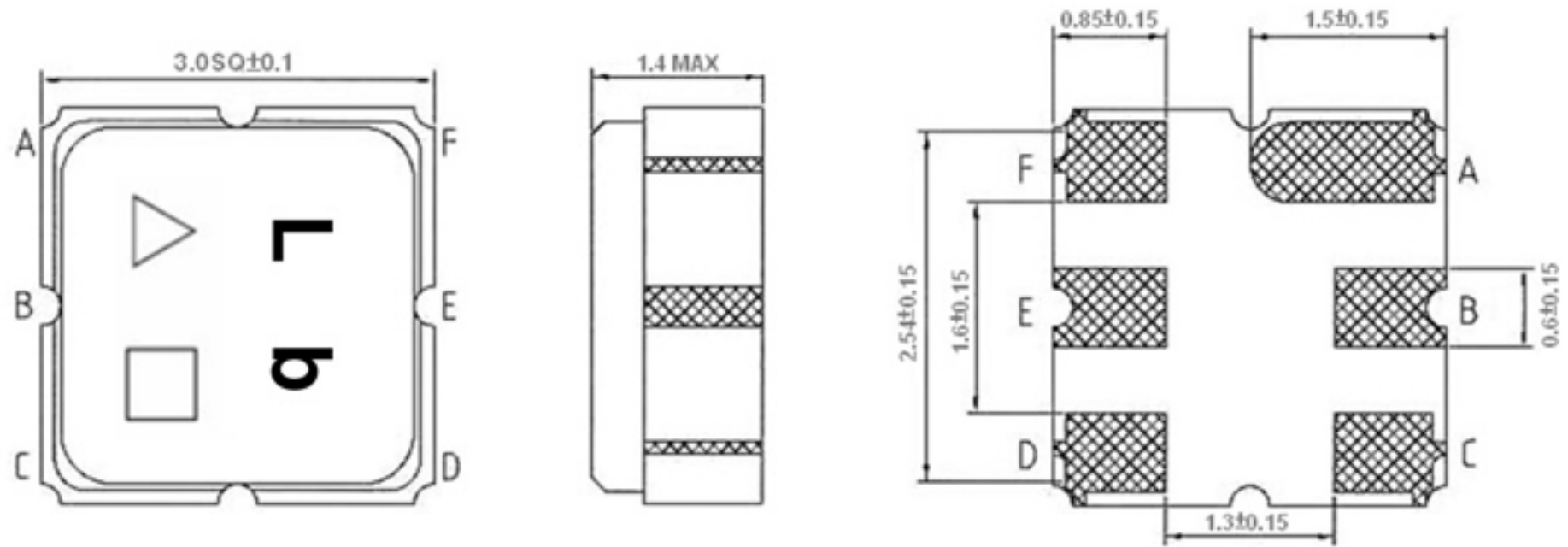

B: Input

E: Output

A, C, D, F: Ground

Unit: mm

△ : Year Code (2011->1, 2012->2, ..., 2019->9, 2020->0)

□ : Date Code

Date Code Table:

WK01	WK02	WK03	WK04	WK05	WK06	WK07	WK08	WK09	WK10	WK11	WK12	WK13
A	B	C	D	E	F	G	H	I	J	K	L	M
WK14	WK15	WK16	WK17	WK18	WK19	WK20	WK21	WK22	WK23	WK24	WK25	WK26
N	O	P	Q	R	S	T	U	V	W	X	Y	Z
WK27	WK28	WK29	WK30	WK31	WK32	WK33	WK34	WK35	WK36	WK37	WK38	WK39
a	b	c	d	e	f	g	h	i	j	k	l	m
WK40	WK41	WK42	WK43	WK44	WK45	WK46	WK47	WK48	WK49	WK50	WK51	WK52
n	o	p	q	r	s	t	u	v	w	x	y	z

E. PCB Footprint:

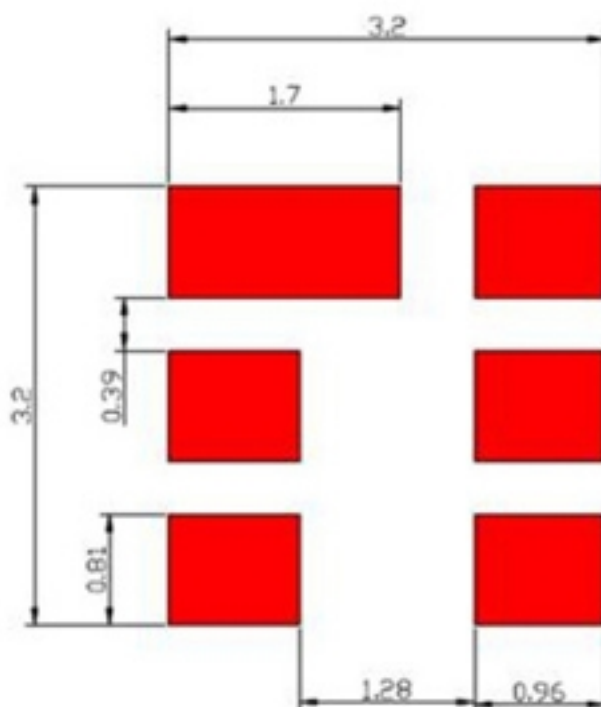

F. Frequency Characteristics:

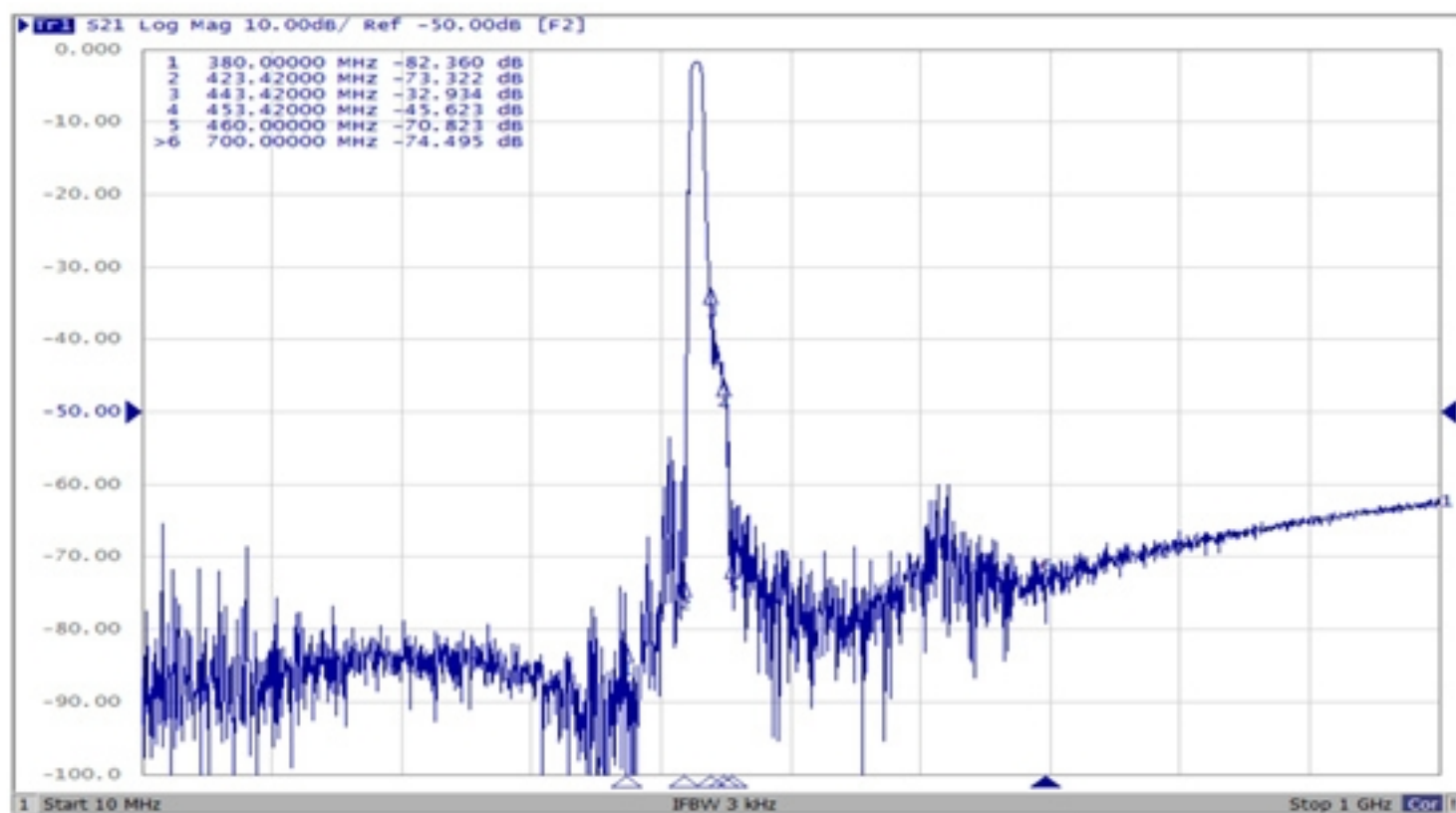
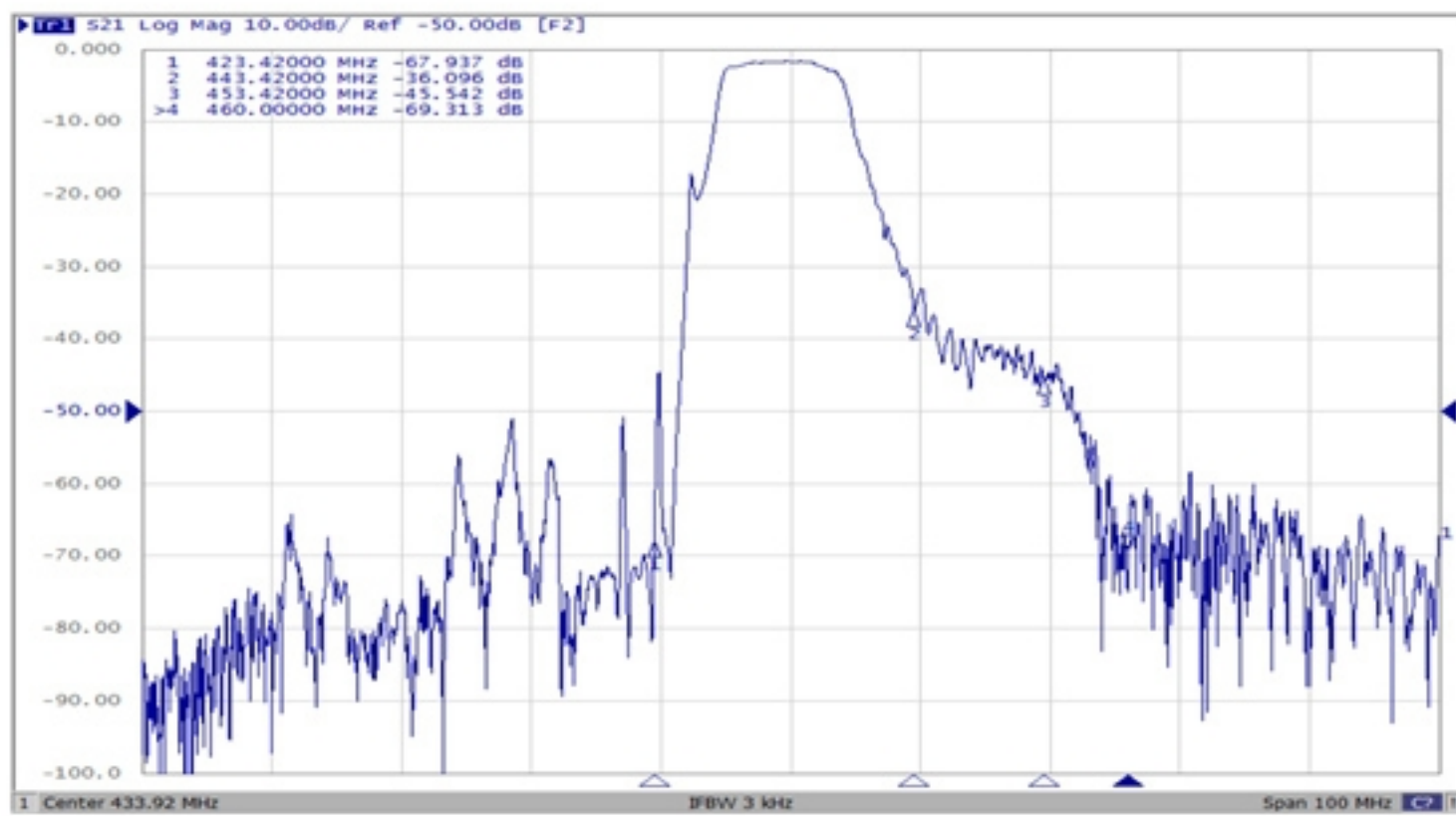
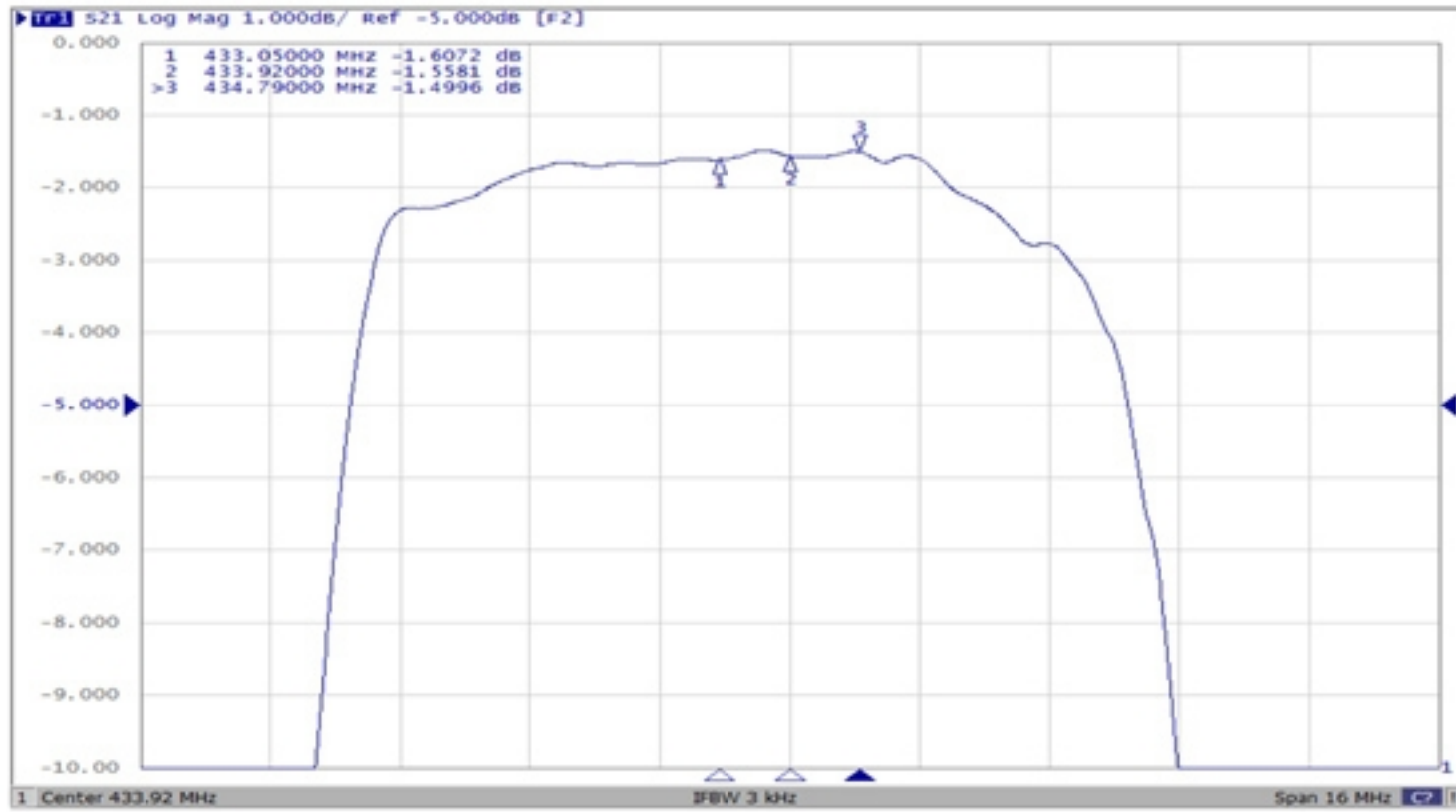

Reflection Functions:

S11

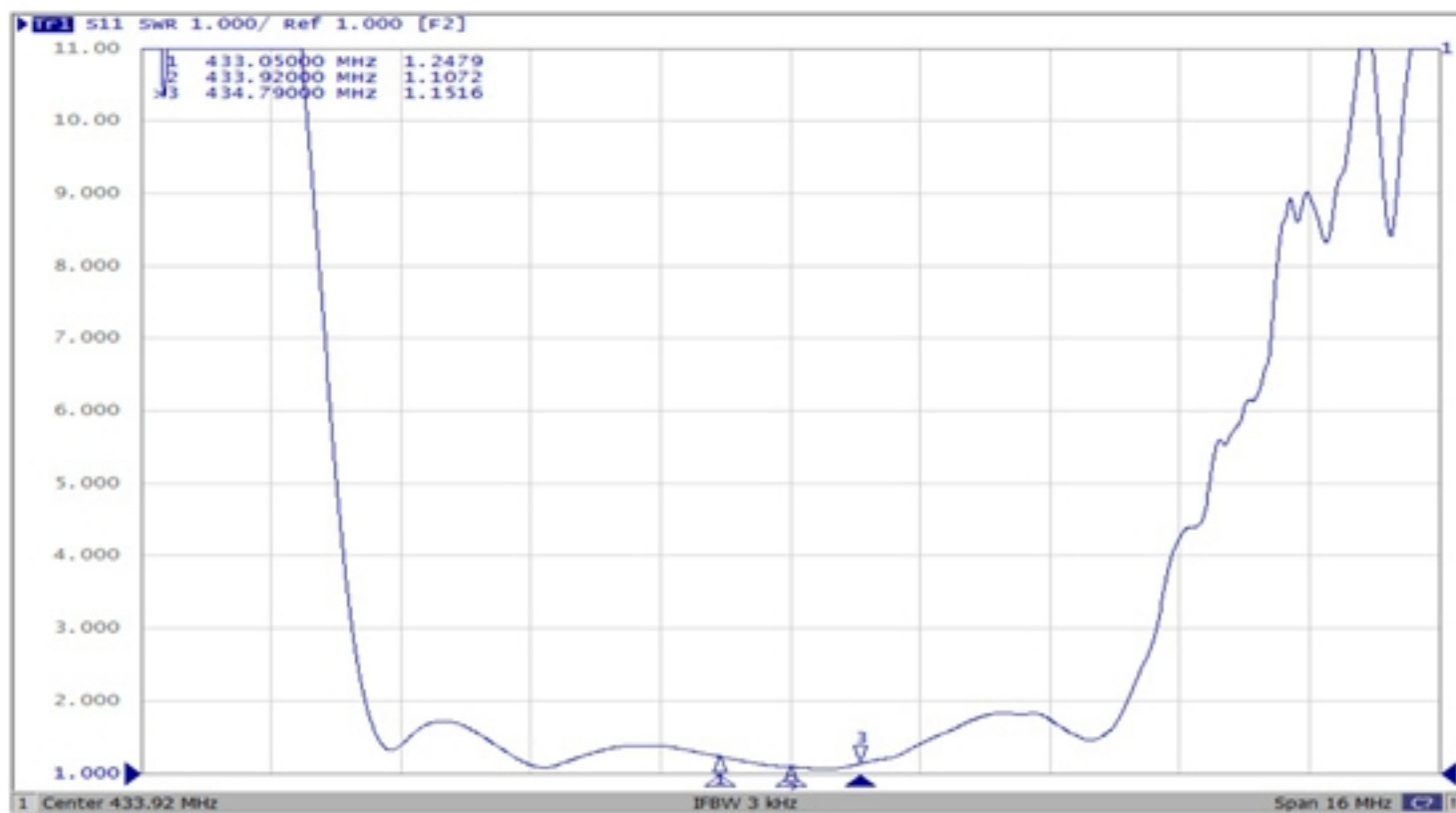

S22

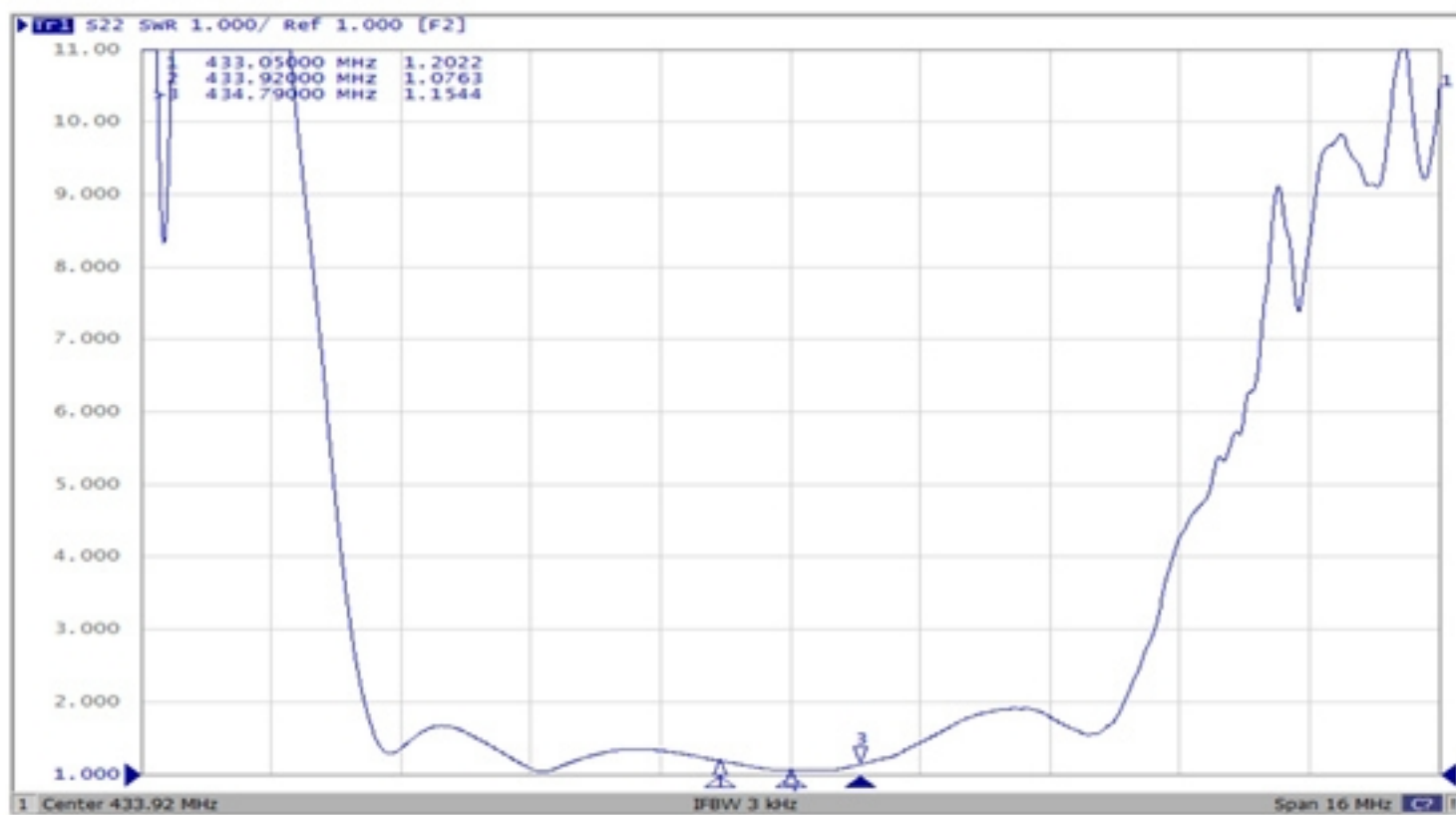

G. PACKING: (Ref. WI-75M03)

1. REEL DIMENSION

(Please refer to FR-75D10 for packing quantity)

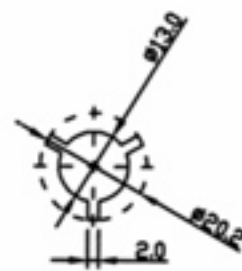
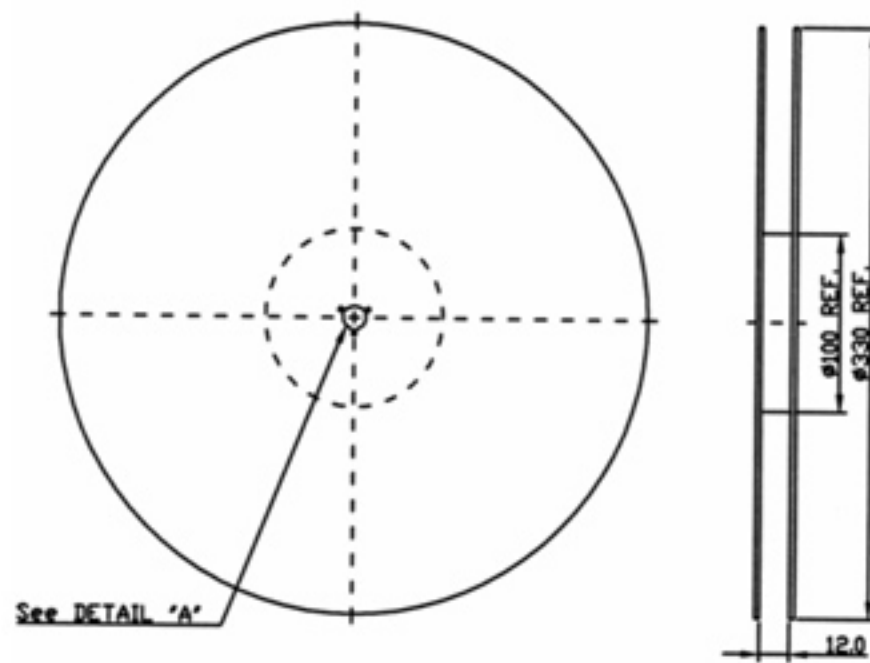

2. TAPE DIMENSION

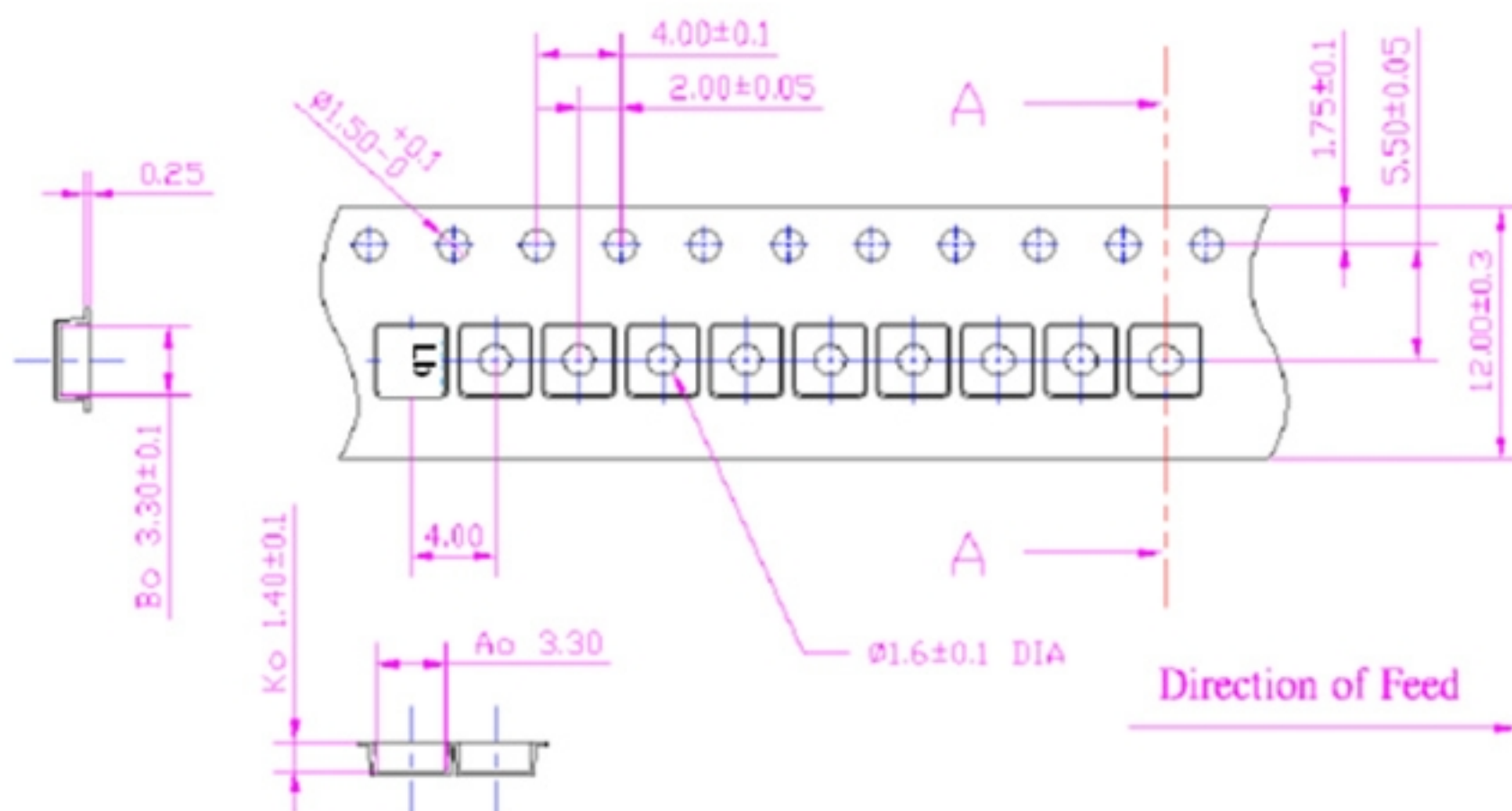

H. Recommended Reflow Profile:

1. Preheating shall be fixed at $150\sim 180^{\circ}\text{C}$ for 60~90 seconds.
2. Ascending time to preheating temperature 150°C shall be 30 seconds min.
3. Heating shall be fixed at 220°C for 50~80 seconds and at $260^{\circ}\text{C} +0/-5^{\circ}\text{C}$ peak (20~40sec).
4. Time: 2 times.

