

SAW Filter 836.5 MHz 25MHz BW SMD 1.1×0.9 mm

MODEL NO.: TA1692D

REV. No.: 2.0

A. MAXIMUM RATING:

1. Maximum Input Power: 13 dBm
2. DC voltage: 0 V
3. Operating Temperature: -30°C to +85°C
4. Storage Temperature: -40°C to +100°C
5. ESD: 100V(MM) 200V(HBM)
6. Moisture Sensitive Level: Level 3 (MSL3)

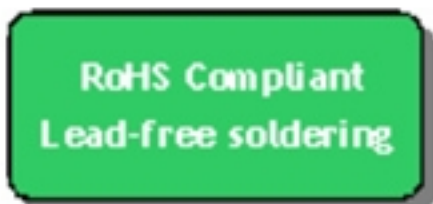

Electrostatic Sensitive Device (ESD)

B. ELECTRICAL CHARACTERISTICS:

Source Impedance (single ended): 50Ω

Load Impedance (single ended): 50Ω

Parameters Description	Unit	Minimum	Typical	Maximum
Center Frequency (Fo)	MHz	-	836.5	-
Insertion Loss (824 ~ 849 MHz)	dB	-	1.9	2.3
Amplitude Ripple within (824 ~ 849 MHz)	dB _{p-p}	-	0.8	1.3
VSWR (824 ~ 849 MHz)	-	-	2.0	2.3
Attenuation:				
<i>DC ~ 750 MHz</i>	dB	35	41	-
<i>750 ~ 800 MHz</i>	dB	28	35	-
<i>869 ~ 894 MHz</i>	dB	40	45	-
<i>894 ~ 1050 MHz</i>	dB	38	43	-
<i>1050 ~ 1210 MHz</i>	dB	35	41	-
<i>1210 ~ 1580 MHz</i>	dB	30	36	-
<i>1580 ~ 2000 MHz</i>	dB	28	32	-
<i>2000 ~ 3000 MHz</i>	dB	23	27	-
<i>3000 ~ 6000 MHz</i>	dB	12	18	-

C. Frequency Characteristics :

S21dB Span 300 MHz



S21dB Span 6000 MHz

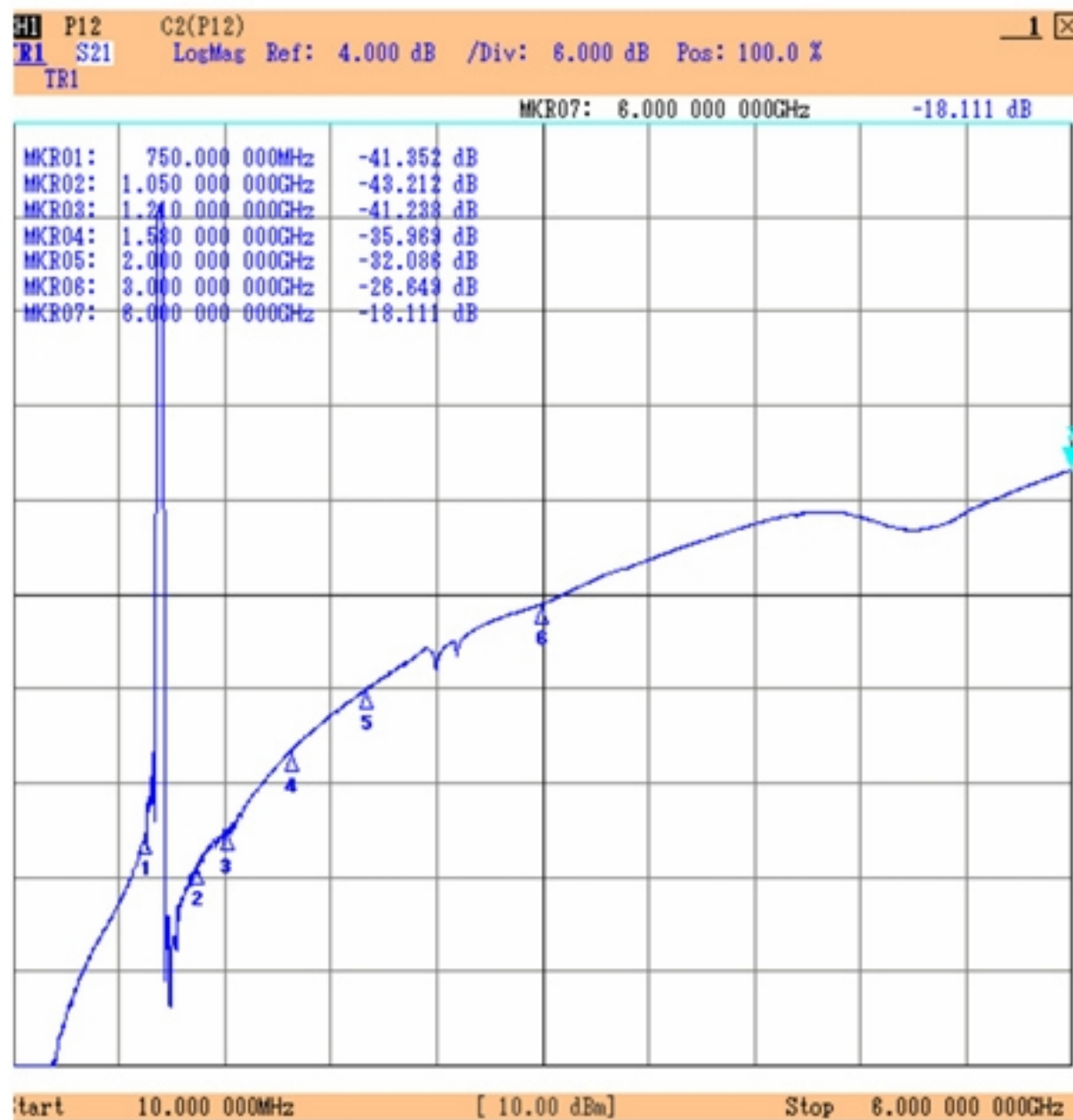

Ripple Span 50 MHz

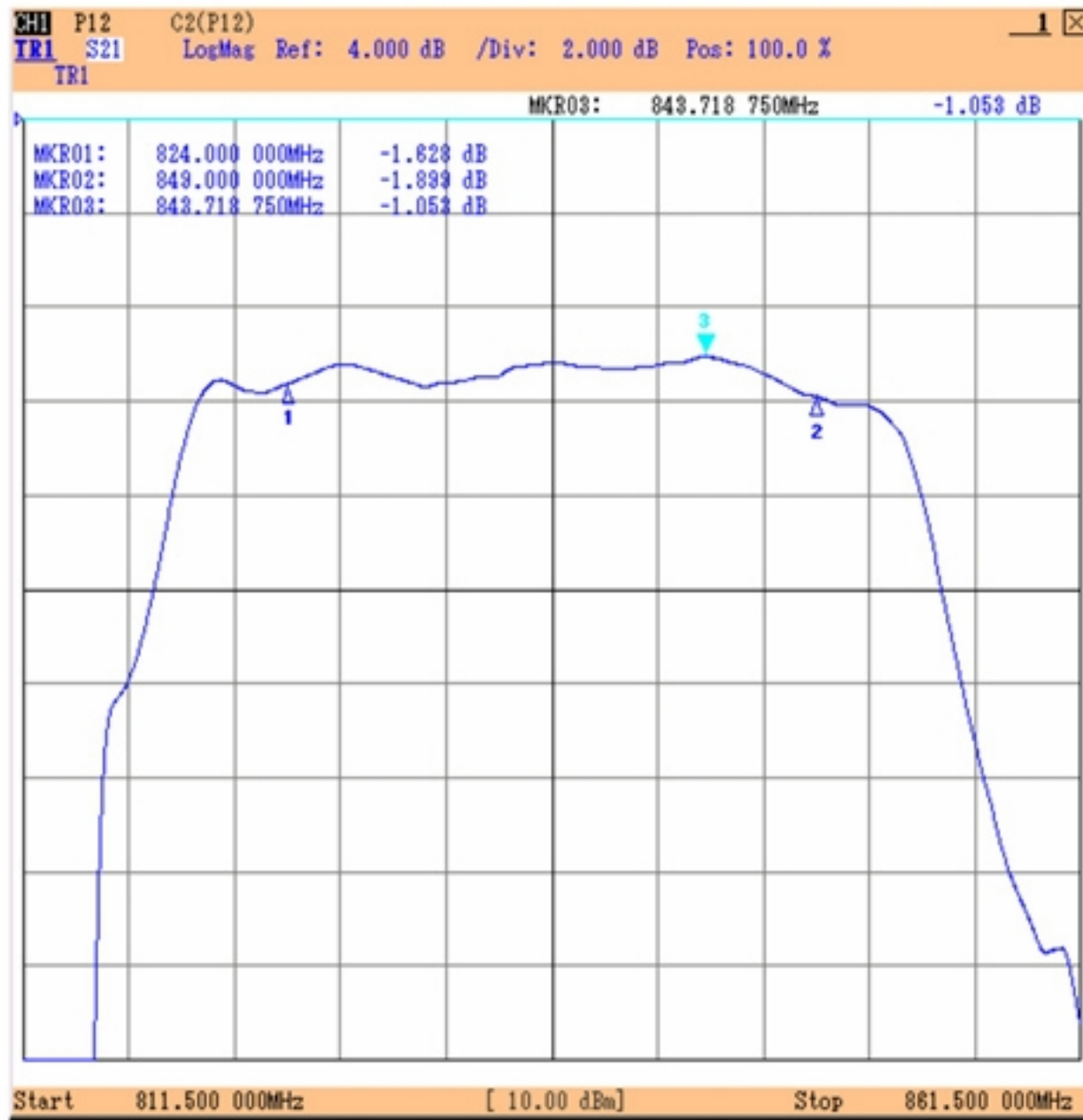

Reflective Function

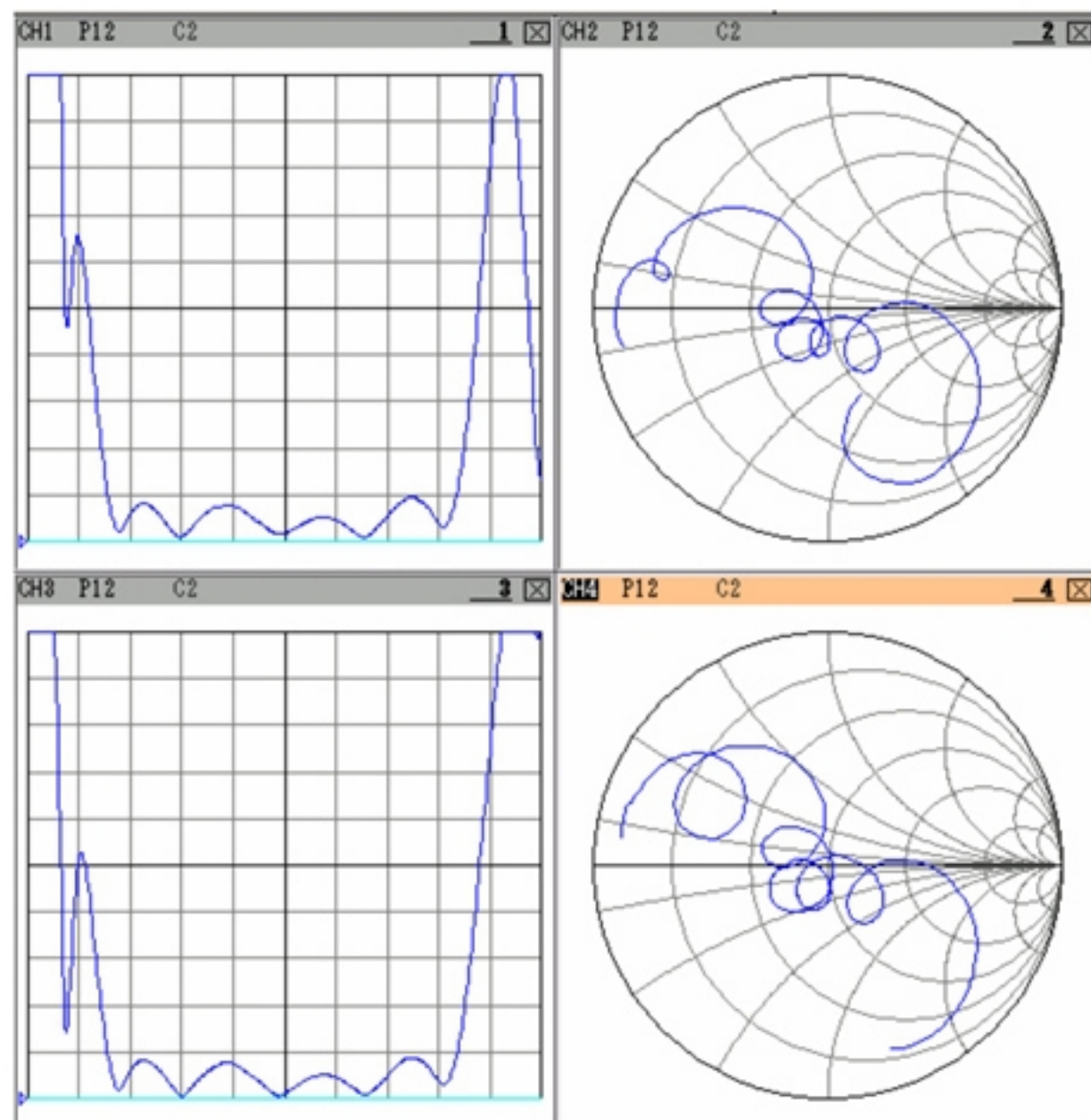

D. MEASUREMENT CIRCUIT:

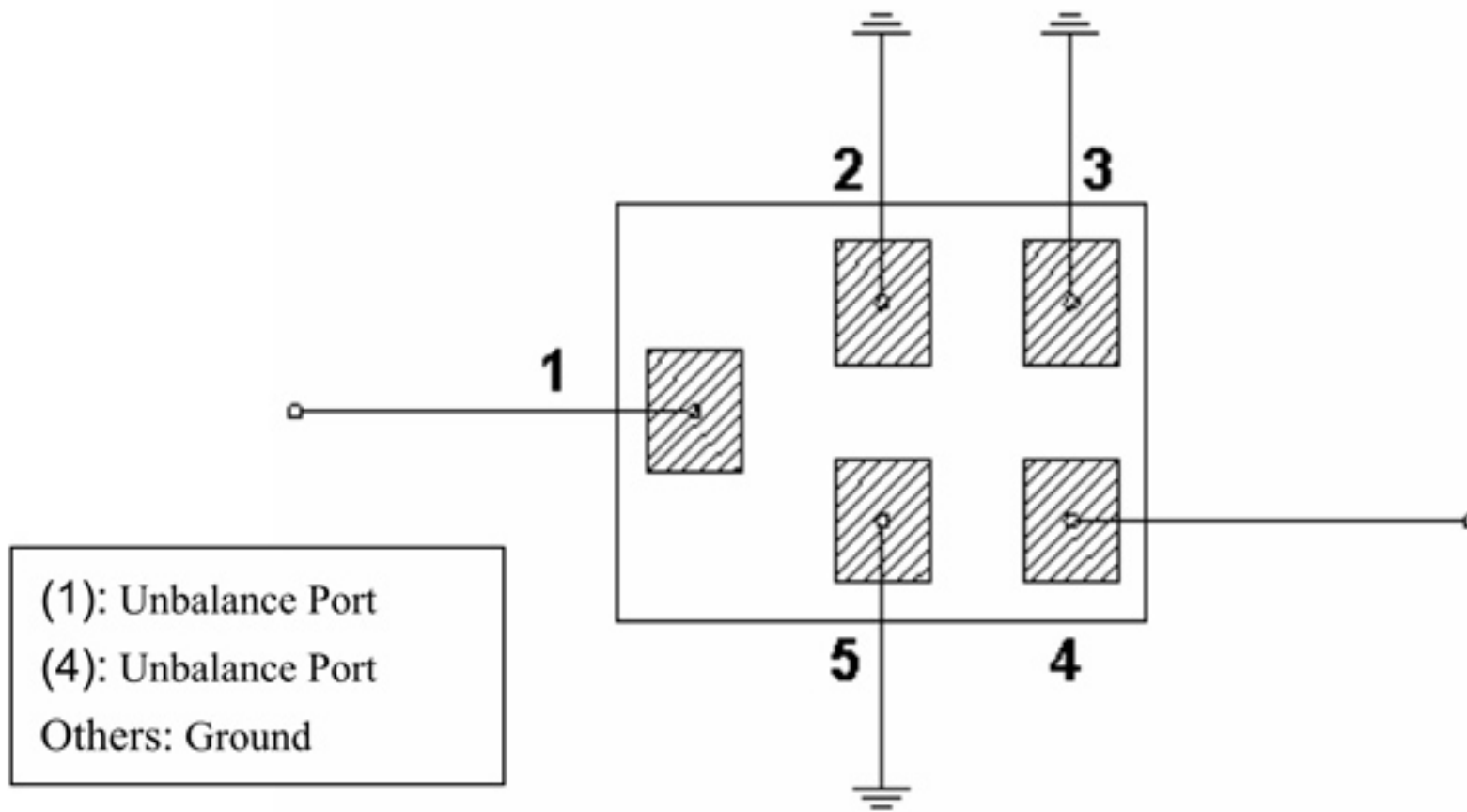

E. OUTLINE DRAWING:

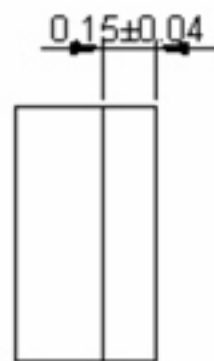
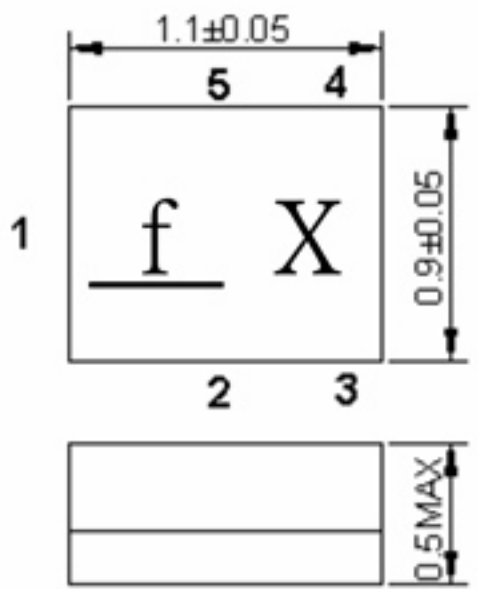

All tolerances are +/-0.05 mm unless otherwise specified

Coplanarity : 0.1 mm max.

1 to 5 : Pin No.

Unit : mm

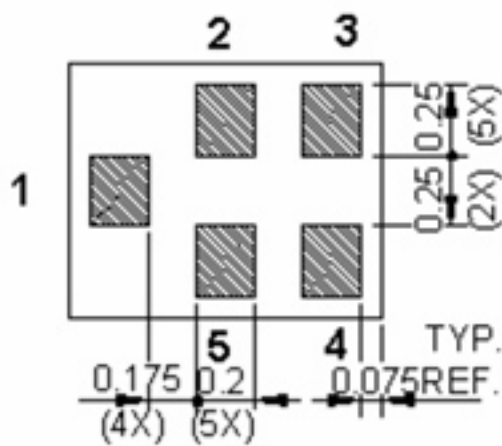

Pin No.	Symbol	Function
1	IN	Input
2	GND	Ground
3	GND	Ground
4	OUT	Output
5	GND	Ground

X : Year/Month Code (Follow the table)

YEAR/Month	1	2	3	4	5	6	7	8	9	10	11	12
2013	A	B	C	D	E	F	G	H	J	K	L	M
2014	N	P	Q	R	S	T	U	V	W	X	Y	Z
2015	a	b	c	d	e	f	g	h	j	k	l	m
2016	n	p	q	r	s	t	u	v	w	x	y	z
2017	<u>A</u>	<u>B</u>	<u>C</u>	<u>D</u>	<u>E</u>	<u>F</u>	<u>G</u>	<u>H</u>	<u>J</u>	<u>K</u>	<u>L</u>	<u>M</u>
2018	<u>N</u>	<u>P</u>	<u>Q</u>	<u>R</u>	<u>S</u>	<u>T</u>	<u>U</u>	<u>V</u>	<u>W</u>	<u>X</u>	<u>Y</u>	<u>Z</u>
2019	<u>a</u>	<u>b</u>	<u>c</u>	<u>d</u>	<u>e</u>	<u>f</u>	<u>g</u>	<u>h</u>	<u>i</u>	<u>k</u>	<u>l</u>	<u>m</u>
2020	<u>n</u>	<u>p</u>	<u>q</u>	<u>r</u>	<u>s</u>	<u>t</u>	<u>u</u>	<u>v</u>	<u>w</u>	<u>x</u>	<u>y</u>	<u>z</u>

F. PACKING:

1. REEL DIMENSION

(Please refer to FR-75D10 for packing quantity)

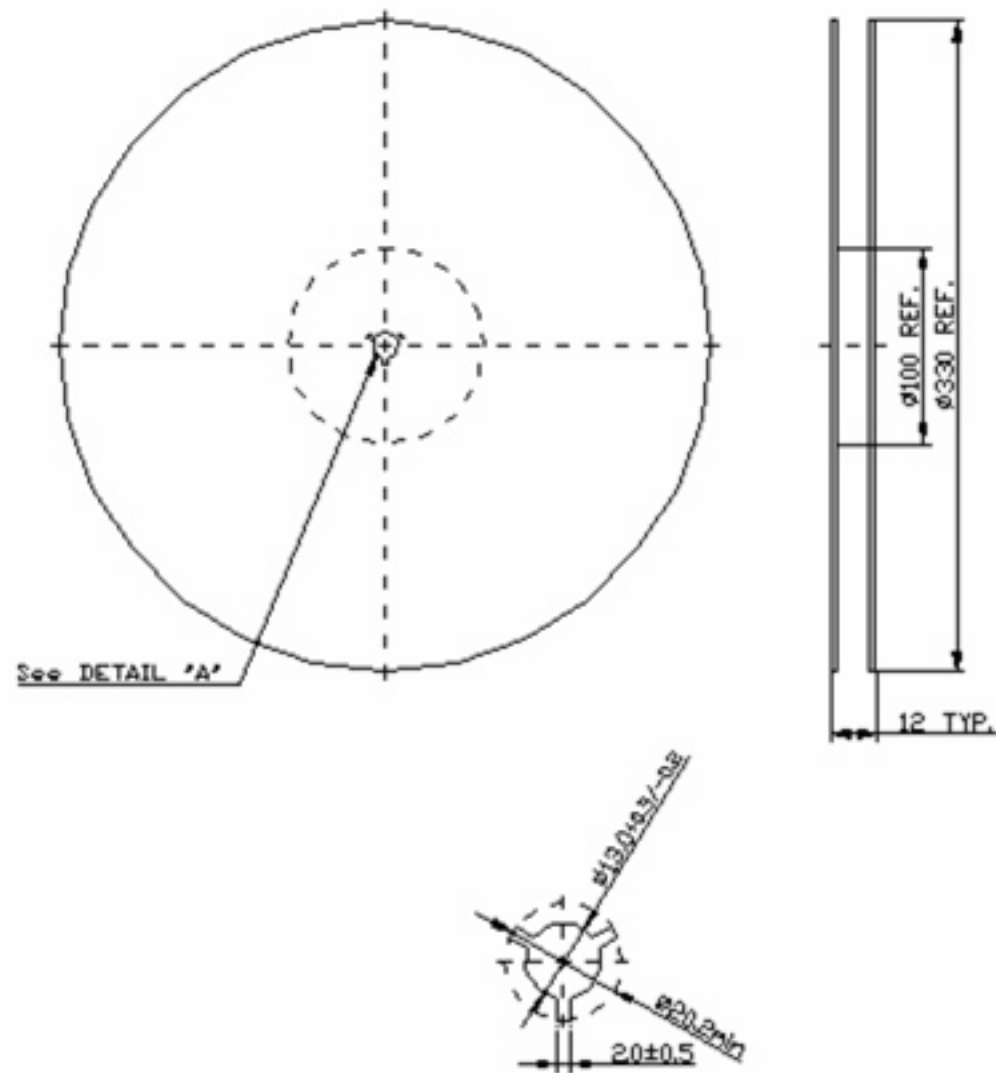

2. TAPE DIMENSION

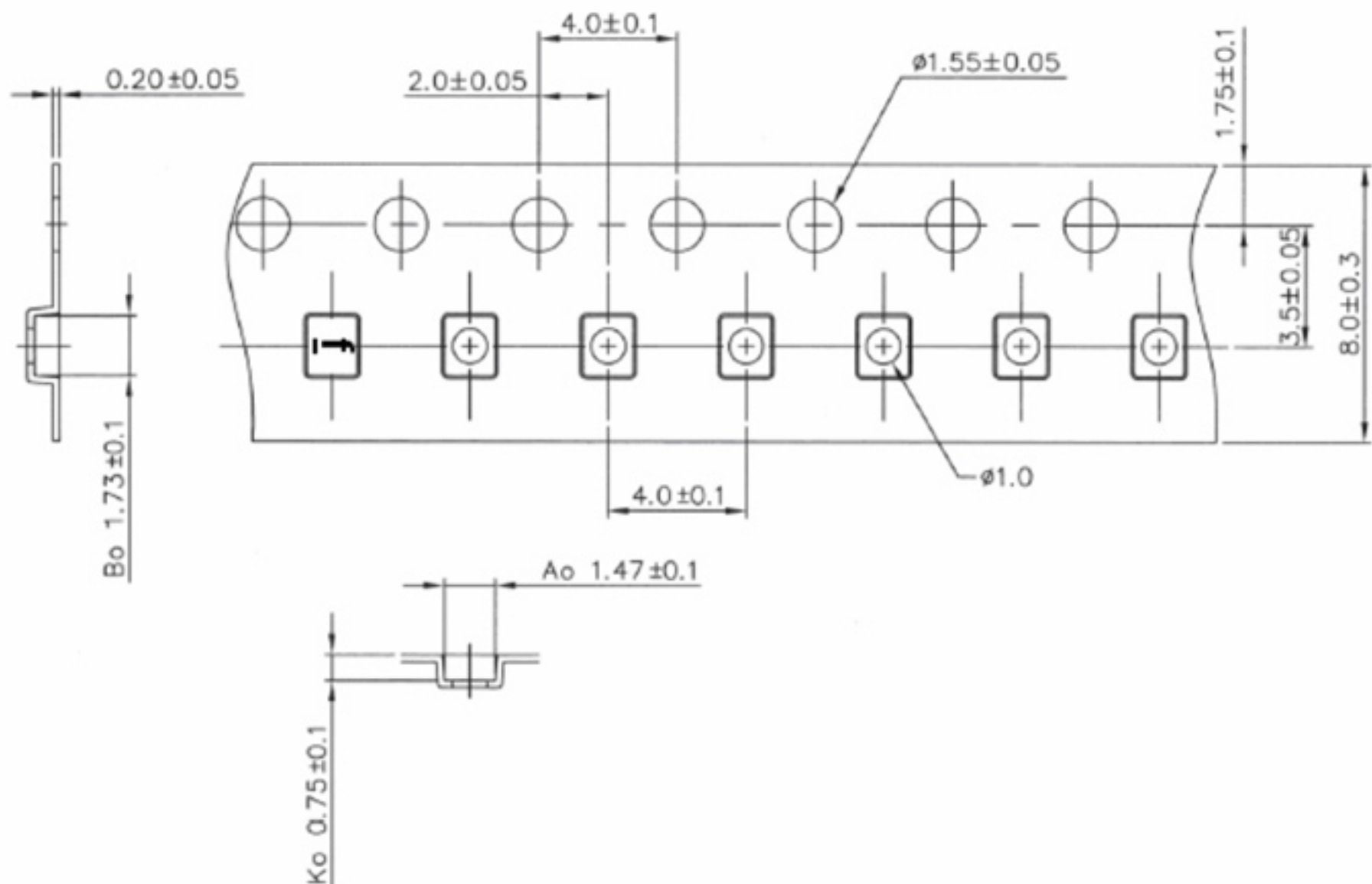

G. RECOMMENDED REFLOW PROFILE :

1. Preheating shall be fixed at 150~180°C for 60~90 seconds.
2. Ascending time to preheating temperature 150°C shall be 30 seconds min.
3. Heating shall be fixed at 220°C for 50~80 seconds and at 260°C +0/-5°C peak (20~40sec).
4. Time: 2 times.

