

Band Stop Filter 836.5/897.5 MHz DVB-T/LTE Notch SMD 3.0×3.0mm

MODEL NO.: TE0135A

Rev.:1.0

A. MAXIMUM RATING:

1. Input Power Level: 15 dB_m
2. DC voltage: 5 V
3. Operating Temperature: -40°C to +105°C
4. Storage Temperature: -40°C to +105°C
5. Moisture Sensitivity Level: Level 1 (MSL1)

B. CHARACTERISTICS:

Item	Unit	Min.	Typ.	Max.
Center frequency	MHz	-	836.5 897.5	-
Minimum Insertion Loss (470 ~ 752 MHz)	dB	-	0.8	2.0
Maximum Insertion Loss				
470 ~ 752 MHz	dB	-	1.6	3.0
752 ~ 806 MHz	dB	-	2.1	5.5
Maximum VSWR				
Input port (470 ~ 752 MHz)	-	-	2.4	-
Output port (470 ~ 752 MHz)	-	-	2.5	-
Attenuation (reference from 0dB)				
87 ~ 108 MHz	dB	17	21	-
174 ~ 240 MHz	dB	7	11	-
824 ~ 849 MHz	dB	7	14	-
880 ~ 915 MHz	dB	15	20	-
1710 ~ 1785 MHz	dB	28	54	-
1850 ~ 1910 MHz	dB	32	52	-
1920 ~ 1980 MHz	dB	32	52	-
Source impedance Z_s	Ω	-	50	-
Load impedance Z_L	Ω	-	50	-

Note1. Specification for ILmax is 3.5dB for -10°C to +60°C.

C. Transfer Function :

Stop Band

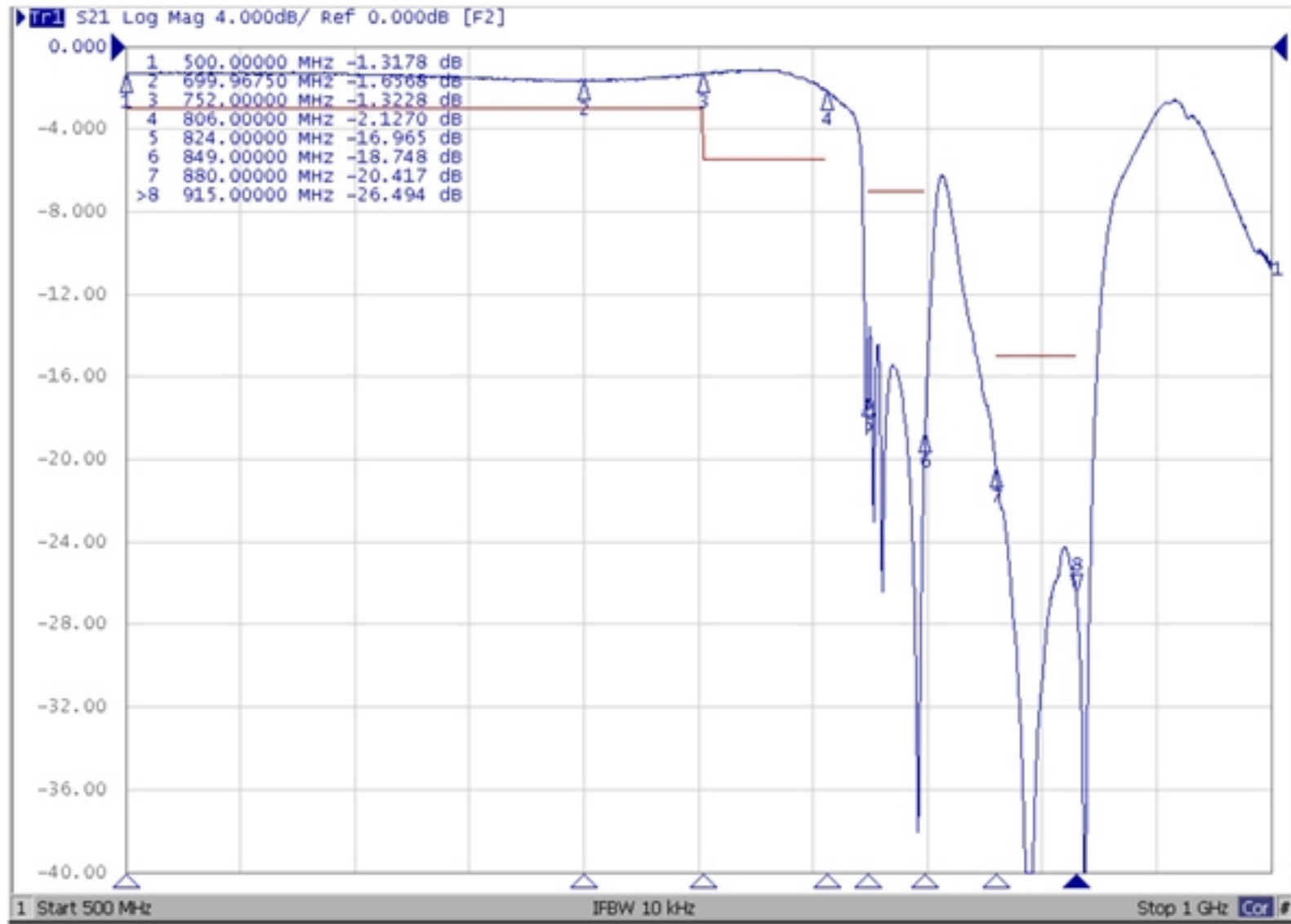

Wide Band

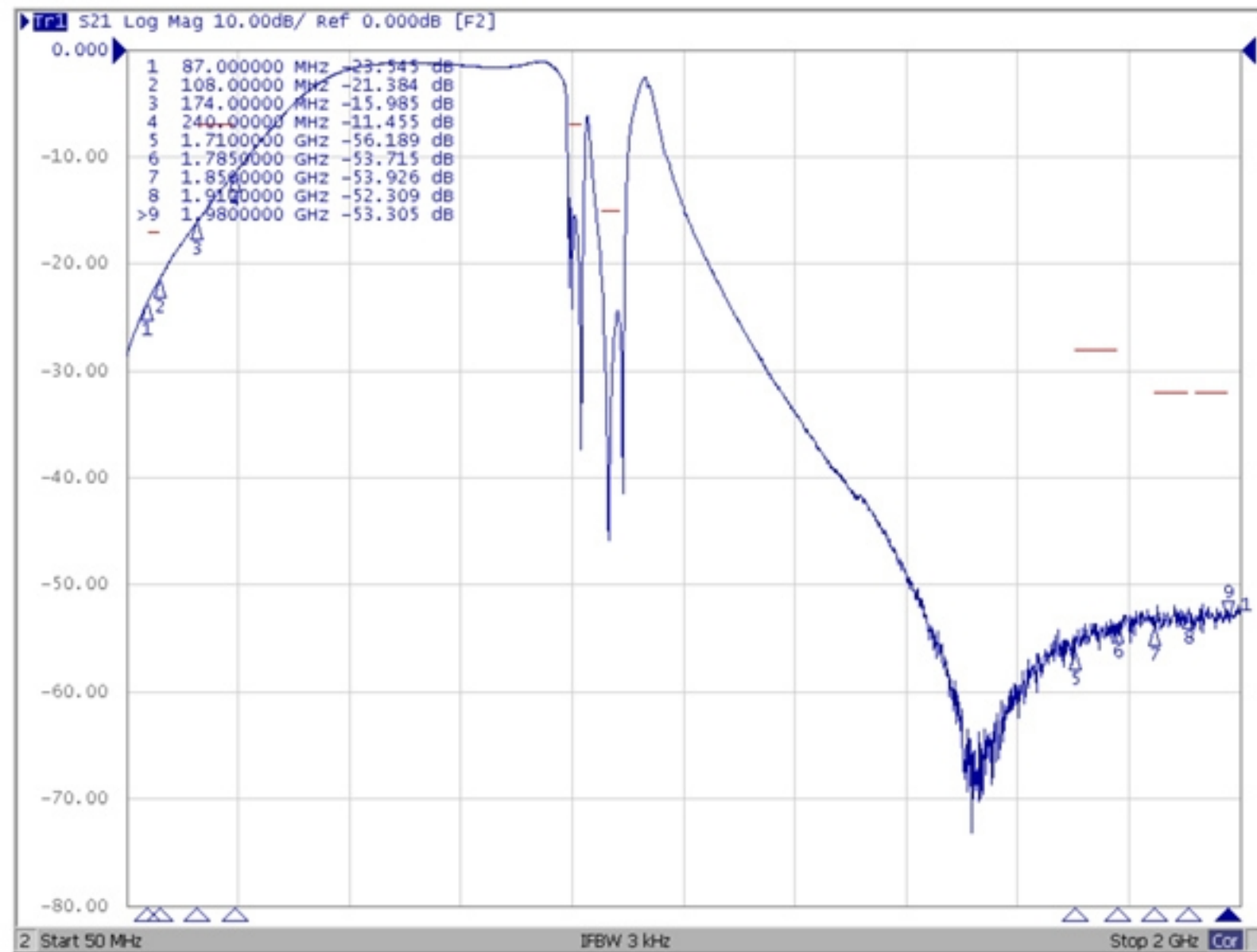

D. MEASUREMENT CIRCUIT:

$$L_1 = 18 \text{ nH}$$

$$L_2 = 27 \text{ nH}$$

$$L_3 = 21 \text{ nH}$$

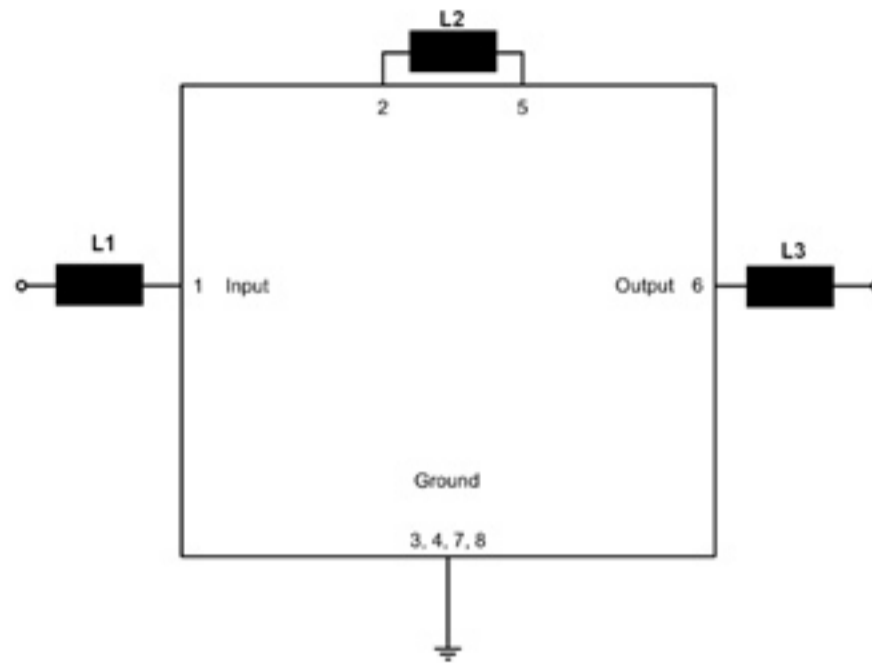

E. OUTLINE DRAWING:

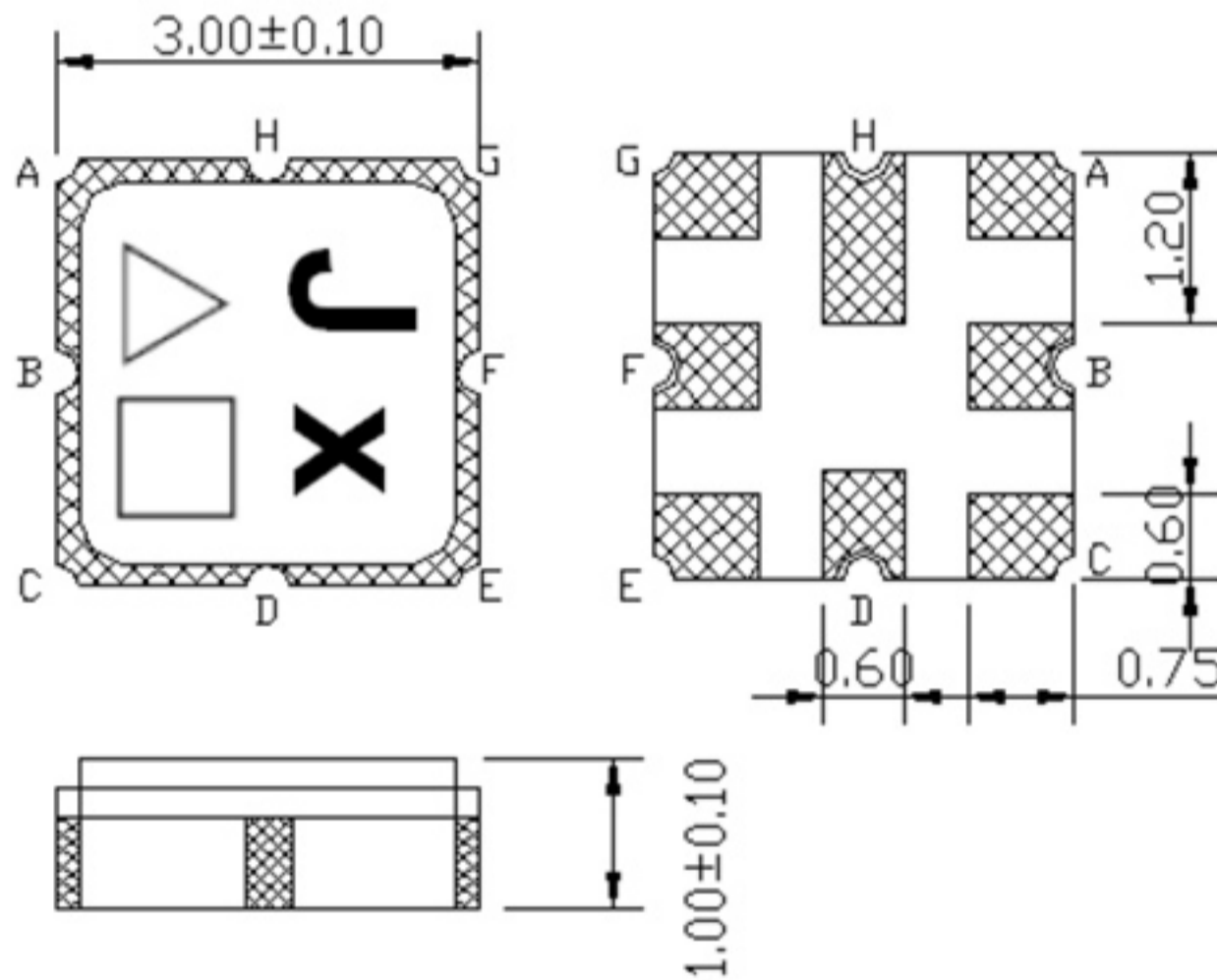

\triangle : Year Code (2009->9, 2010->0, ..., 2018->8)

\square : Date Code (Follow the table from planner each year)

WK01	WK02	WK03	WK04	WK05	WK06	WK07	WK08	WK09	WK10	WK11	WK12	WK13
A	B	C	D	E	F	G	H	I	J	K	L	M
WK14	WK15	WK16	WK17	WK18	WK19	WK20	WK21	WK22	WK23	WK24	WK25	WK26
N	O	P	Q	R	S	T	U	V	W	X	Y	Z
WK27	WK28	WK29	WK30	WK31	WK32	WK33	WK34	WK35	WK36	WK37	WK38	WK39
a	b	c	d	e	f	g	h	i	j	k	l	m
WK40	WK41	WK42	WK43	WK44	WK45	WK46	WK47	WK48	WK49	WK50	WK51	WK52
n	o	p	q	r	s	t	u	v	w	x	y	z

F. PCB FOOTPRINT:

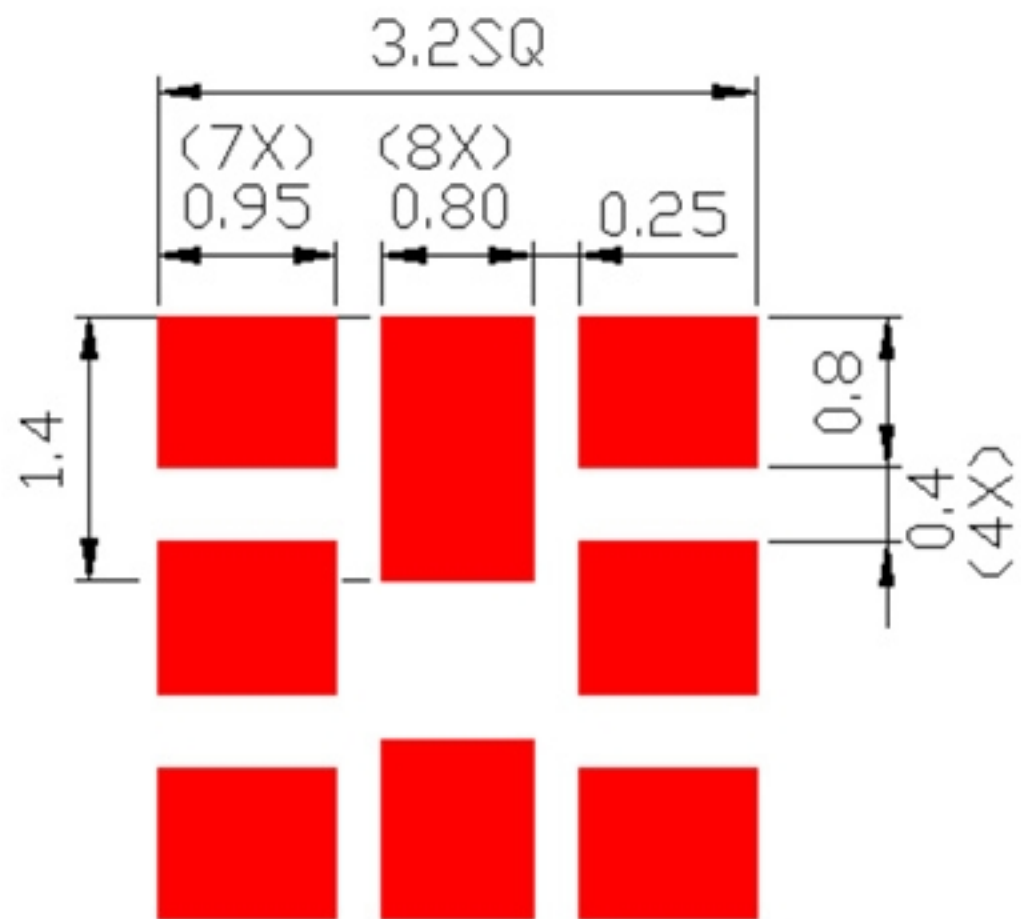

G. PACKING:

1. REEL DIMENSION

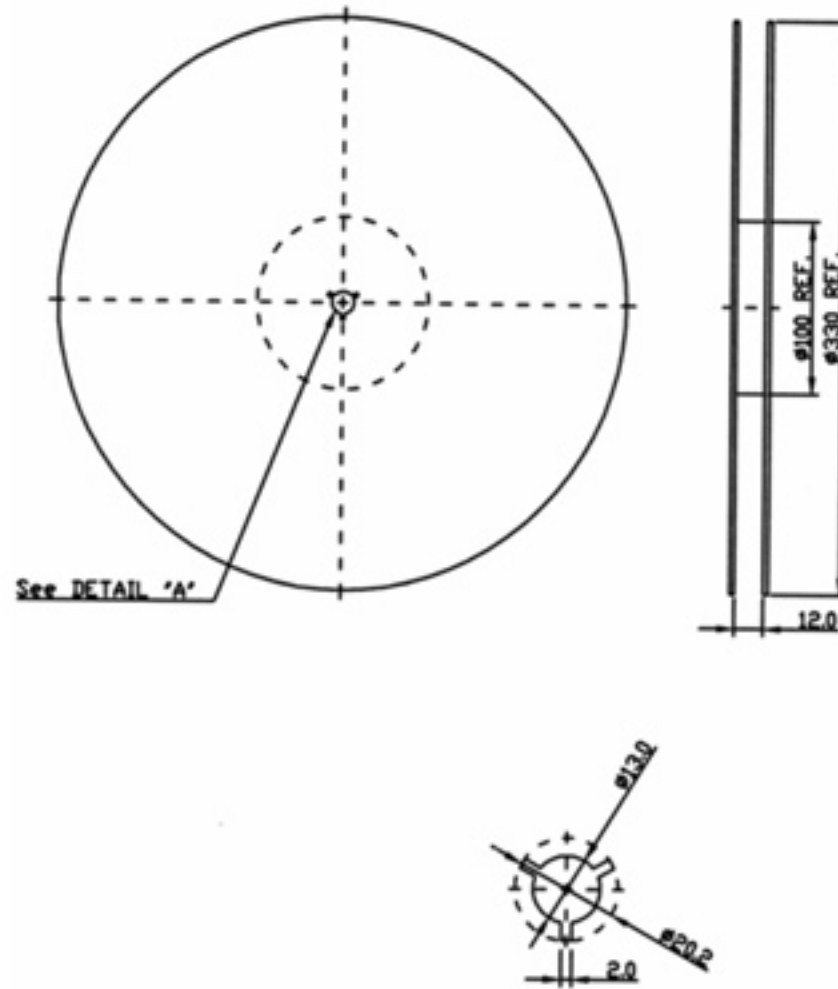

2. TAPE DIMENSION

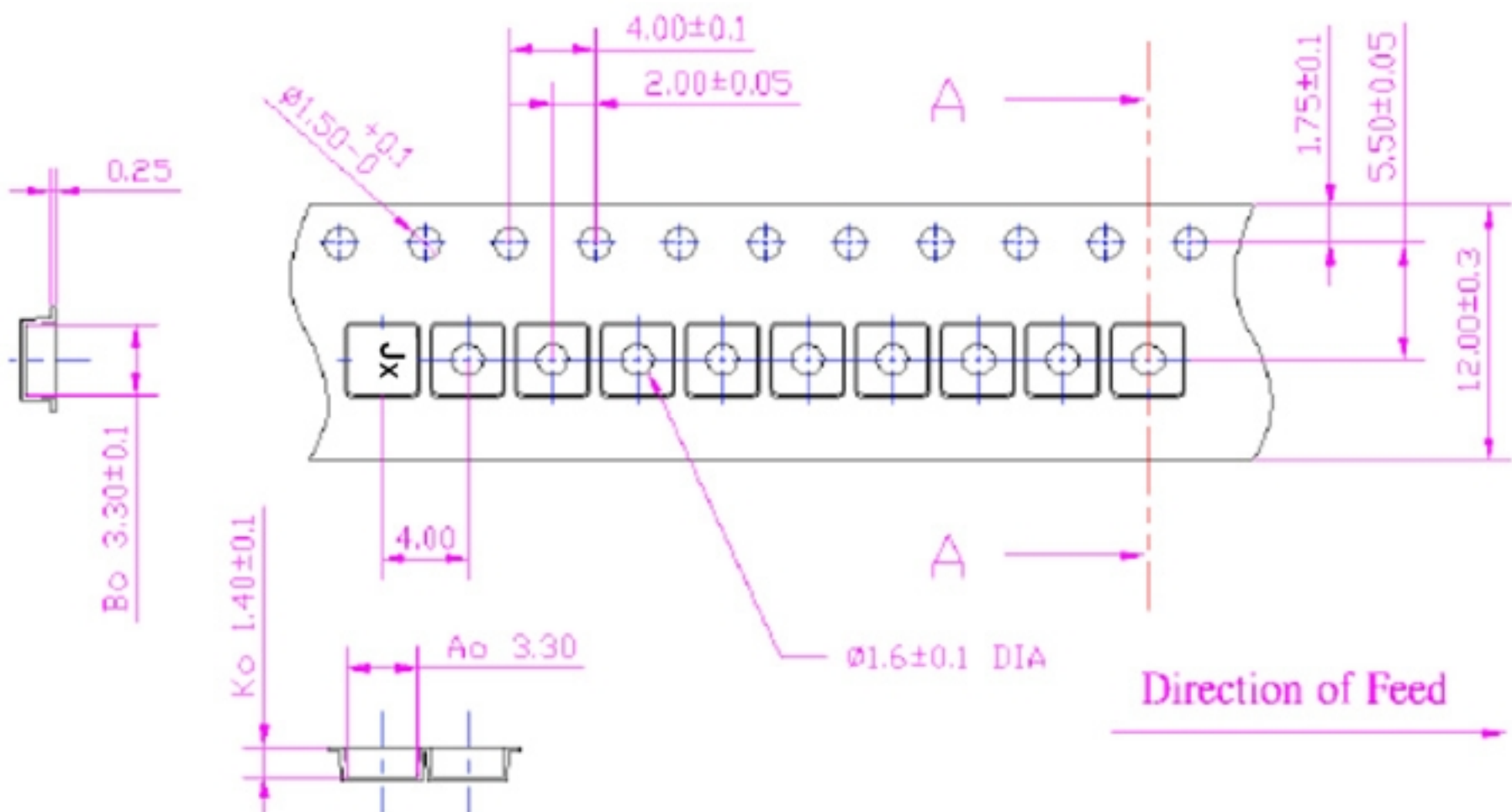

H. RECOMMENDED REFLOW PROFILE :

1. Preheating shall be fixed at 150~180°C for 60~90 seconds.
2. Ascending time to preheating temperature 150°C shall be 30 seconds min.
3. Heating shall be fixed at 220°C for 50~80 seconds and at 260°C +0/-5°C peak (20~40sec).
4. Time: 2 times.

