

SAW Filter 780 MHz Band 28 CSP 1.1×0.9 mm

MODEL NO.: TA2394A

REV. No.:1.0

A. MAXIMUM RATING:

1. Maximum Input Power: 10 dBm
2. DC voltage: 0 V
3. Operating Temperature: -40 °C to +85 °C
4. Storage Temperature: -40 °C to +85 °C
6. Moisture Sensitive Level: Level 3 (MSL3)

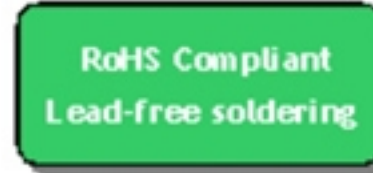

Electrostatic Sensitive Device (ESD)

B. ELECTRICAL CHARACTERISTICS:

Item	Unit	Min.	Typ.	Max.
Center frequency	MHz	-	780.5	-
Insertion Loss (758 ~ 803 MHz)	dB	-	2.0	3.0
Amplitude Ripple (758 ~ 803 MHz)	dB _{p-p}	-	0.8	2.0
VSWR (758 ~ 803 MHz)	-	-	1.9	2.2
Attenuation (reference level from 0 dB)				
80 ~ 703 MHz	dB	30	33	-
703 ~ 733 MHz	dB	35	38	-
733 ~ 745 MHz	dB	40	47	-
825 ~ 915 MHz	dB	20	26	-
1516 ~ 1915 MHz	dB	40	43	-
1920 ~ 2025 MHz	dB	36	41	-
2274 ~ 2500 MHz	dB	30	37	-
4900 ~ 6000 MHz	dB	25	31	-
Temperature Coefficient of Frequency	ppm/°C	-	-36	-

C. Frequency Characteristics:

Span 200 MHz

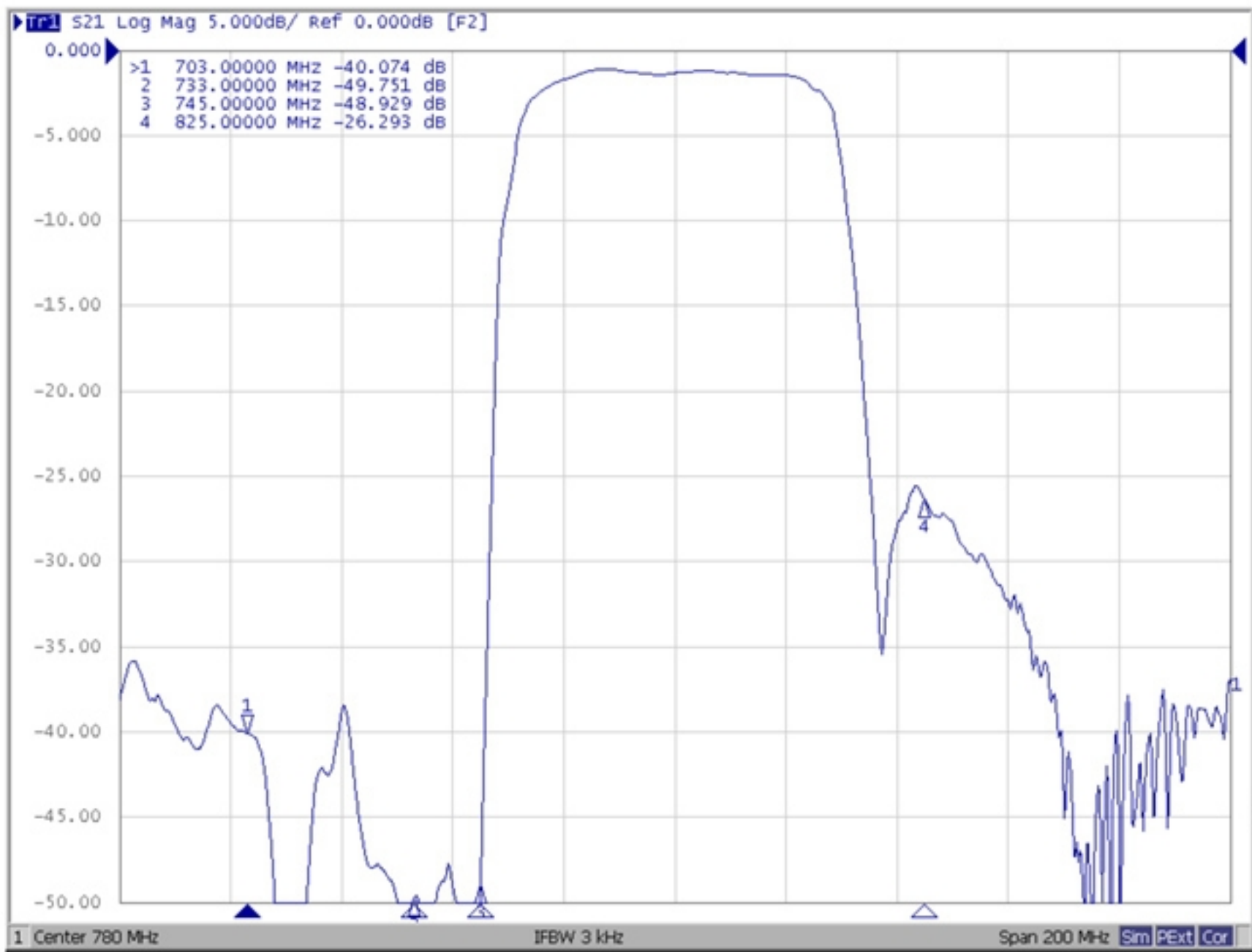

S21dB Span 6000 MHz

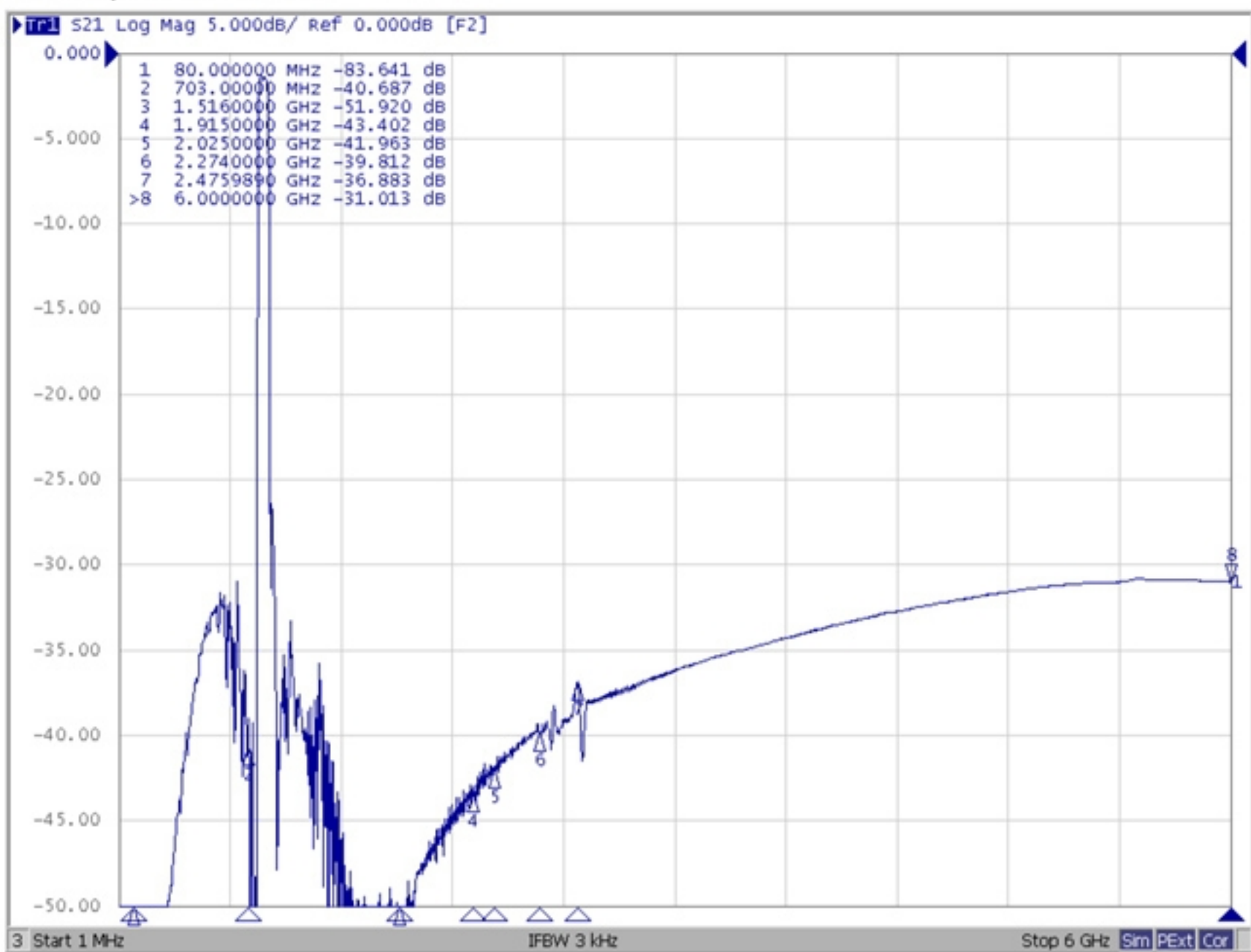

Span 100 MHz

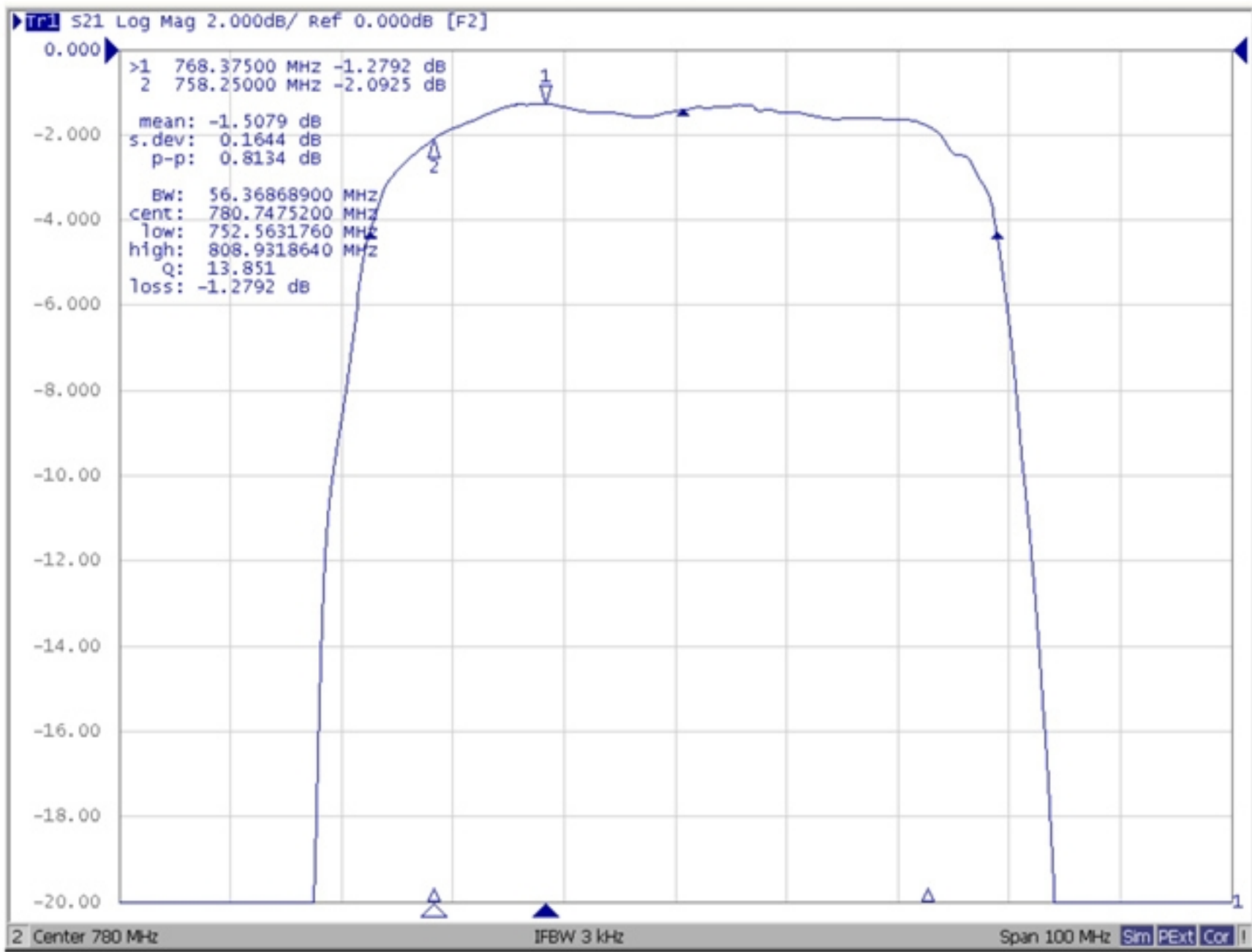

Reflective Characteristic

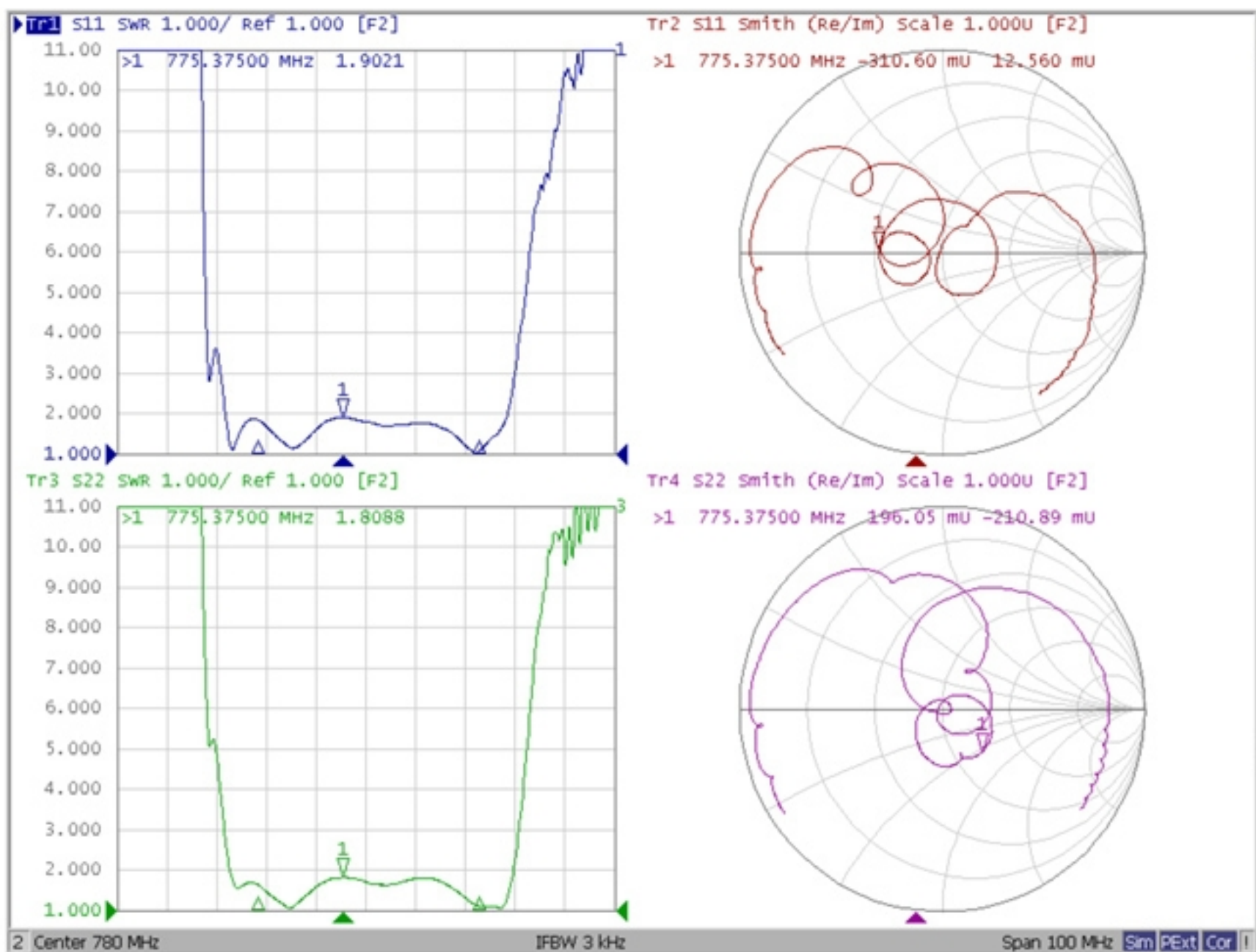

D. MEASUREMENT CIRCUIT:

Bottom View

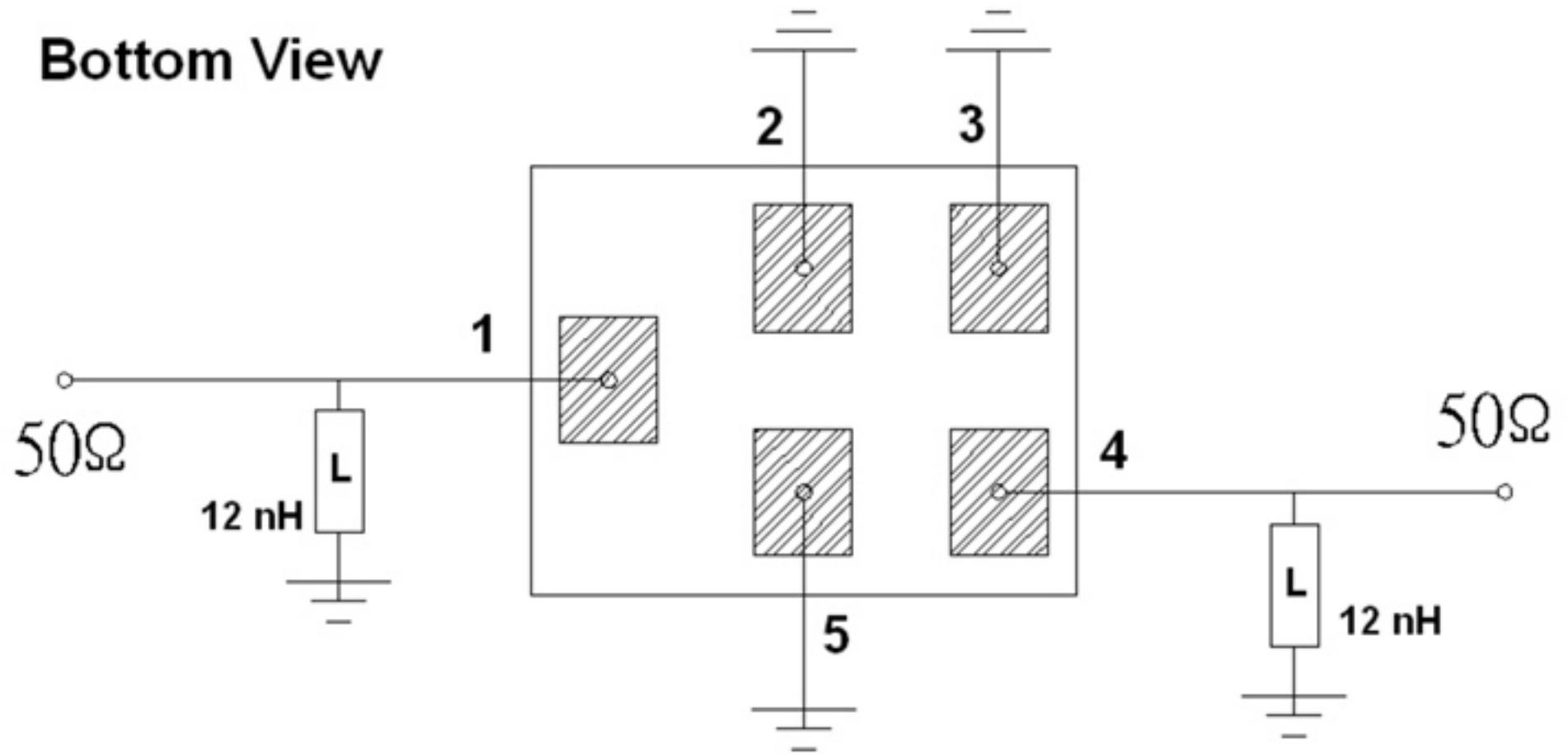

Source Impedance: 50 Ω

Load Impedance: 50 Ω

E. PCB Footprint:

 : Land Pattern
Unit: mm

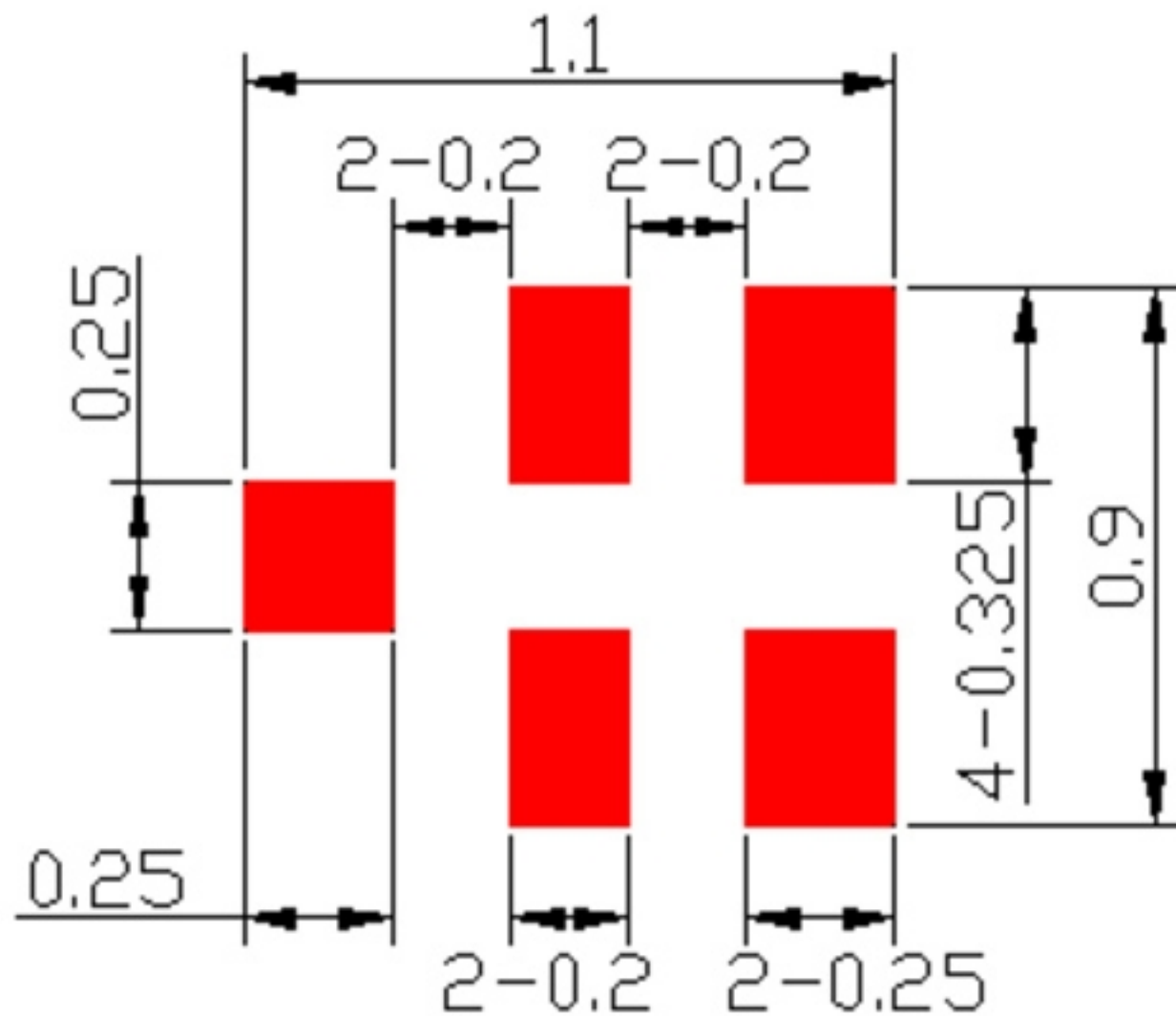

F. OUTLINE DRAWING:

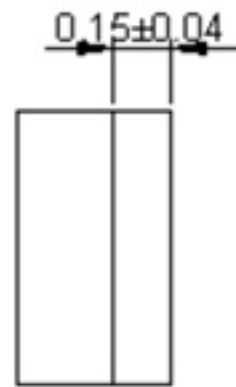
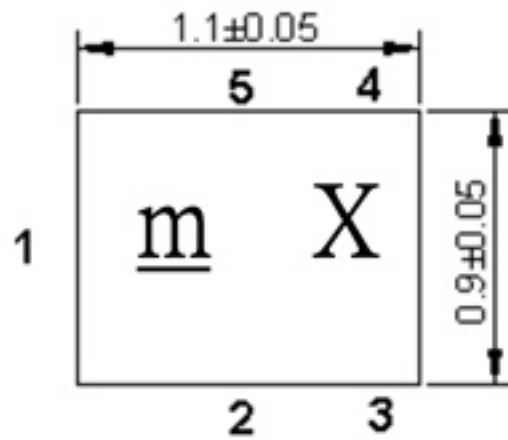

All tolerances are +/-0.05 mm unless otherwise specified
 Coplanarity : 0.1 mm max.
 1 to 5 : Pin No.
 Unit : mm

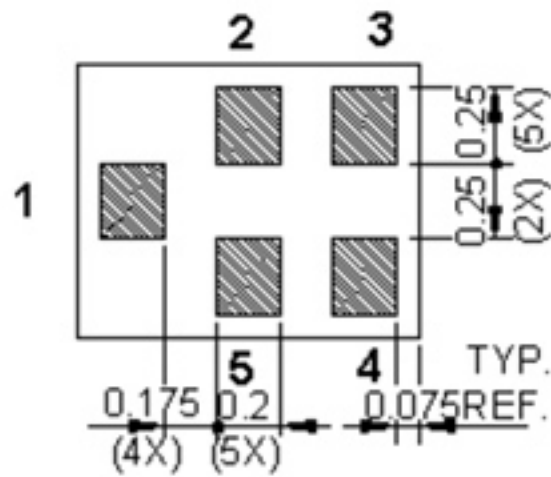

Marking Descriptions	
<u>m</u>	Series Number
X	Date Code(Year+Month)

Pin Description	
2, 3, 5	Ground
1	Input
4	Output

Date Code (year+month)

Year	Jan.	Feb.	Mar.	Apr.	May.	Jun.	Jul.	Aug.	Sep.	Oct.	Nov.	Dec.
2013	A	B	C	D	E	F	G	H	J	K	L	M
2014	N	P	Q	R	S	T	U	V	W	X	Y	Z
2015	a	b	c	d	e	f	g	h	j	k	l	m
2016	n	p	q	r	s	t	u	v	w	x	y	z
2017	<u>A</u>	<u>B</u>	<u>C</u>	<u>D</u>	<u>E</u>	<u>F</u>	<u>G</u>	<u>H</u>	<u>J</u>	<u>K</u>	<u>L</u>	<u>M</u>
2018	<u>N</u>	<u>P</u>	<u>Q</u>	<u>R</u>	<u>S</u>	<u>T</u>	<u>U</u>	<u>V</u>	<u>W</u>	<u>X</u>	<u>Y</u>	<u>Z</u>
2019	<u>a</u>	<u>b</u>	<u>c</u>	<u>d</u>	<u>e</u>	<u>f</u>	<u>g</u>	<u>h</u>	<u>i</u>	<u>k</u>	<u>l</u>	<u>m</u>
2020	<u>n</u>	<u>p</u>	<u>q</u>	<u>r</u>	<u>s</u>	<u>t</u>	<u>u</u>	<u>v</u>	<u>w</u>	<u>x</u>	<u>y</u>	<u>z</u>

H. RECOMMENDED REFLOW PROFILE :

1. Preheating shall be fixed at 150~180°C for 60~90 seconds.
2. Ascending time to preheating temperature 150°C shall be 30 seconds min.
3. Heating shall be fixed at 220°C for 50~80 seconds and at 260°C +0/-5°C peak (20~40sec).
4. Time: 2 times.

