

SAW Filter 869MHz

MODEL NO.:TA1662A

REV. NO.:1.0

A. MAXIMUM RATING:

1. Input Power Level: 13 dBm
2. DC Voltage : 0V
3. Operating Temperature: -40 °C to +85 °C
4. Storage Temperature: -40 °C to +85 °C
5. Moisture Sensitivity Level: (MSL): Level 1

RoHS Compliant
Lead free
Lead-free soldering

Electrostatic Sensitive Device (ESD)

B. ELECTRICAL CHARACTERISTICS:

Terminating source impedance (single) : $Z_s = 50 \Omega$

Terminating load impedance (single) : $Z_L = 50 \Omega$

Item	Unit	Min	Type.	Max
Center Frequency Fc	MHz	-	869	-
Insertion Loss (868~870 MHz) IL	dB		2.6	3.5max
Amplitude ripple(868~870 MHz)	dB		0.6	1.2max
Attenuation				
10 ~ 845 MHz	dB	35	40	
845 ~ 851 MHz	dB	32	36	
851 ~ 856.8 MHz	dB	20	24	
883 ~ 892 MHz	dB	20	35	
892 ~ 1000 MHz	dB	42	47	
Package size	mm	SMD 3x3		

C... TEST CIRCUIT:

(2): Unbalance Port

(5): Unbalance Port

Others: Ground

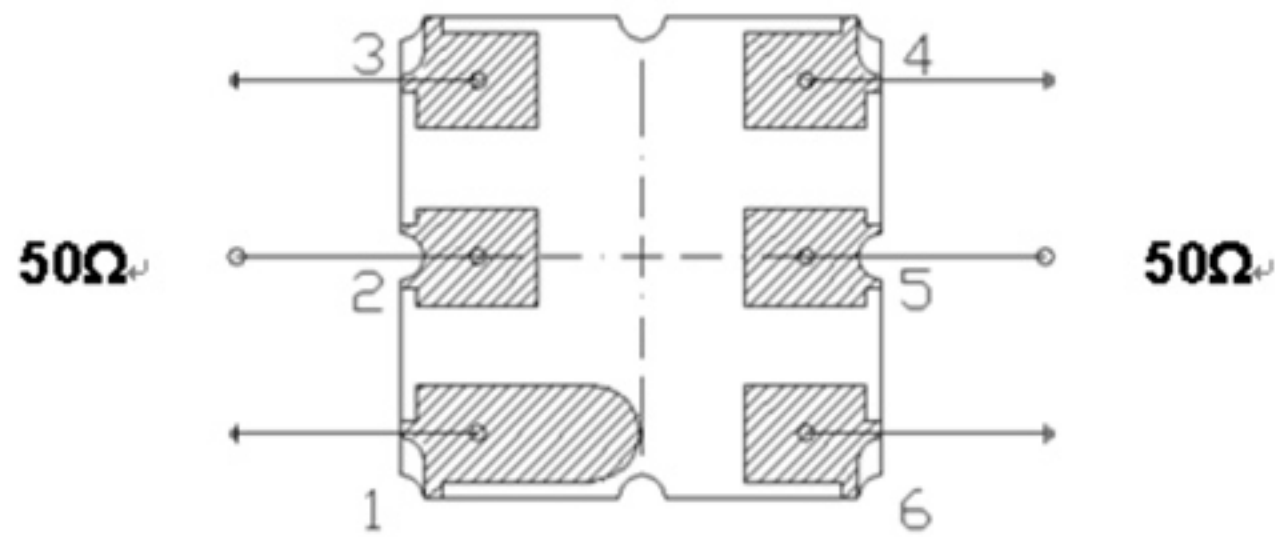

D. Frequency Characteristics: S21 response :(Span 200MHz)

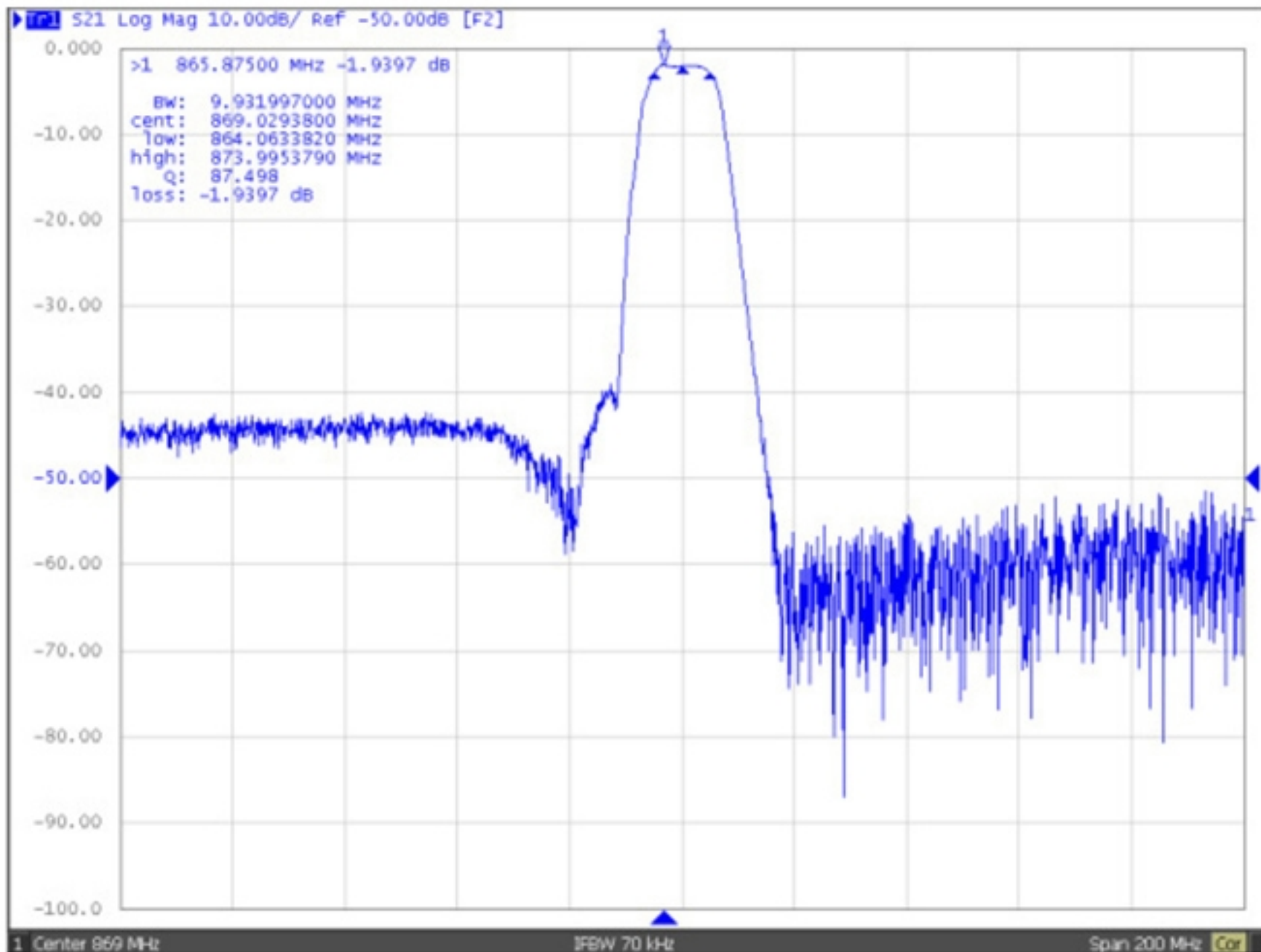

S21 response:(Span 20MHz)

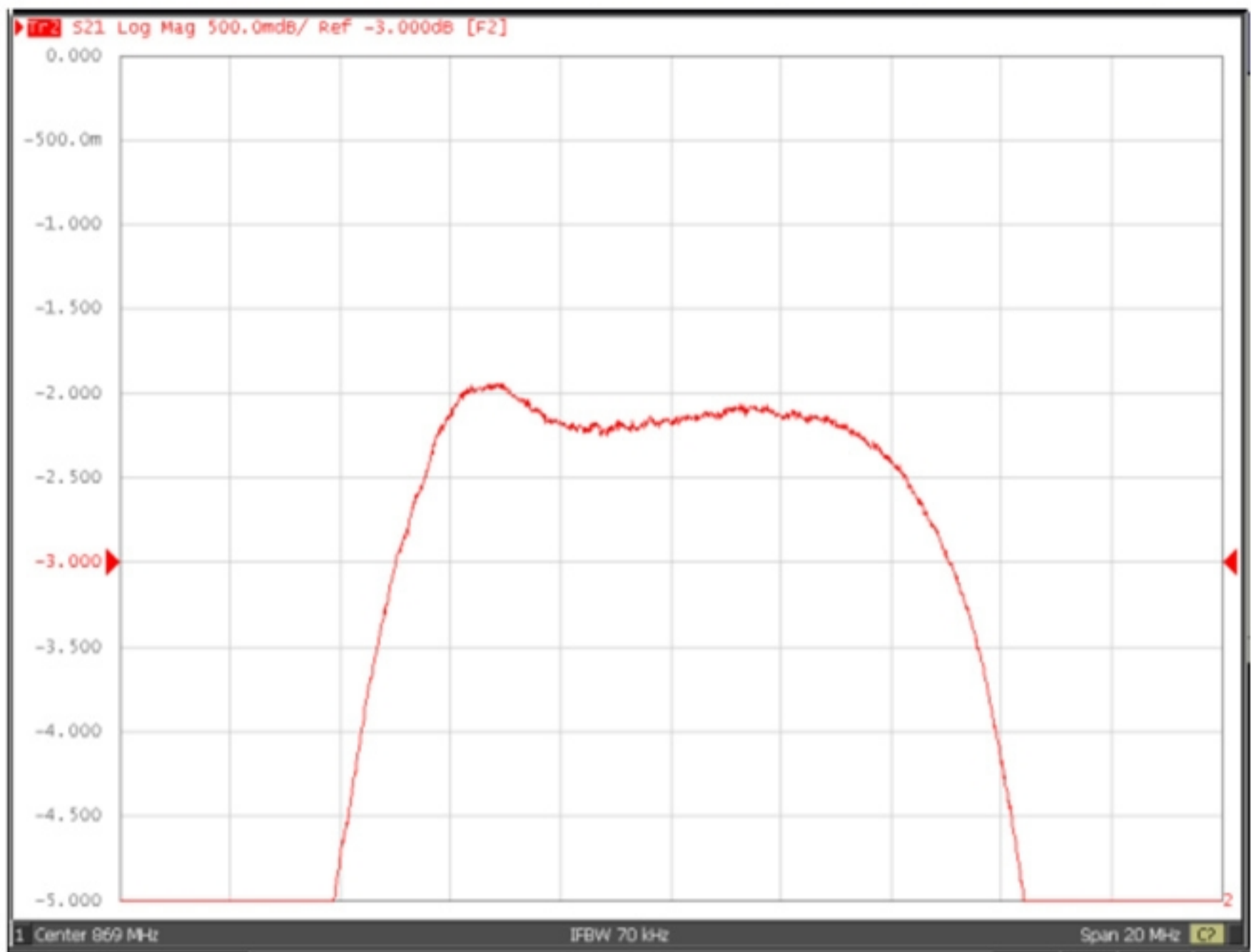

S21 response :(100KHz ~ 3GHz)

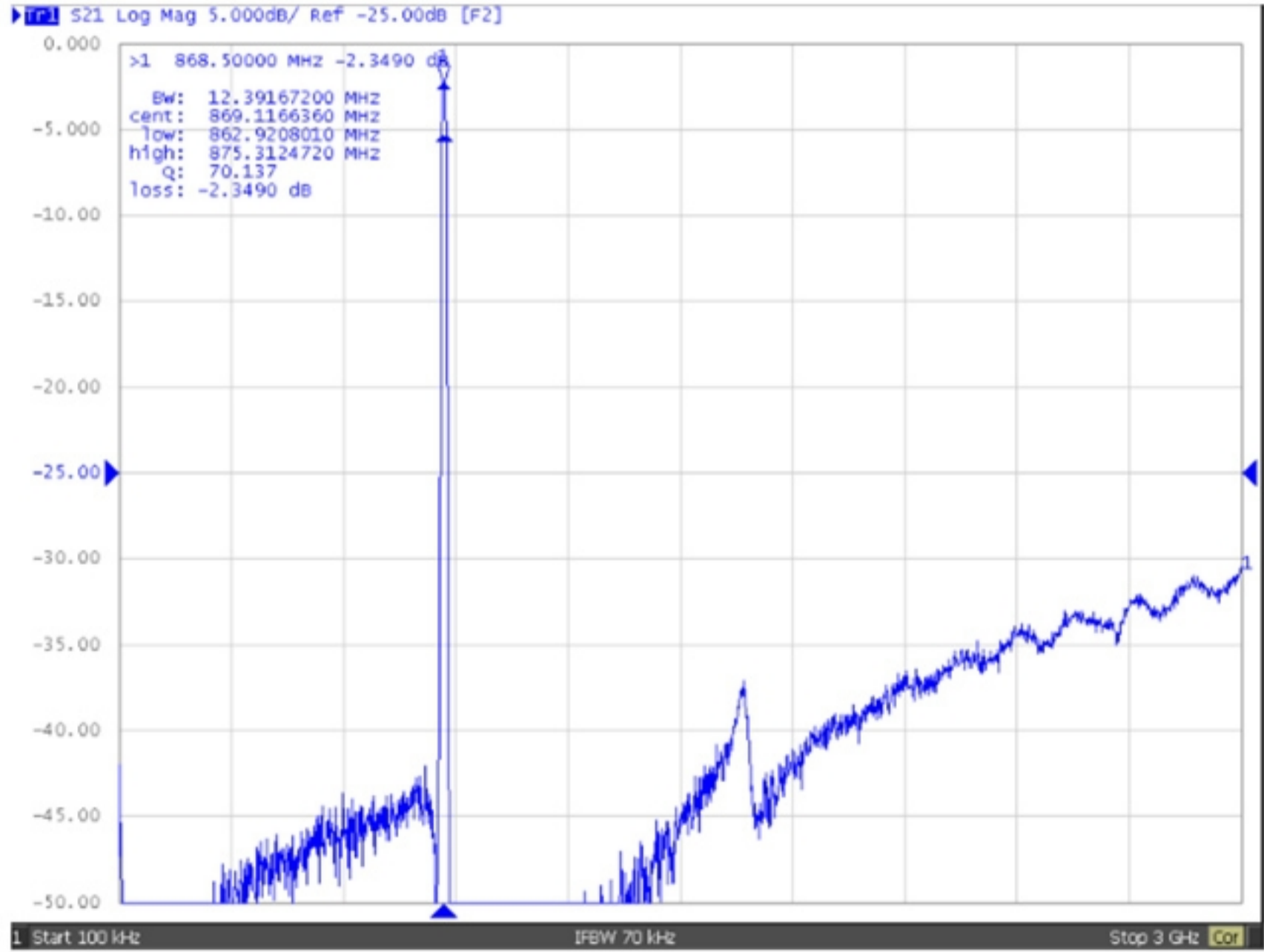

S11/S22 response:

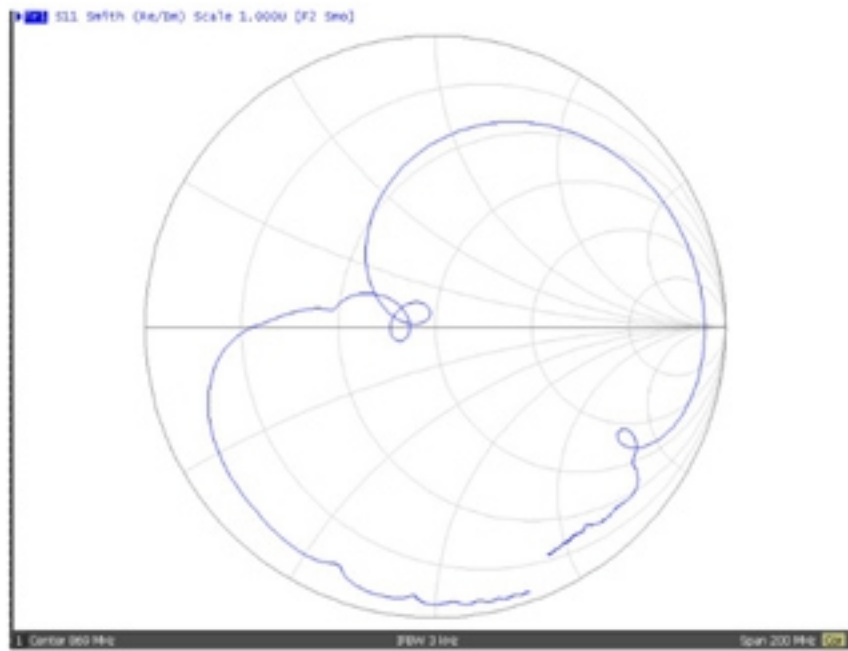

E.OUTLINE DRAWING:

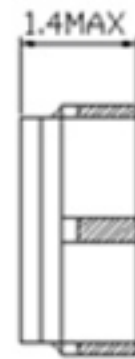
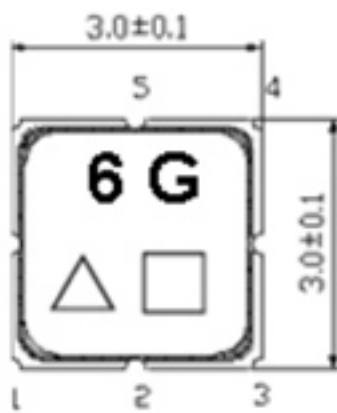

Unit : mm

Not Specified Tolerance : +/-0.15 mm

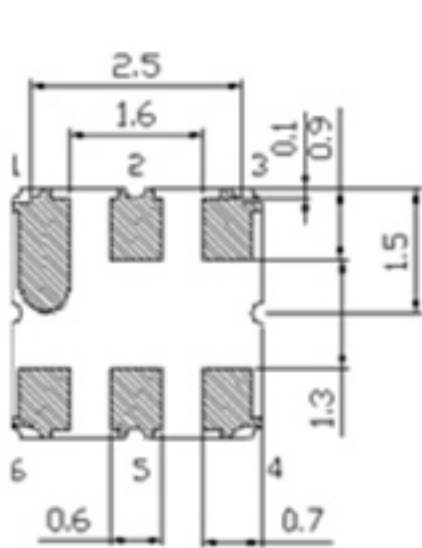

Pin No.	Symbol	Function
1	GND	Ground
2	IN	Input
3	GND	Ground
4	GND	Ground
5	OUT	Output
6	GND	Ground

Data code : See the table

WK	01	02	...	26	27	28	...	52
Code	A	B	...	Z	a	b	...	z

Year code : See the table

Year	2008	2009	2010	2011	...	2019	2020
Code	8	9	0	1	...	9	0

F. PACKING:

1. REEL DIMENSION
 (Please refer to FR-75D10 for packing quantity)

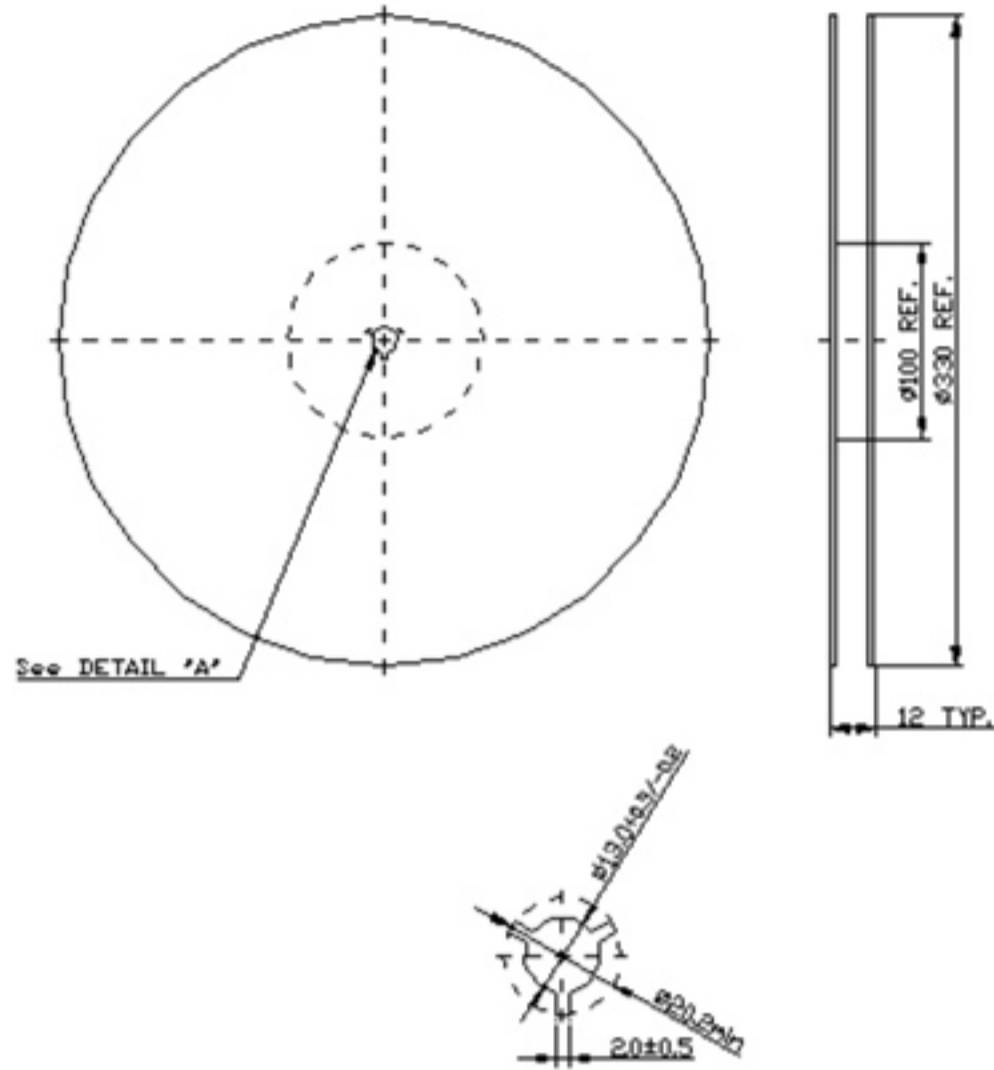

2. TAPE DIMENSION

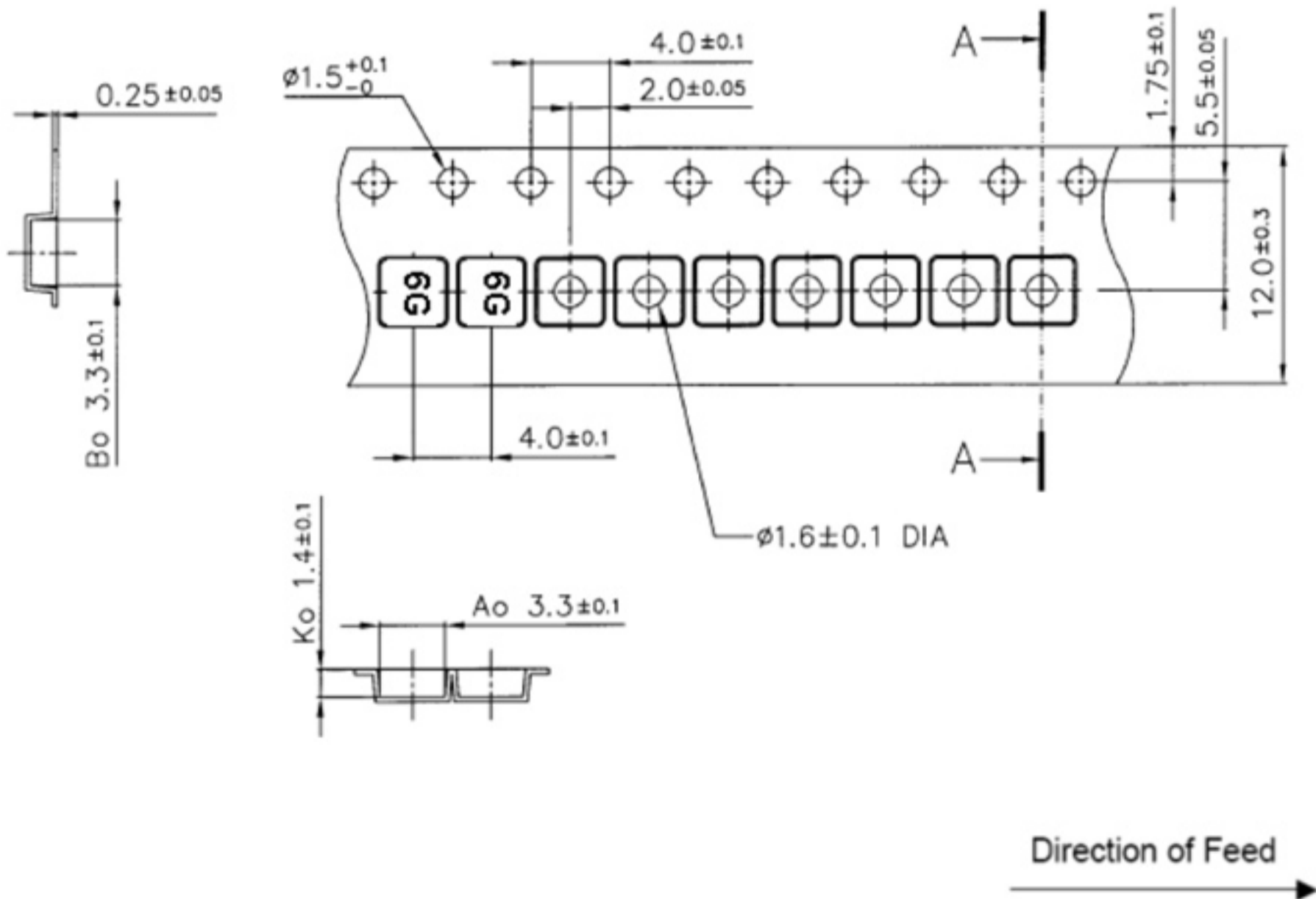

G. RECOMMENDED REFLOW PROFILE :

1. Preheating shall be fixed at $150\sim 180^{\circ}\text{C}$ for $60\sim 90$ seconds.
2. Ascending time to preheating temperature 150°C shall be 30 seconds min.
3. Heating shall be fixed at 220°C for $50\sim 80$ seconds and at $260^{\circ}\text{C} +0/-5^{\circ}\text{C}$ peak ($20\sim 40\text{sec}$).
4. Time: 2 times.

