

# SAW Filter 861 MHz

MODEL NO.: TA0452A

REV. NO.:2.0

## A. MAXIMUM RATING:

1. Input Power Level: 15 dB<sub>m</sub>
2. DC voltage: 5 V
3. Operating Temperature: -10°C to 60°C
4. Storage Temperature: -40°C to +85°C
5. Moisture Sensitivity Level: Level 1(MSL1)

RoHS Compliant  
Lead free  
Lead-free soldering

Electrostatic Sensitive Device

## B. CHARACTERISTICS:

Item				Min.	Typ.	Max.
Center frequency	Fc	MHz		-	861	-
Insertion loss	857 ~ 865 MHz	IL	dB	-	2.7	4.2
Amplitude ripple	857 ~ 865 MHz		dB	-	0.4	2.0
VSWR	857 ~ 865 MHz			-	1.4	2.2
<b>Attenuation</b>						
10.0 ~ 790.0		MHz	dB	40	55	-
790.0 ~ 820.0		MHz	dB	36	54	-
900.0 ~ 920.0		MHz	dB	35	50	-
920.0 ~ 940.0		MHz	dB	36	51	-
940.0 ~ 1000.0		MHz	dB	40	51	-
Source impedance		Zs	Ω	-	50	-
Load impedance		ZL	Ω	-	50	-

Note1. No matching network required for operation at 50Ω

### C. TRANSFER FUNCTION:



### Wideband

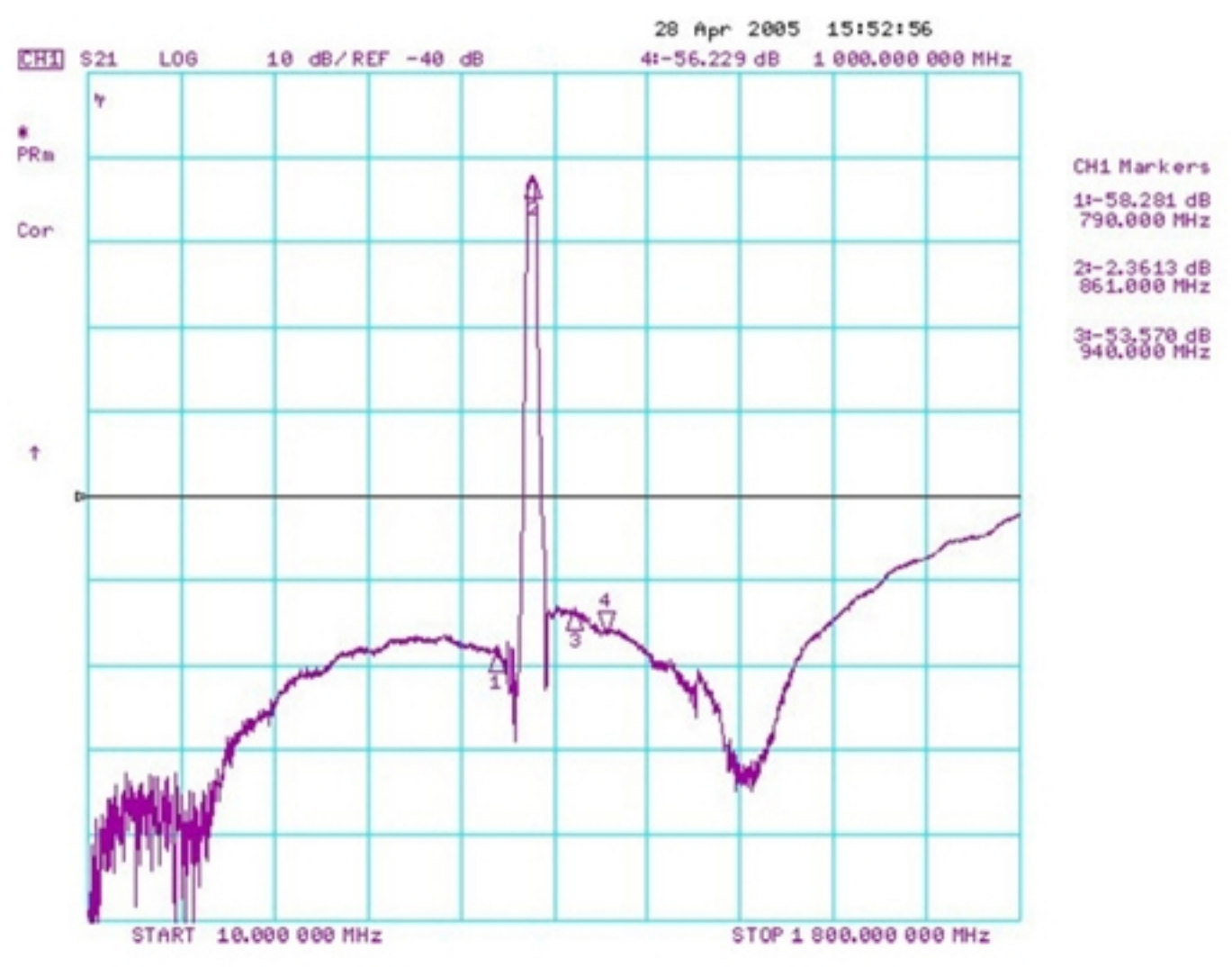

# D. REFLECTION FUNCTIONS:

S11

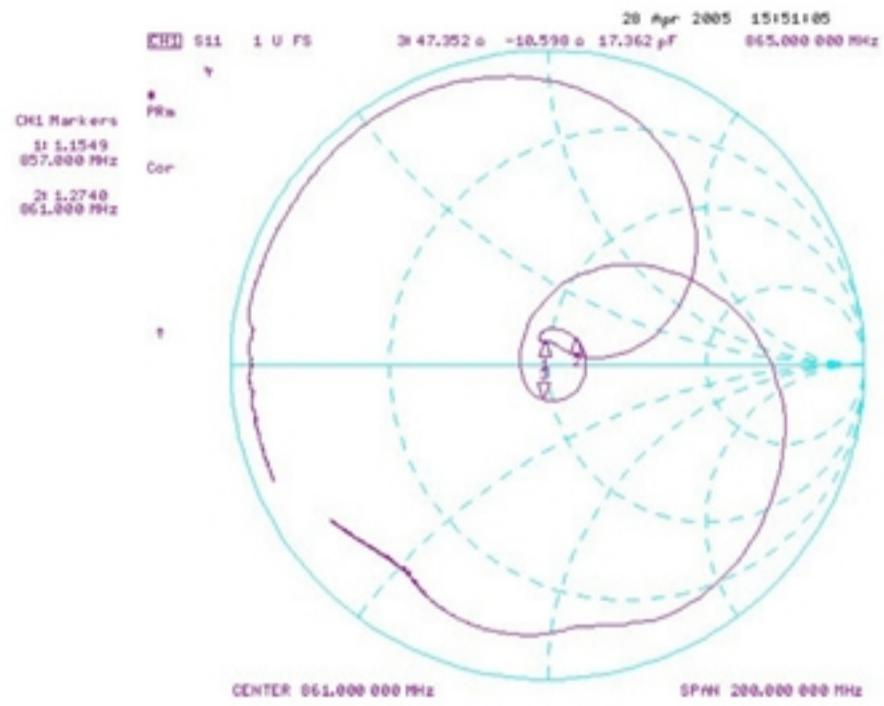
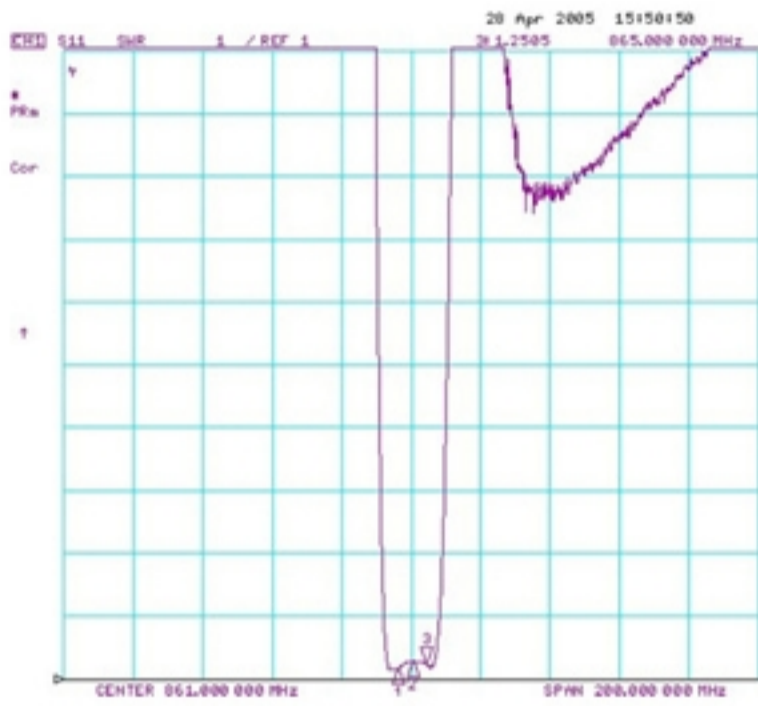

S22

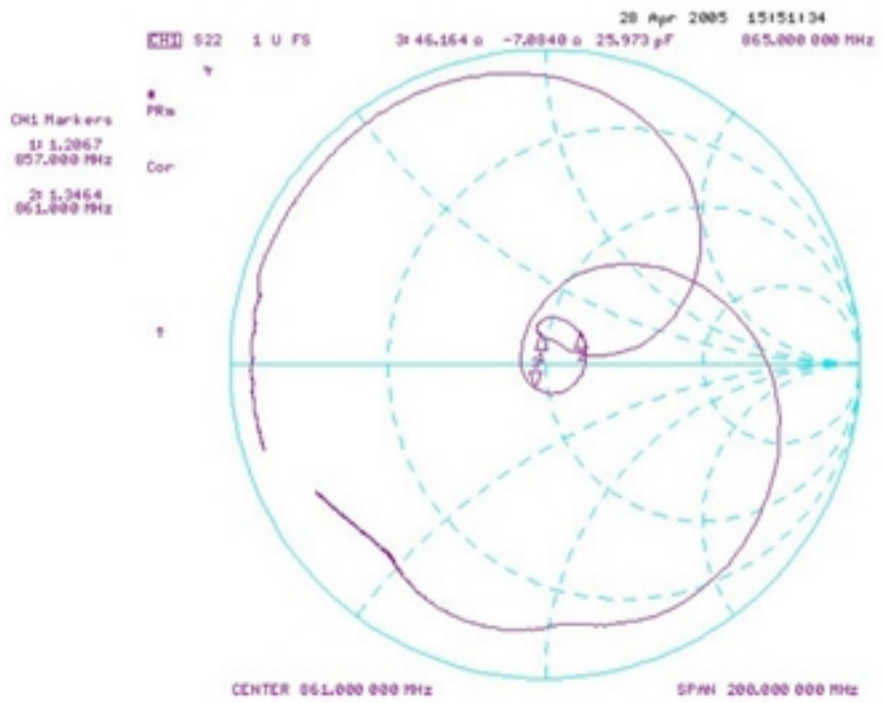
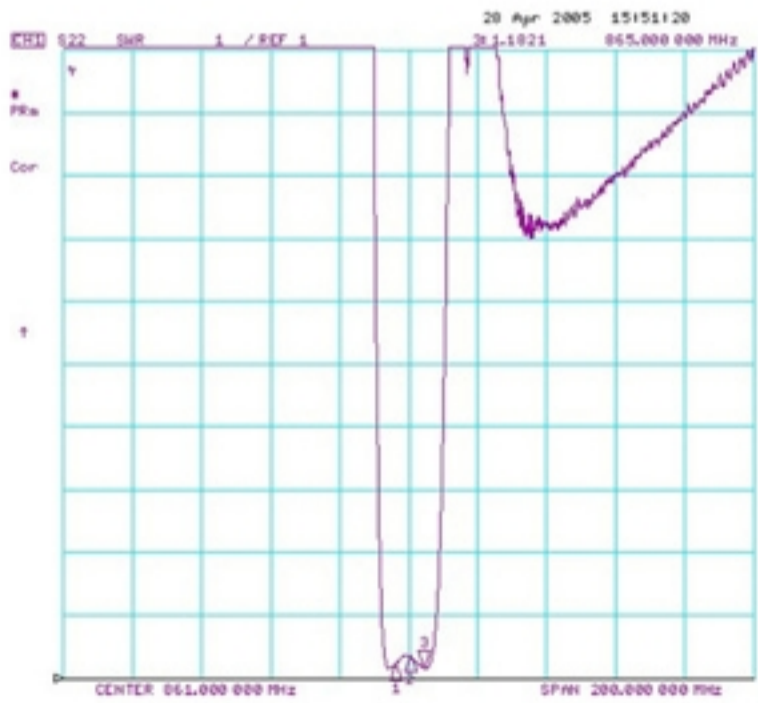

**E.OUTLINE DRAWING:**

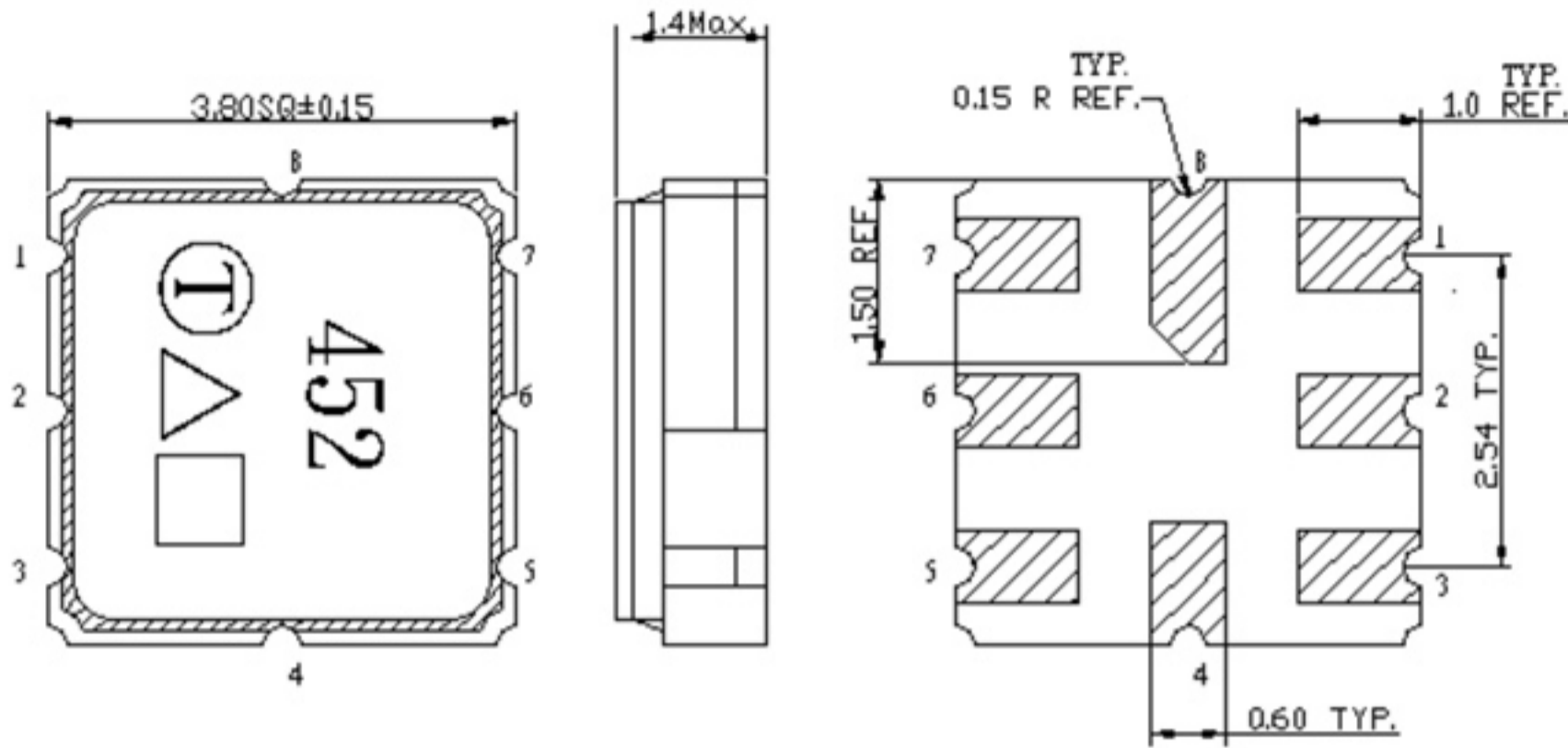

- #2 : Input
- #6 : Output
- #1, 3, 4, 5, 7, 8 : Ground
- △ : Year code
- : Date code
- Unit : mm

Product / Year Code- 4year cycle

Year	2019 2021	2020 2022
Product Code	A	a

Week Code Table

WK01	WK02	WK03	WK04	WK05	WK06	WK07	WK08	WK09	WK10	WK11	WK12	WK13
A	B	C	D	E	F	G	H	I	J	K	L	M
WK14	WK15	WK16	WK17	WK18	WK19	WK20	WK21	WK22	WK23	WK24	WK25	WK26
N	O	P	Q	R	S	T	U	V	W	X	Y	Z
WK27	WK28	WK29	WK30	WK31	WK32	WK33	WK34	WK35	WK36	WK37	WK38	WK39
a	b	c	d	e	f	g	h	i	j	k	l	m
WK40	WK41	WK42	WK43	WK44	WK45	WK46	WK47	WK48	WK49	WK50	WK51	WK52
n	o	p	q	r	s	t	u	v	w	x	y	z

### F. MEASUREMENT CIRCUIT:

HP Network analyzer

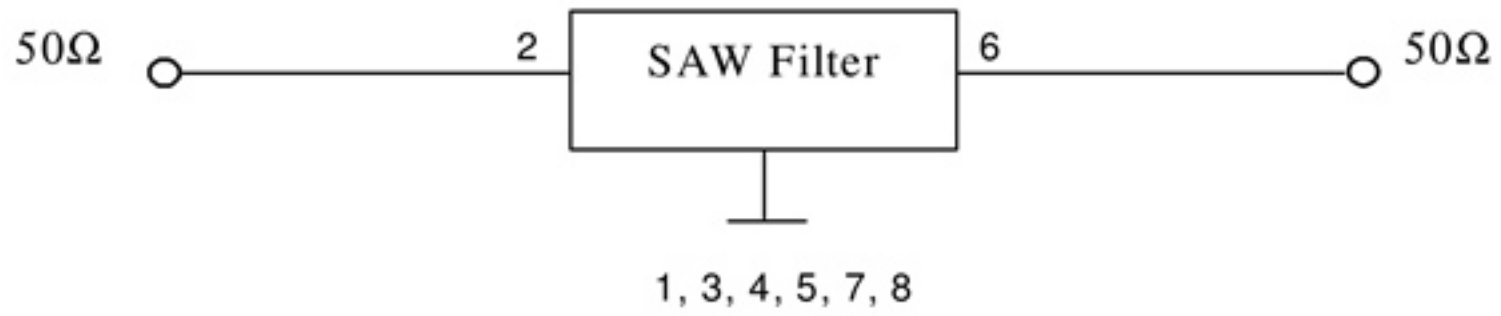

### G. PCB FOOTPRINT:

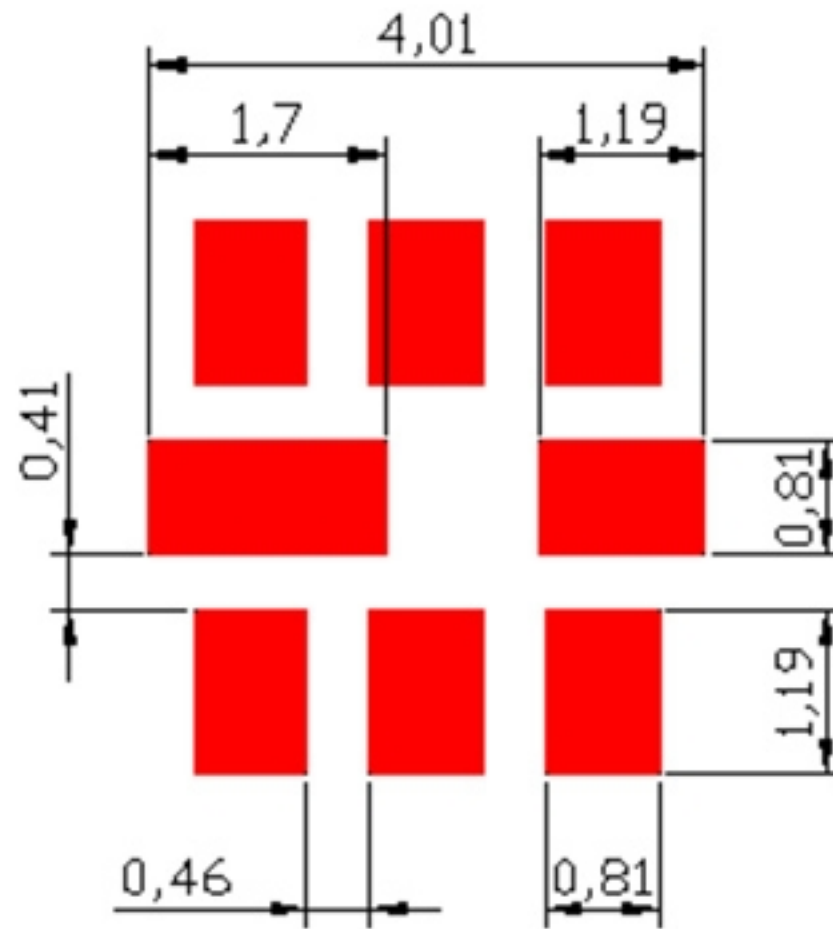



## H. PACKING:

1. REEL DIMENSION (Please refer to FR-75D10 for packing quantity)

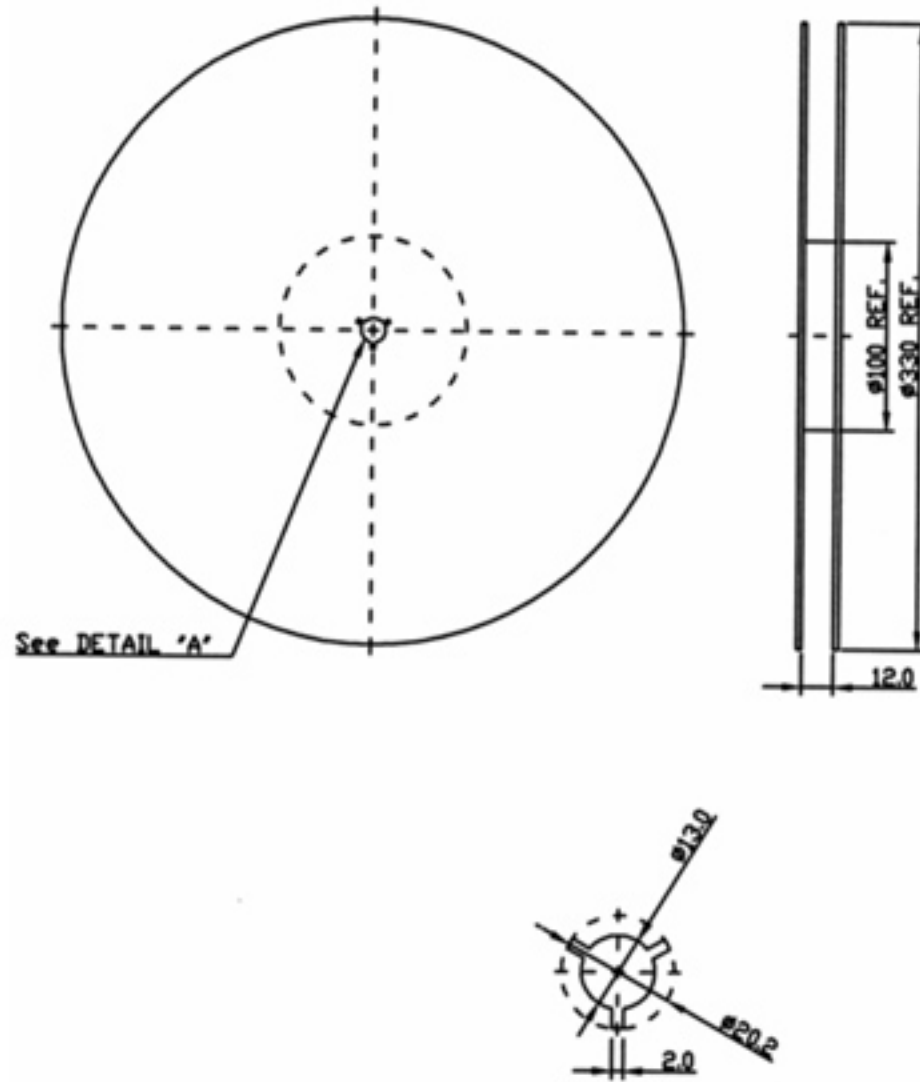

## 2. TAPE DIMENSION

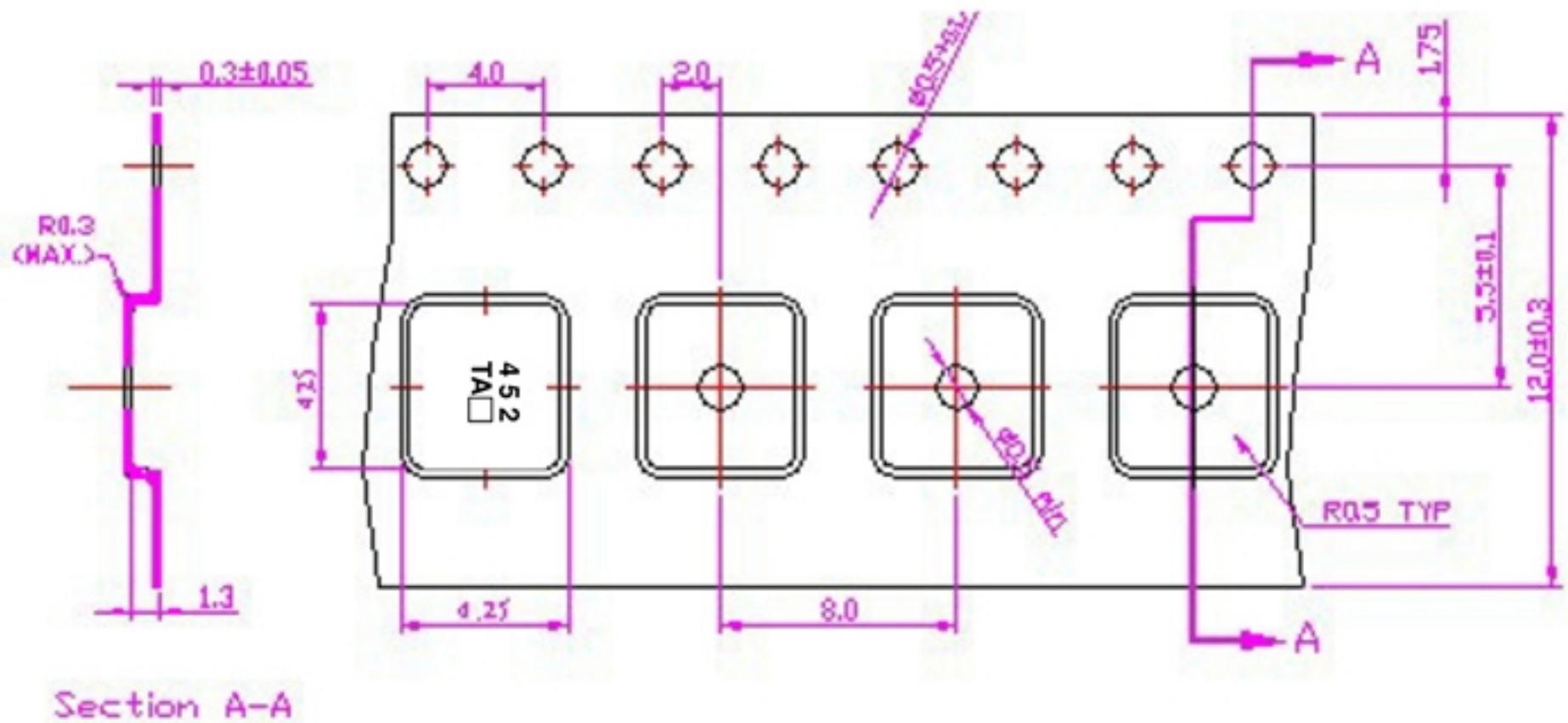

## I. RECOMMENDED REFLOW PROFILE:

1. Preheating shall be fixed at  $150\sim 180^{\circ}\text{C}$  for 60~90 seconds.
2. Ascending time to preheating temperature  $150^{\circ}\text{C}$  shall be 30 seconds min.
3. Heating shall be fixed at  $220^{\circ}\text{C}$  for 50~80 seconds and at  $260^{\circ}\text{C} +0/-5^{\circ}\text{C}$  peak (20~40sec).
4. Time: 2 times.

