

A. MAXIMUM RATING:

1. Input Power Level: 17 dB_m
2. DC voltage: 0 V
3. Operating Temperature: -55 °C to +105 °C
4. Storage Temperature: -55 °C to +105 °C
5. Moisture Sensitivity Level: Level 1 (MSL1)



Electrostatic Sensitive Device (ESD)

B. ELECTRICAL CHARACTERISTIC:

Item	Unit	Min.	Typ.	Max.
Center Frequency	MHz	-	1227.6	-
Minimum Insertion Loss IL_{min}	dB	-	1.4	1.8
3 dB Bandwidth	MHz	-	76	-
Amplitude Ripple (1217.6 ~ 1237.6 MHz)	dBp-p	-	0.3	1.5
Return Loss (1217.6 ~ 1237.6 MHz)	dB	8	10	-
Group Delay (1217.6 ~ 1237.6 MHz)	ns	-	15	25
Group Delay Ripple (1217.6 ~ 1237.6 MHz)	ns	-	4	15
Attenuation (Reference from 0 dB)				
300 ~ 1152 MHz	dB	25	31	-
1302 ~ 1900 MHz	dB	30	33	-
1900 ~ 3000 MHz	dB	25	33	-

C. MEASUREMENT CIRCUIT:

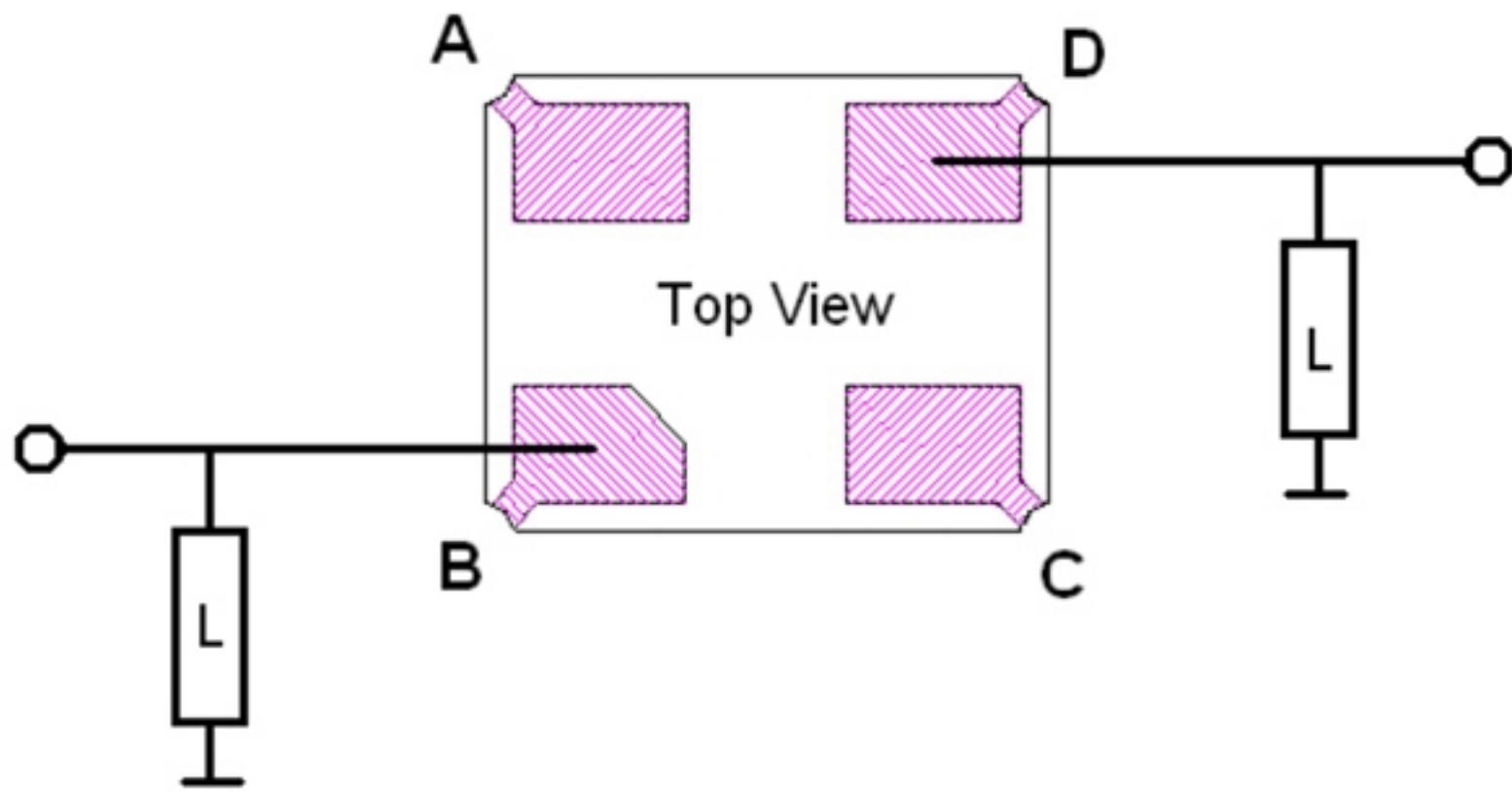

$L = 11 \text{ nH}$ (With LQW2BAN11NG inductor)

D. OUTLINE DRAWING:

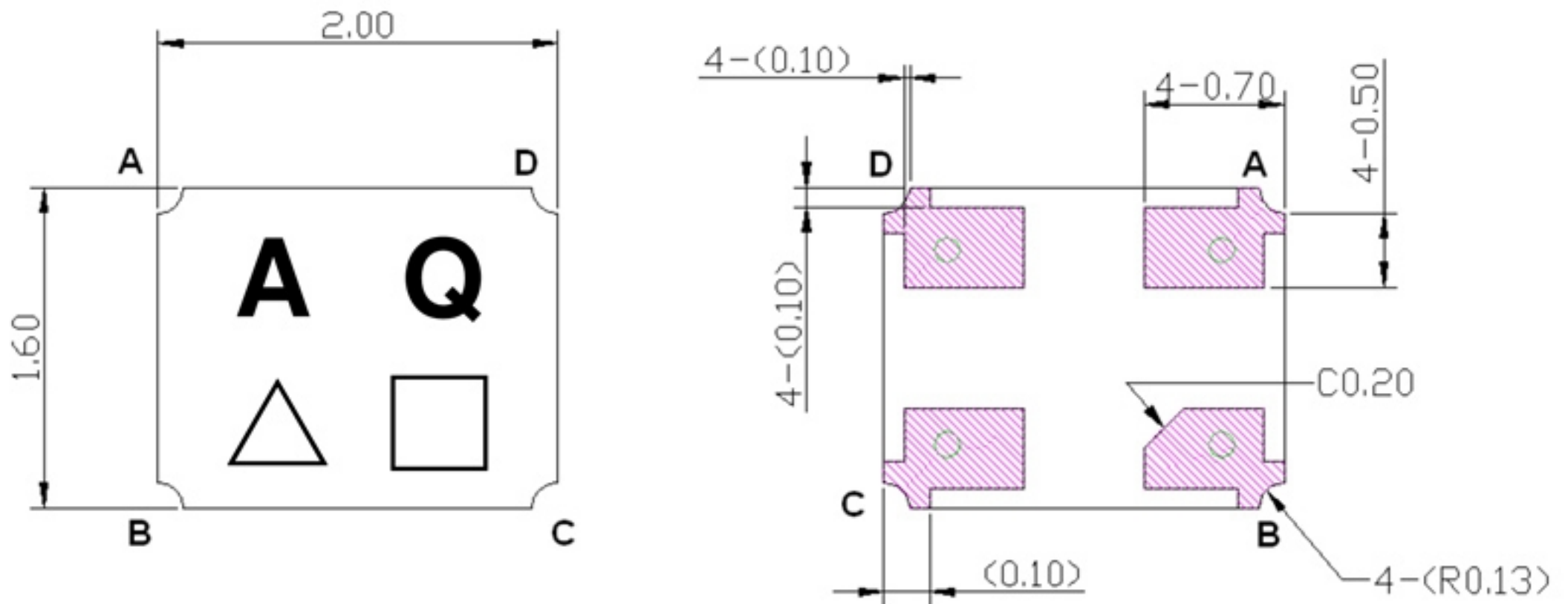

#B:	Input
#D:	Output
#A,C:	Ground
Unit:	mm

\triangle : Year(2021:1, 2022:2 2030:0)

\square : Week(A~Z:Week01~26, a~z:Week27~52)

E. Frequency Characteristics :

Span 800 MHz

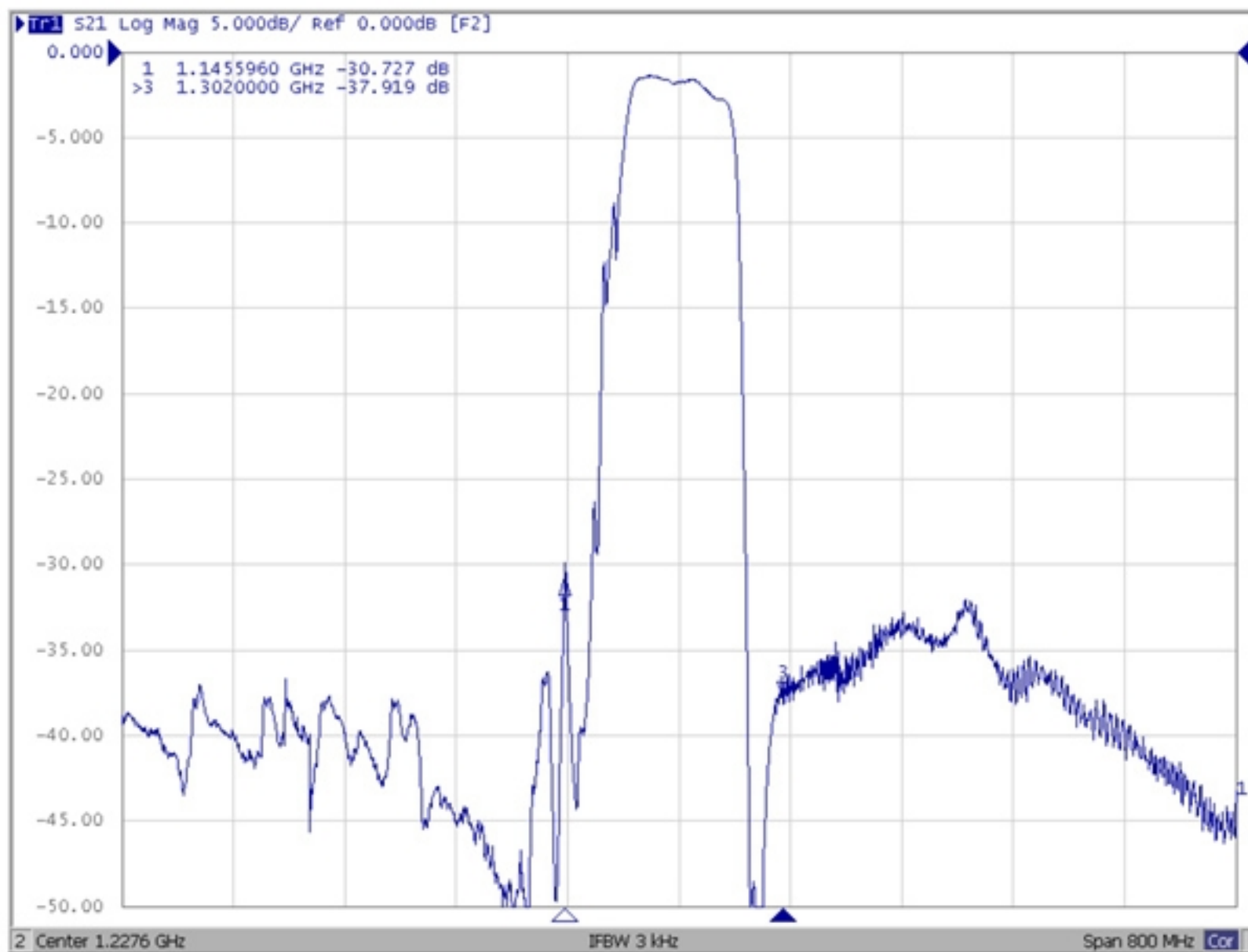

Span 3000 MHz

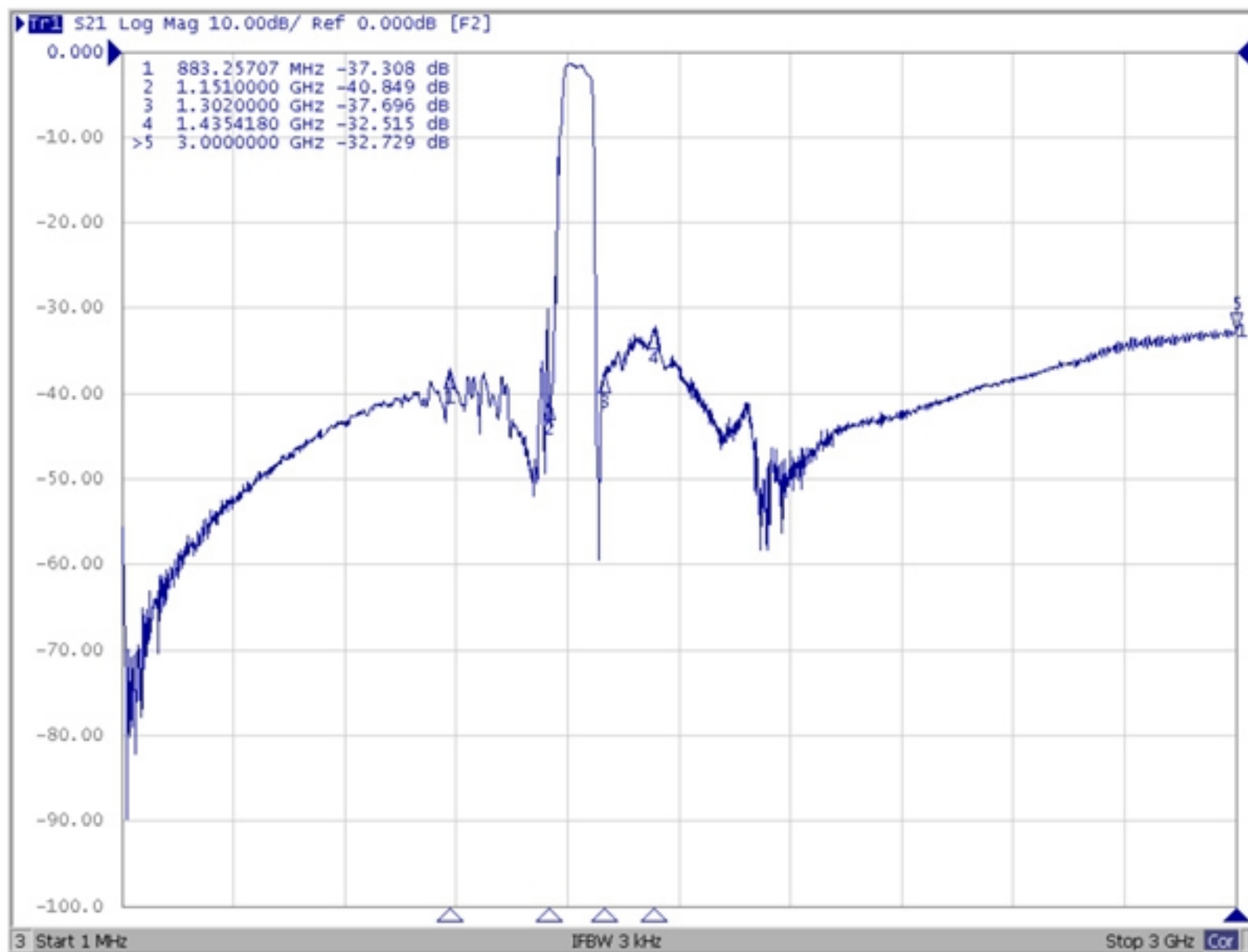

Span 200 MHz

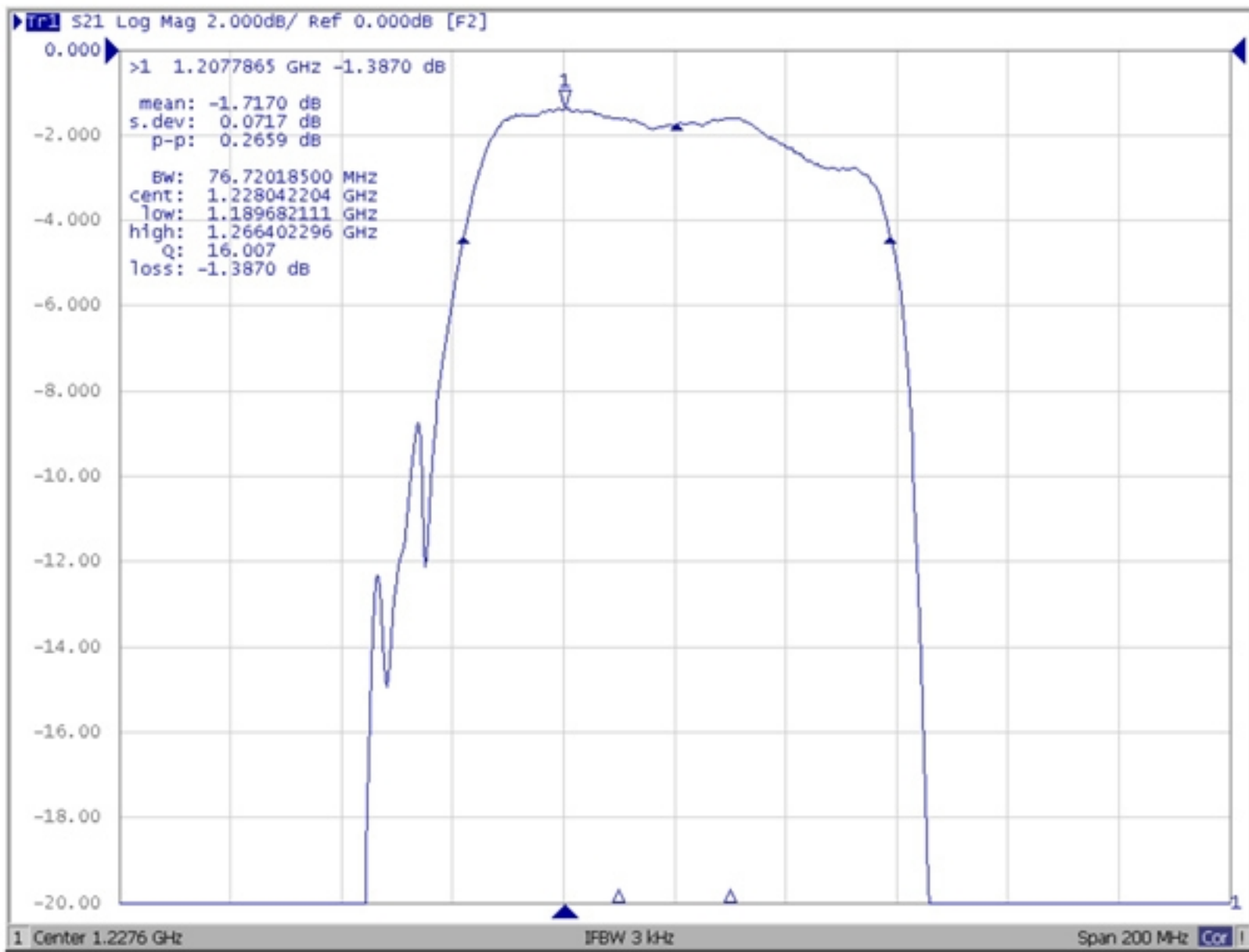

Span 100 MHz (Group Delay)

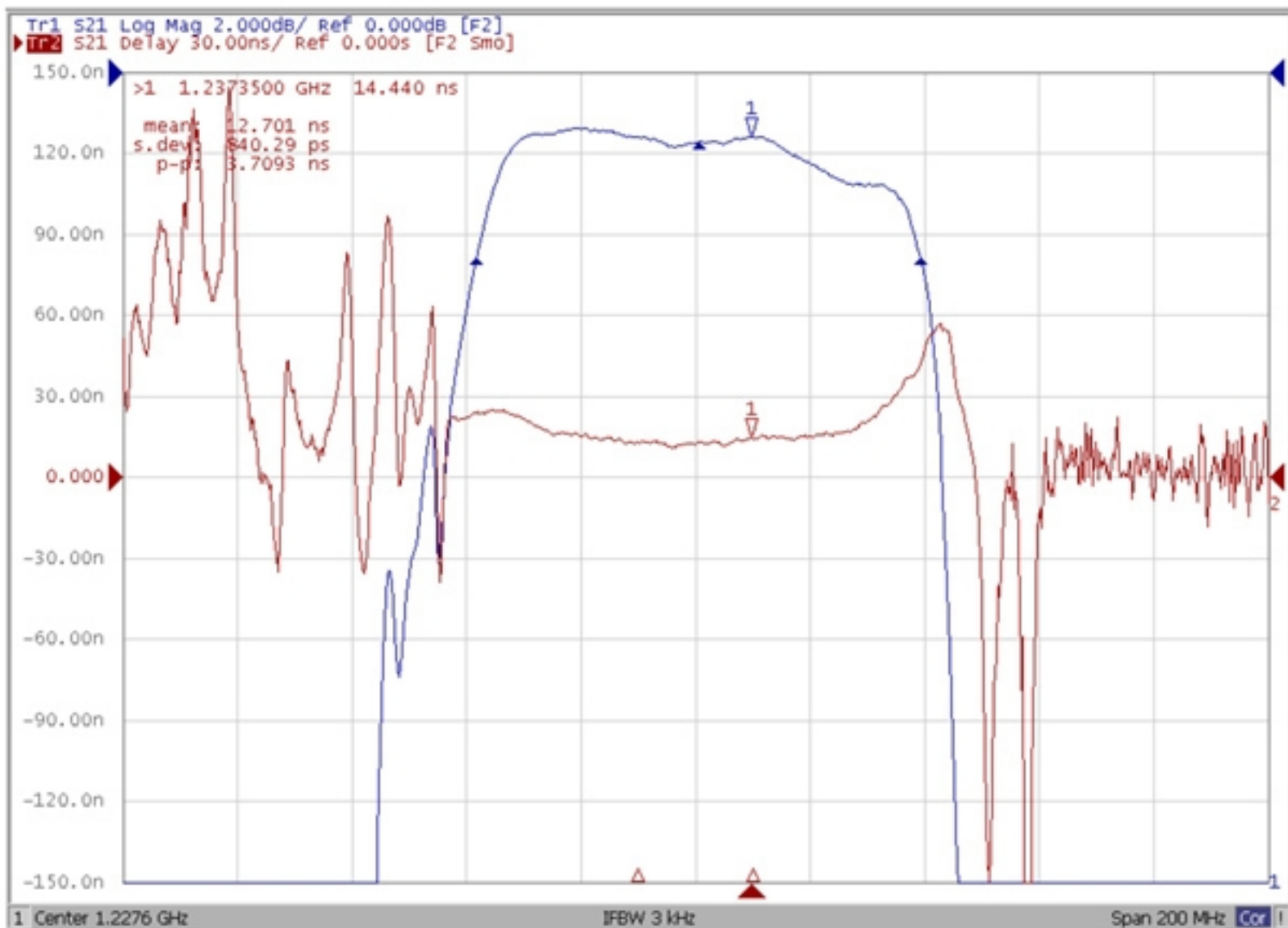

Span 100 MHz (Reflective Characteristic)

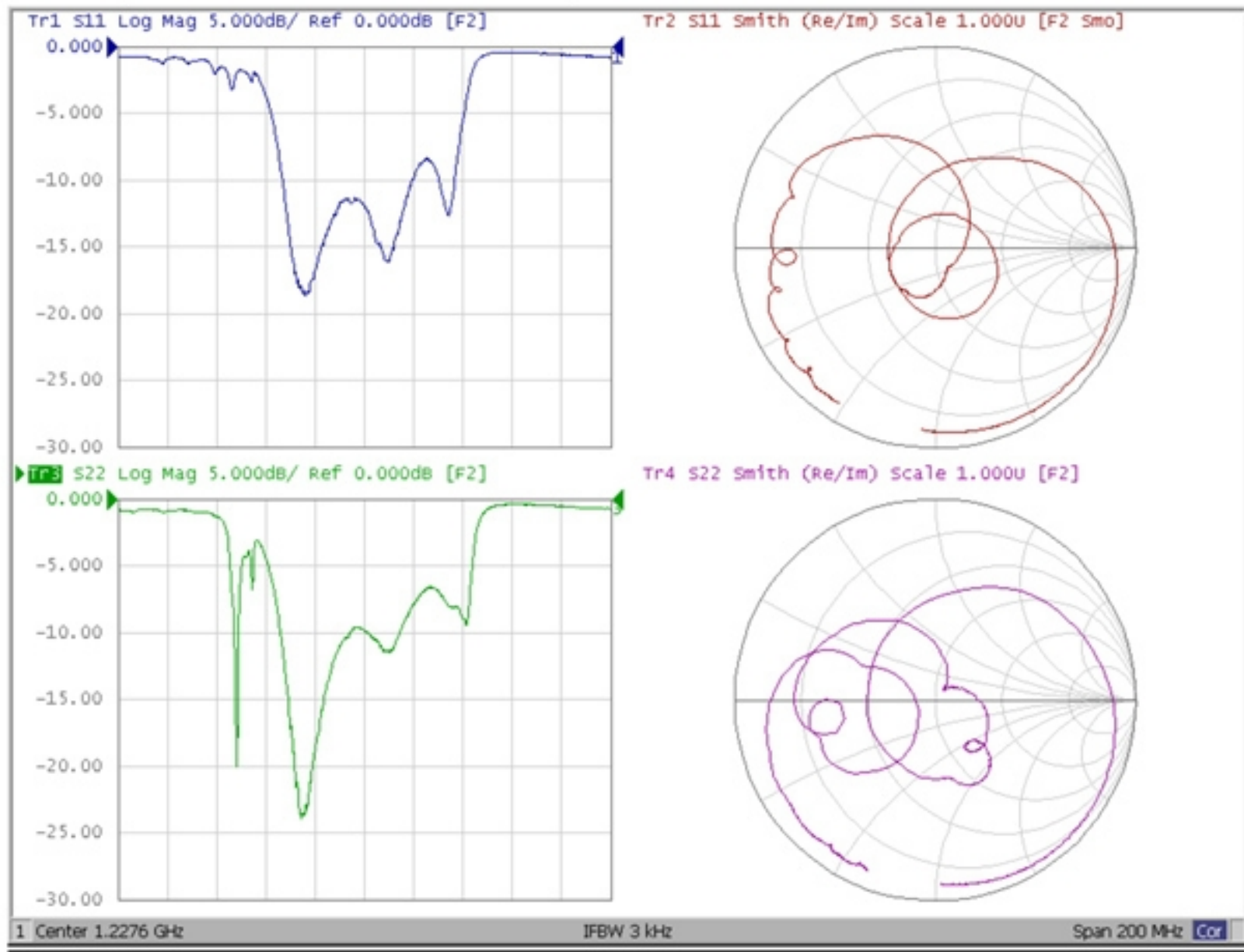

F. PCB FOOTPRINT:

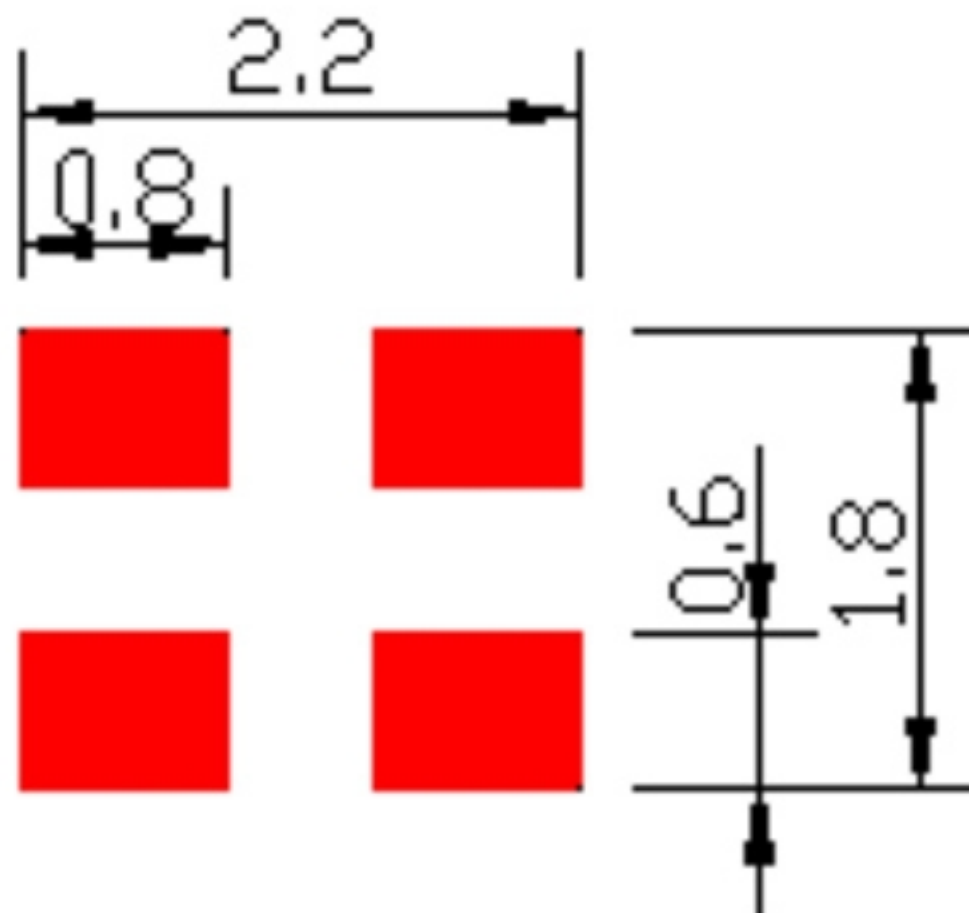

G. PACKING:

1. REEL DIMENSION

(Please refer to FR-75D10 for packing quantity)

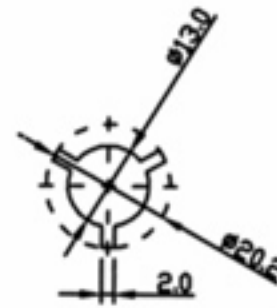
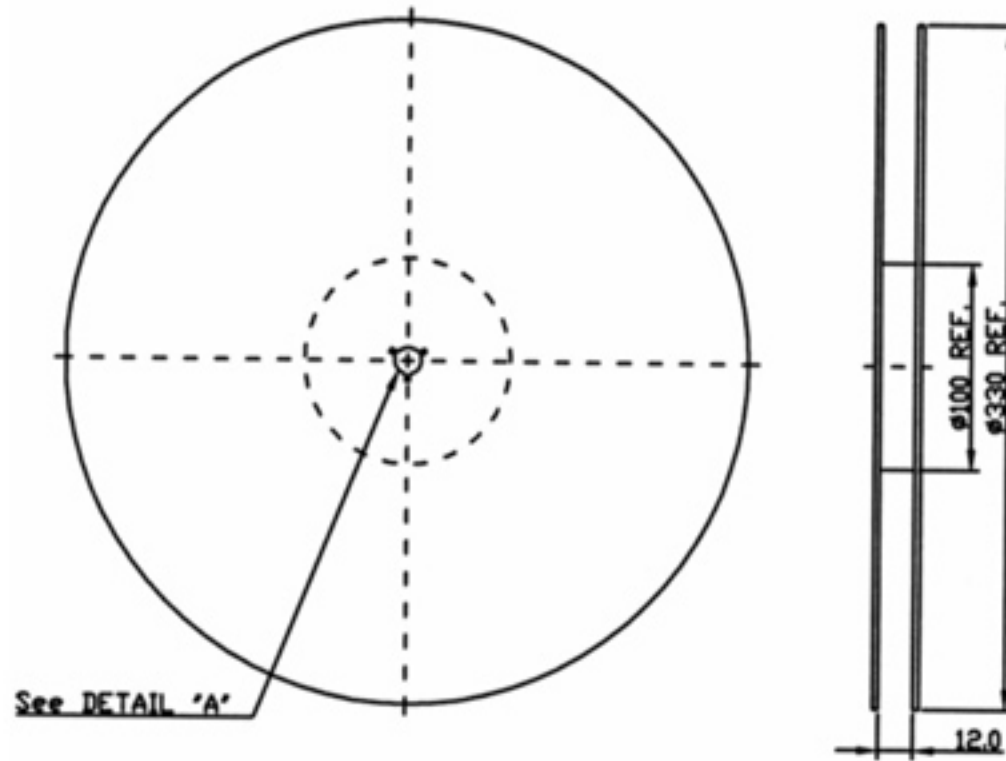

2. TAPE DIMENSION

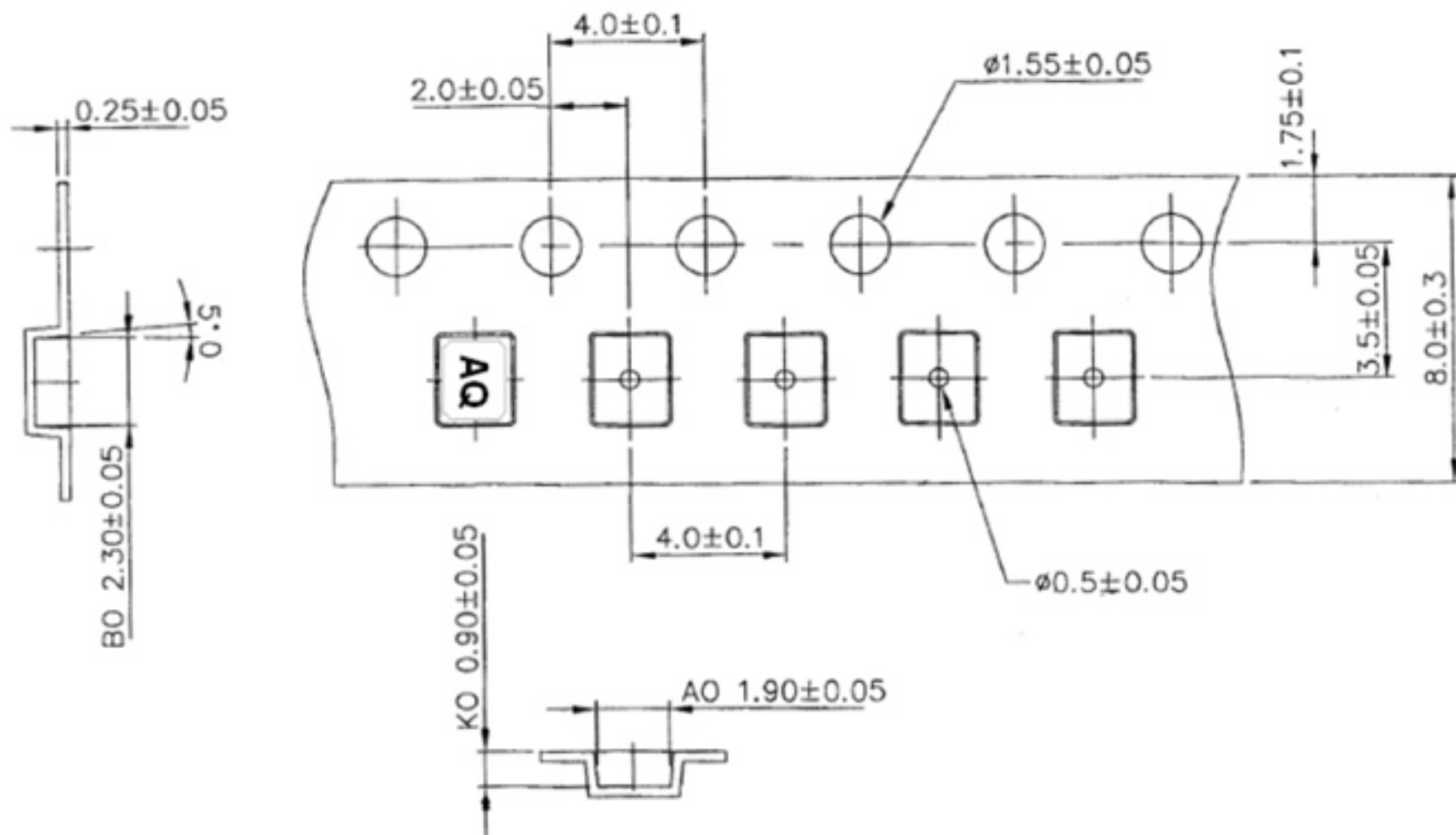

H. RECOMMENDED REFLOW PROFILE :

1. Preheating shall be fixed at $150\sim 180^{\circ}\text{C}$ for $60\sim 90$ seconds.
2. Ascending time to preheating temperature 150°C shall be 30 seconds min.
3. Heating shall be fixed at 220°C for $50\sim 80$ seconds and at $260^{\circ}\text{C} +0/-5^{\circ}\text{C}$ peak ($20\sim 40\text{sec}$).
4. Time: 2 times.

