

A. MAXIMUM RATING:

1. Input Power Level: 20 dBm
2. DC Voltage : 3 V
3. Operating Temperature: -40 °C to +85 °C
4. Storage Temperature: -40 °C to +85 °C
5. Moisture Sensitive Level: MSL 1

Electrostatic Sensitive Device

B. ELECTRICAL CHARACTERISTICS:

| Item | Unit | Min. | Typ. | Max. |
|--|-------|------|------|------|
| Center Frequency | MHz | - | 1505 | - |
| Insertion loss (1492 ~1518 MHz) | dB | - | 1.6 | 3.0 |
| Amplitude ripple (1492 ~1518 MHz) | dB | - | 0.4 | 1.6 |
| VSWR (1492 ~1518 MHz) | - | - | 1.5 | 2.2 |
| Attenuation (Reference level from 0 dB) | | | | |
| 10 ~ 1430 MHz | dB | 30 | 35 | - |
| 1430 ~ 1460 MHz | dB | 15 | 35 | - |
| 1550 ~ 1560 MHz | dB | 30 | 50 | - |
| 1560 ~ 2000 MHz | dB | 33 | 40 | - |
| 2000 ~ 3000 MHz | dB | 33 | 35 | - |
| Temperature Coefficient of Frequency | ppm/k | - | -36 | - |

C. MEASUREMENT CIRCUIT:

HP Network analyzer

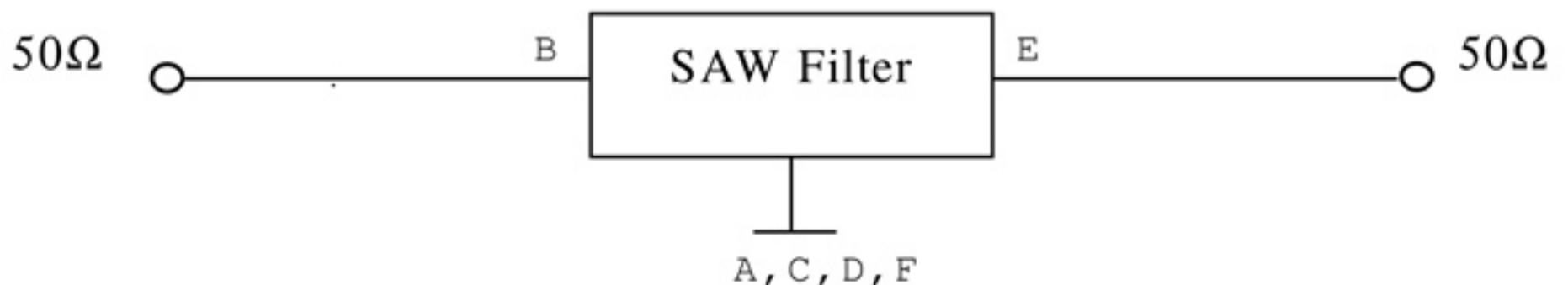

D.OUTLINE DRAWING:

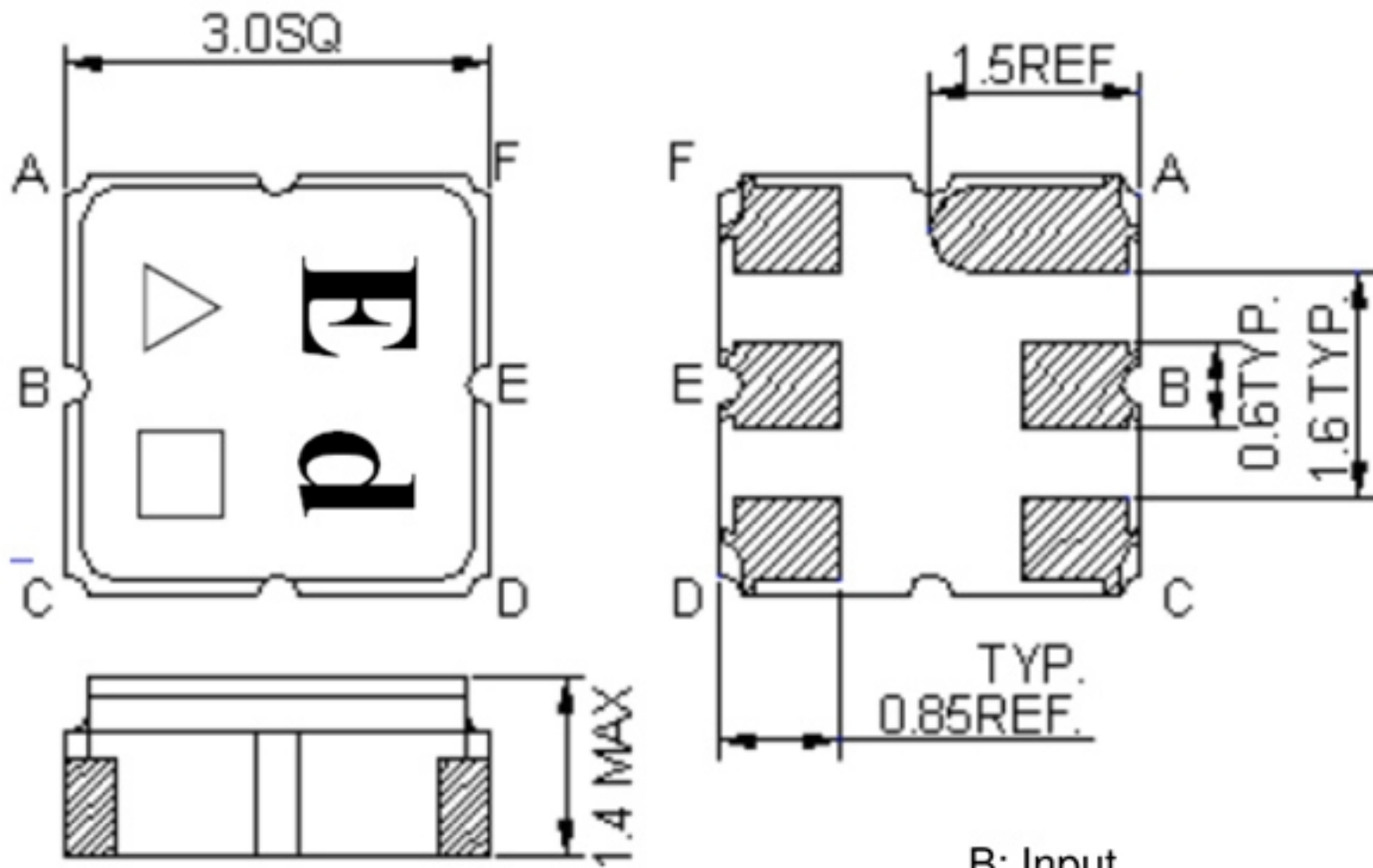

B: Input
 E: Output
 A, C, D, F: Ground
 Unit: mm

\triangle : Year Code (2009->9, 2010->0, ..., 2018->8)
 \square : Date Code (Follow the table from planner each year)

| | | | | | | | | | | | | |
|------|------|------|------|------|------|------|------|------|------|------|------|------|
| WK01 | WK02 | WK03 | WK04 | WK05 | WK06 | WK07 | WK08 | WK09 | WK10 | WK11 | WK12 | WK13 |
| A | B | C | D | E | F | G | H | I | J | K | L | M |
| WK14 | WK15 | WK16 | WK17 | WK18 | WK19 | WK20 | WK21 | WK22 | WK23 | WK24 | WK25 | WK26 |
| N | O | P | Q | R | S | T | U | V | W | X | Y | Z |
| WK27 | WK28 | WK29 | WK30 | WK31 | WK32 | WK33 | WK34 | WK35 | WK36 | WK37 | WK38 | WK39 |
| a | b | c | d | e | f | g | h | i | j | k | l | m |
| WK40 | WK41 | WK42 | WK43 | WK44 | WK45 | WK46 | WK47 | WK48 | WK49 | WK50 | WK51 | WK52 |
| n | o | p | q | r | s | t | u | v | w | x | y | z |

E. Frequency Characteristics :

Span 250 MHz

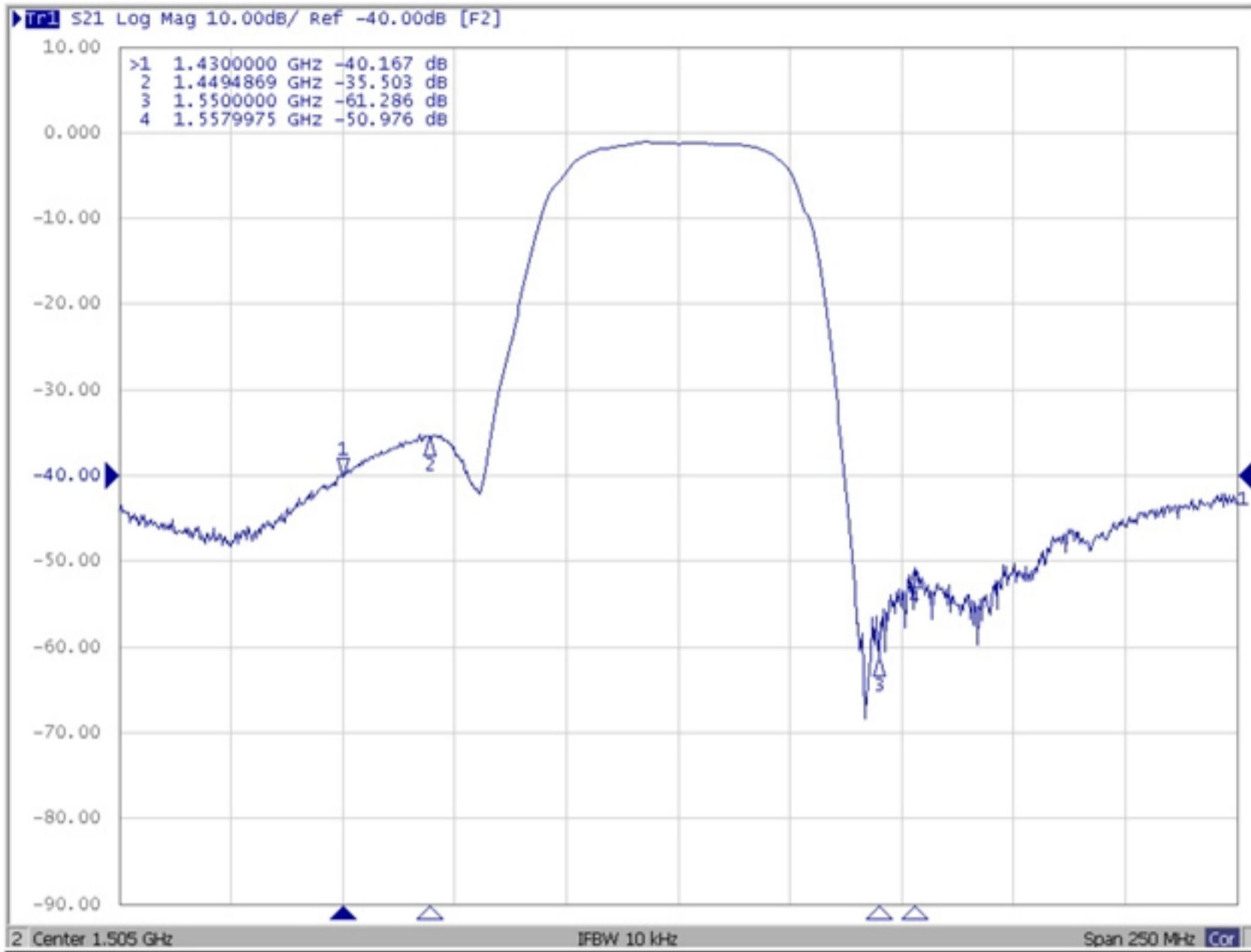

Span 3000 MHz

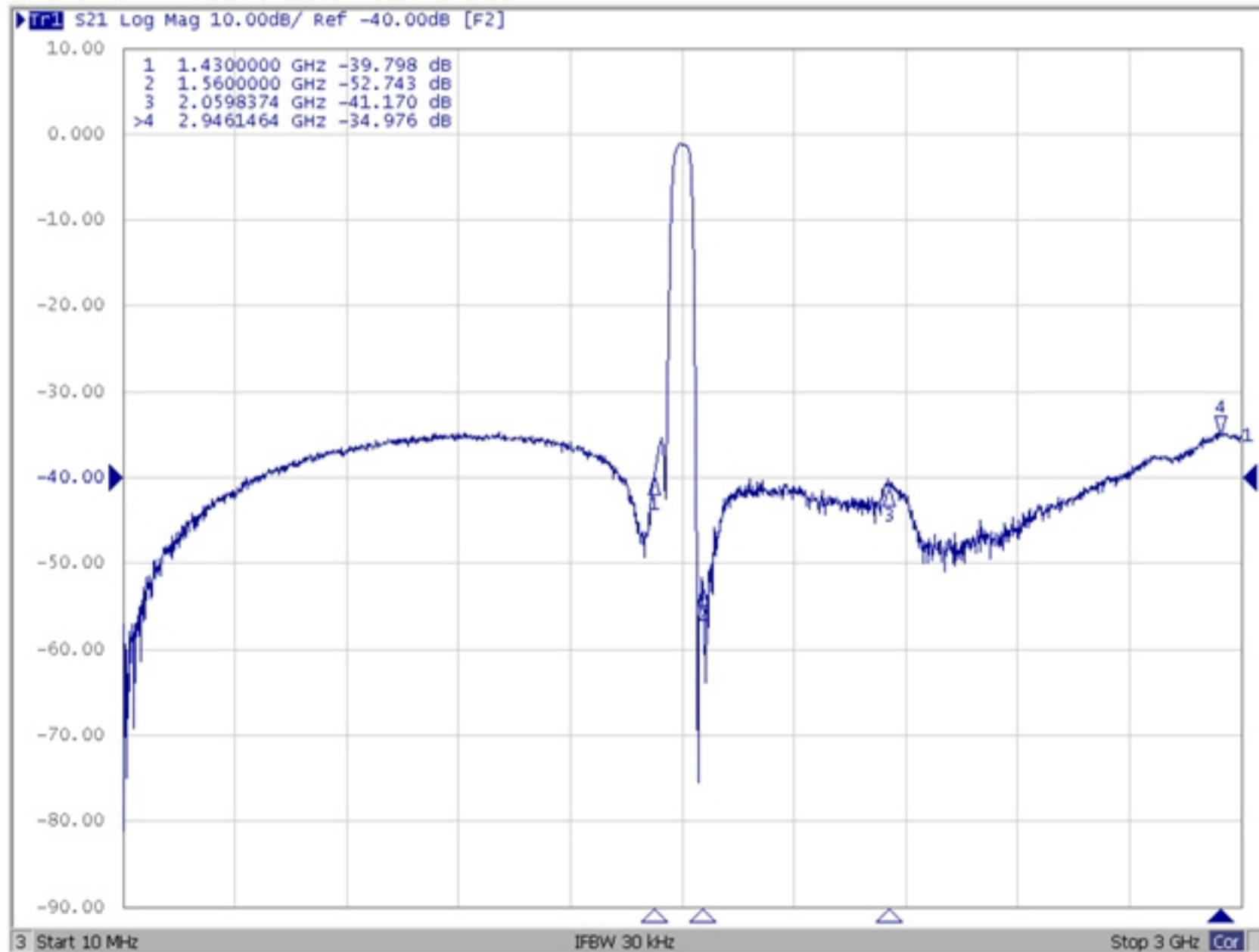

Span 50 MHz

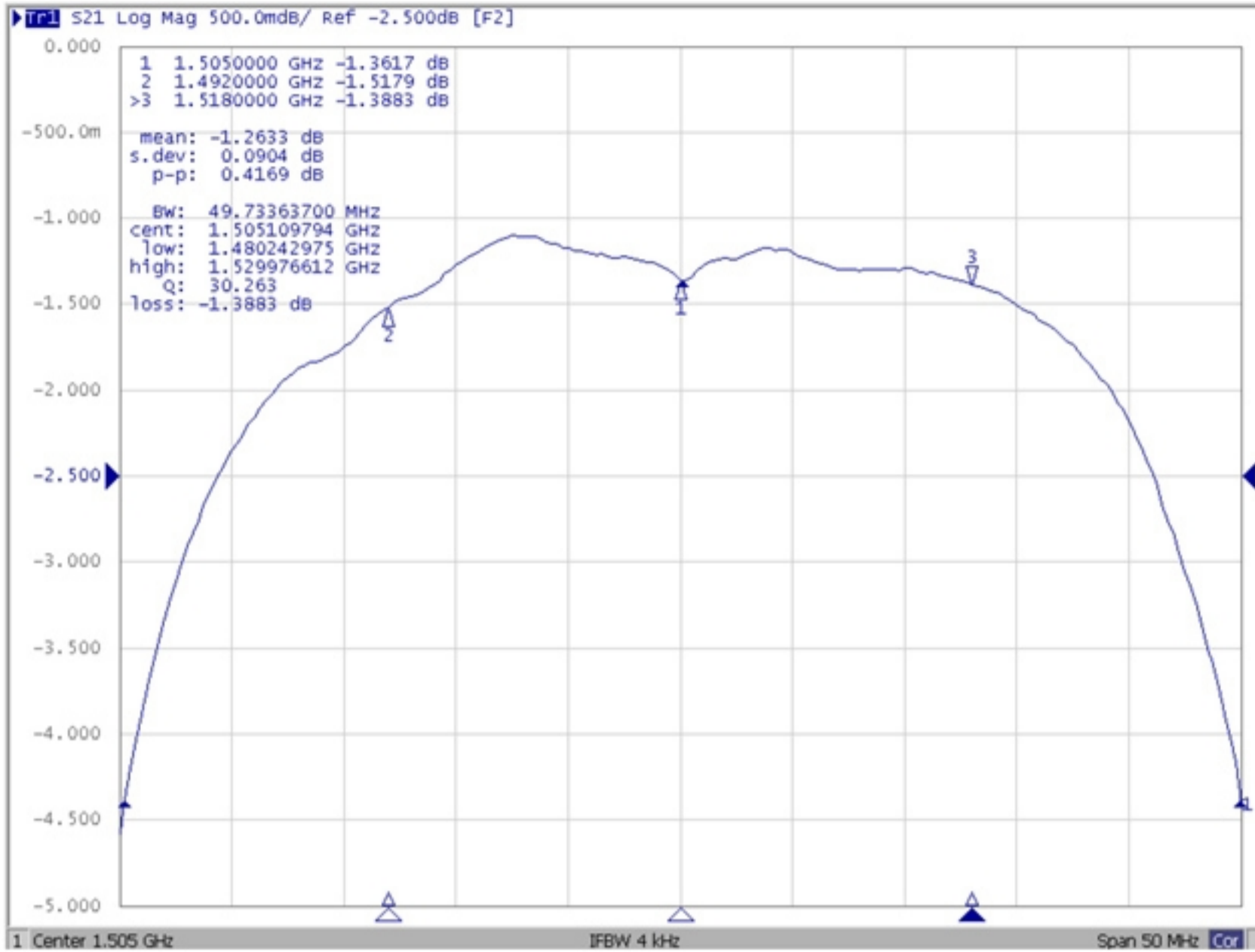

VWSR (Span 100)

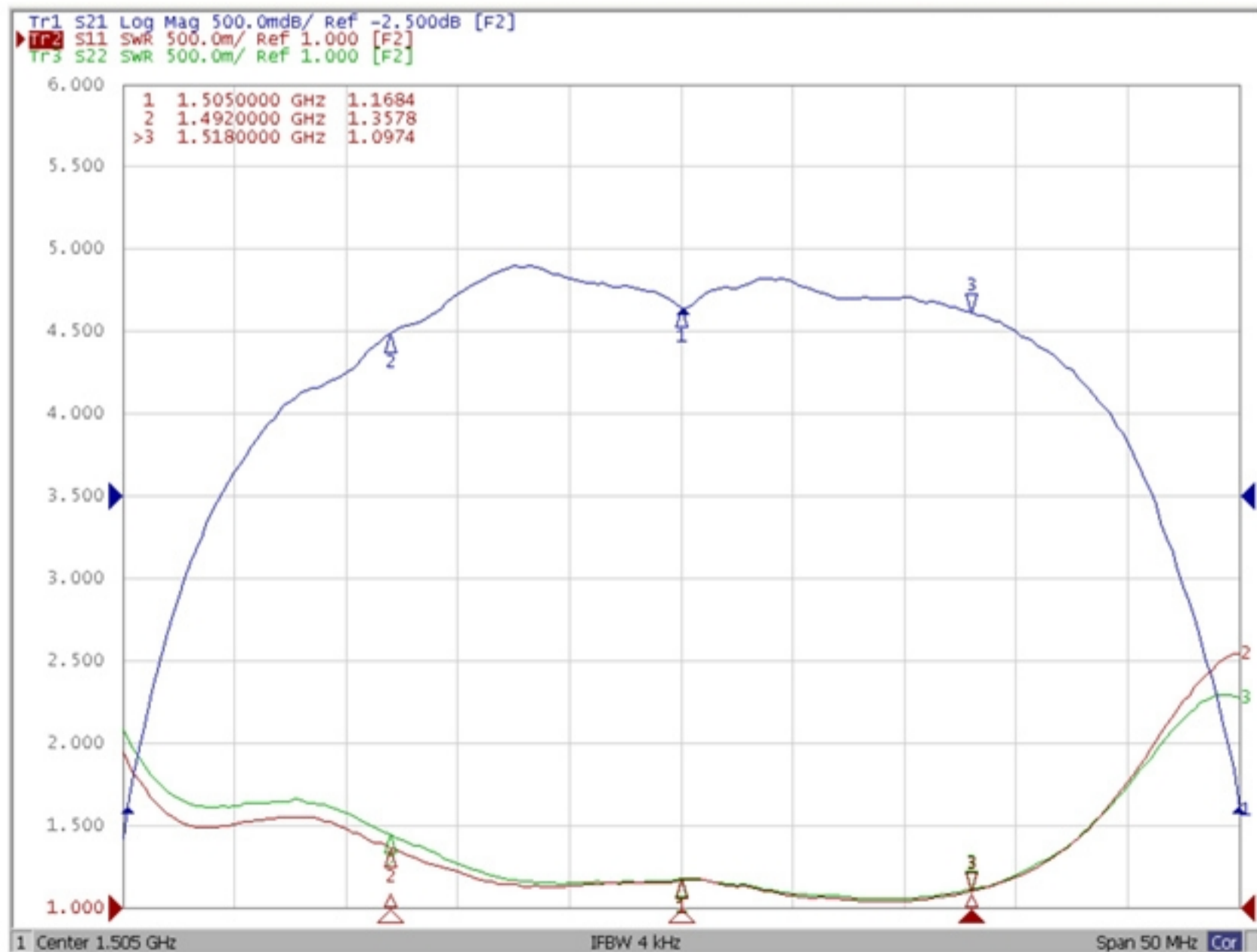

F. PCB FOOTPRINT:

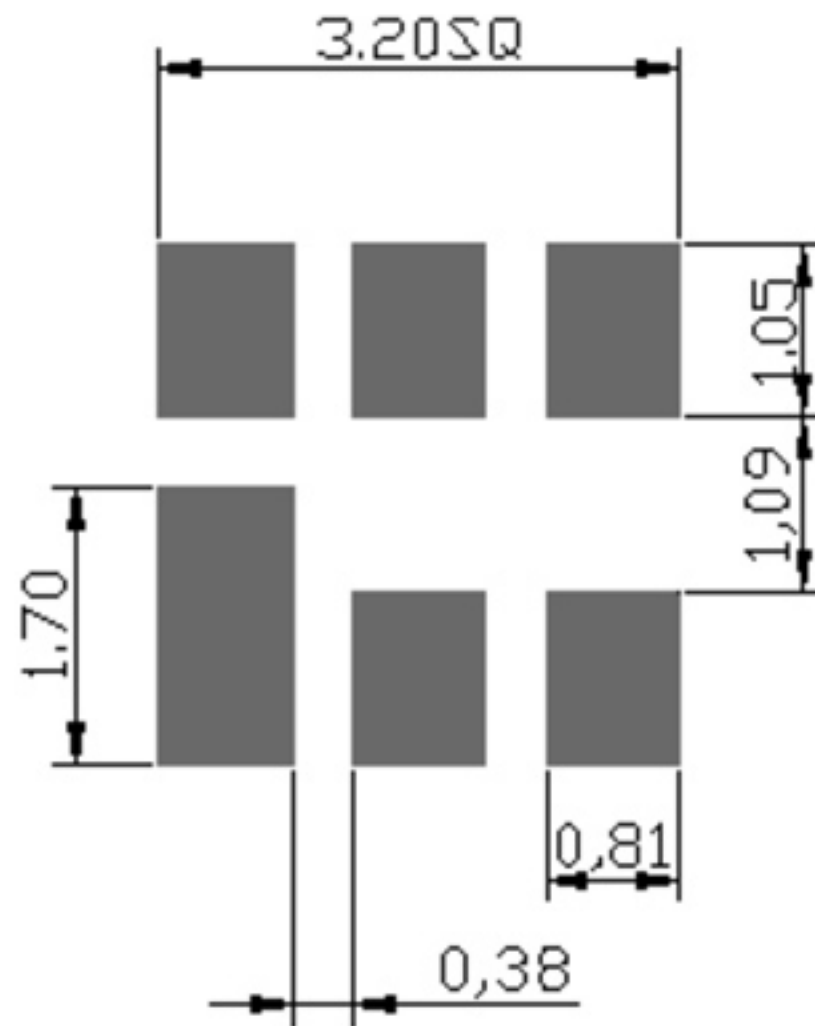

G. PACKING:

1. REEL DIMENSION
(Please refer to FR-75D10 for packing quantity)

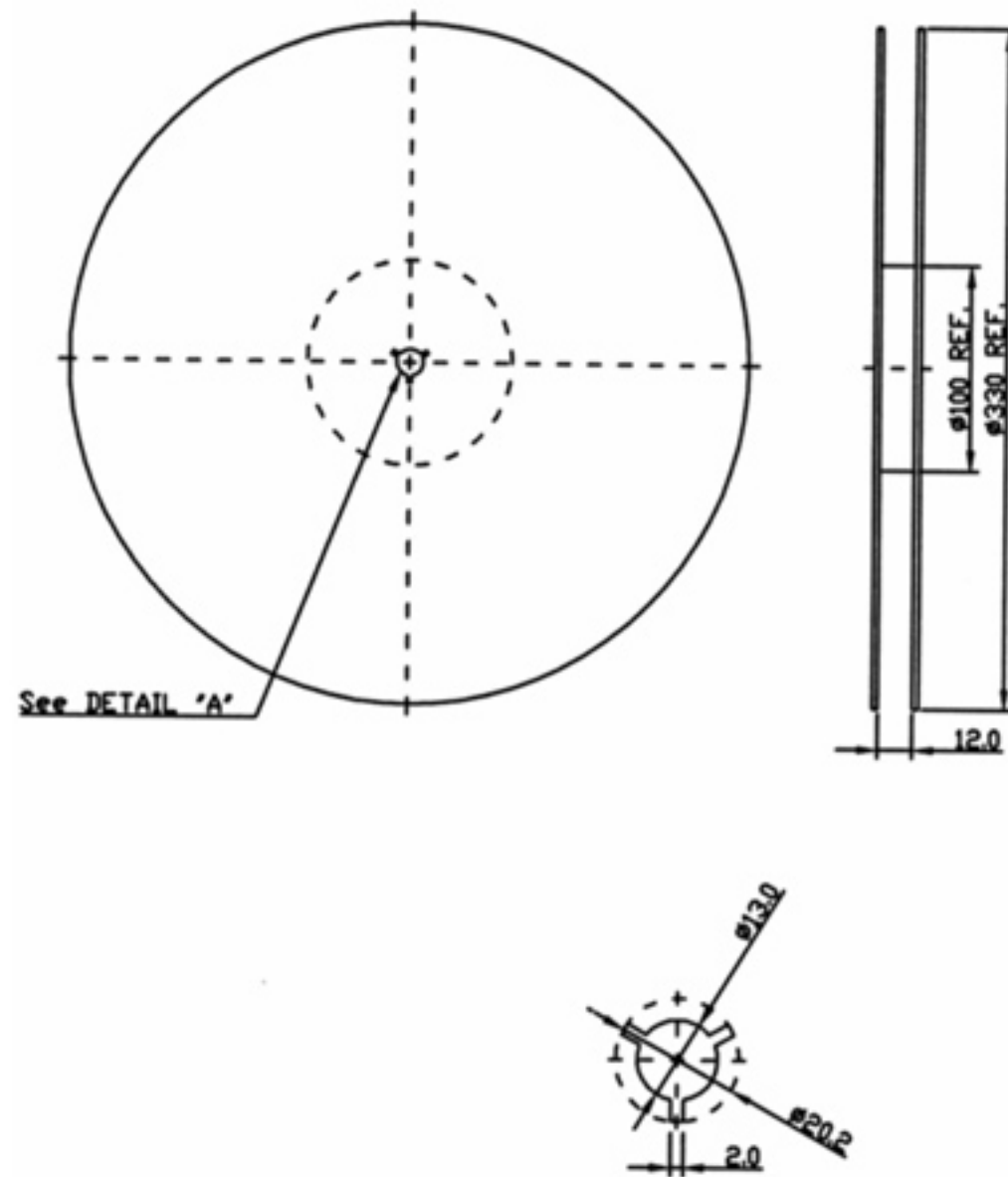

2. TAPE DIMENSION

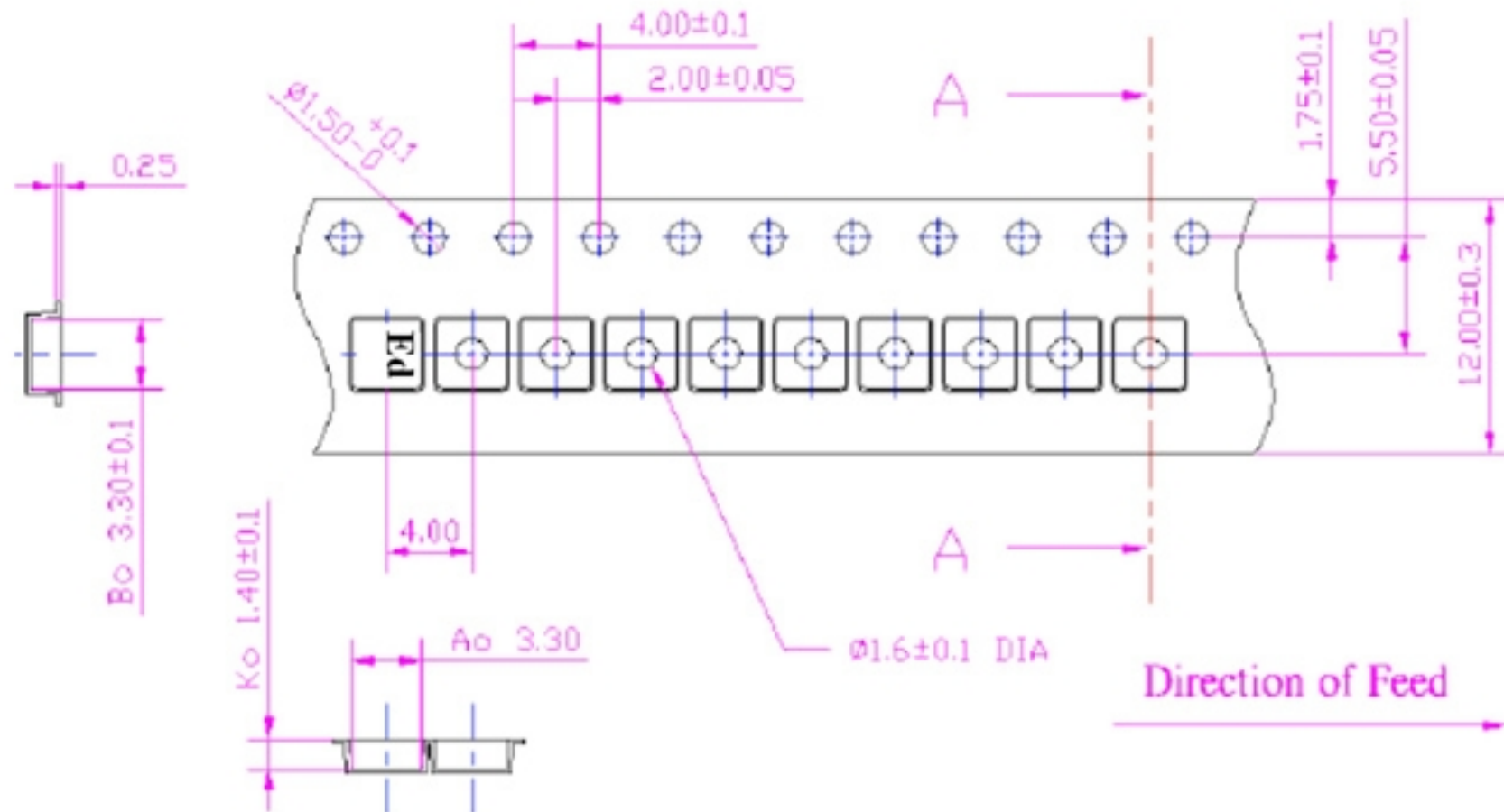

H. RECOMMENDED REFLOW PROFILE :

1. Preheating shall be fixed at $150 \sim 180^\circ\text{C}$ for $60 \sim 90$ seconds.
2. Ascending time to preheating temperature 150°C shall be 30 seconds min.
3. Heating shall be fixed at 220°C for $50 \sim 80$ seconds and at $260^\circ\text{C} +0/-5^\circ\text{C}$ peak ($20 \sim 40$ sec).
4. Time: 2 times.

