

## SAW Filter 1575.42 MHz

MODEL NO.: TA2382A

REV. NO.:1

### A. MAXIMUM RATING:

1. Input Power Level: 10 dB<sub>m</sub>
2. DC voltage: 7.5 V
3. Operating Temperature: -40°C to +85°C
4. Storage Temperature: -40°C to +95°C
5. Moisture Sensitivity Level: Level 3(MSL3)

RoHS Compliant

Lead-free soldering

Electrostatic Sensitive Device (ESD)

### B. ELECTRICAL CHARACTERISTICS:

Item	Unit	Min.	Typ.	Max.	
Center frequency <b>F<sub>c</sub></b>	MHz	-	1575.42	-	
Insertion Loss (1574.42~1576.42 MHz) <b>IL</b>	dB	-	2.1	3.5	
Amplitude Ripple (1574.42~1576.42 MHz)	dB	-	0.1	1.5	
VSWR (1574.42~1576.42 MHz)	-	-	1.6	2.5	
<b>Attenuation</b> (Reference level from 0 dB)					
1475.42 MHz	dB	35	49	-	
1505 MHz	dB	41	54	-	
1535.42 MHz	dB	30	51	-	
1559 MHz (at +25°C only)	dB	10	15	-	
1615.42 MHz	dB	30	59	-	
1675.42 MHz	dB	40	44	-	
Temperature coefficient of frequency	ppm/k	-	-36	-	

### C. MEASUREMENT CIRCUIT:

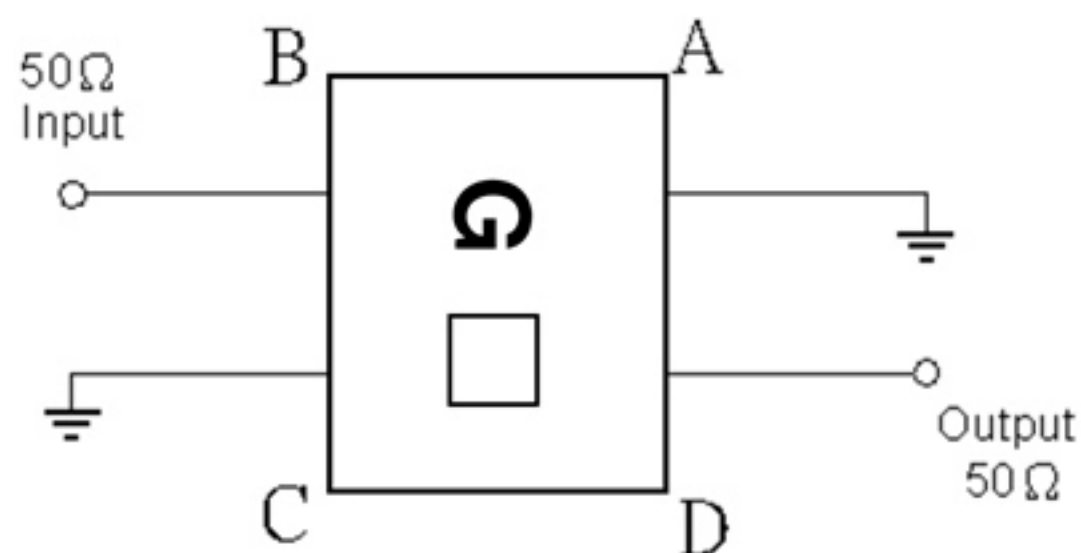

### D. Frequency Characteristics:

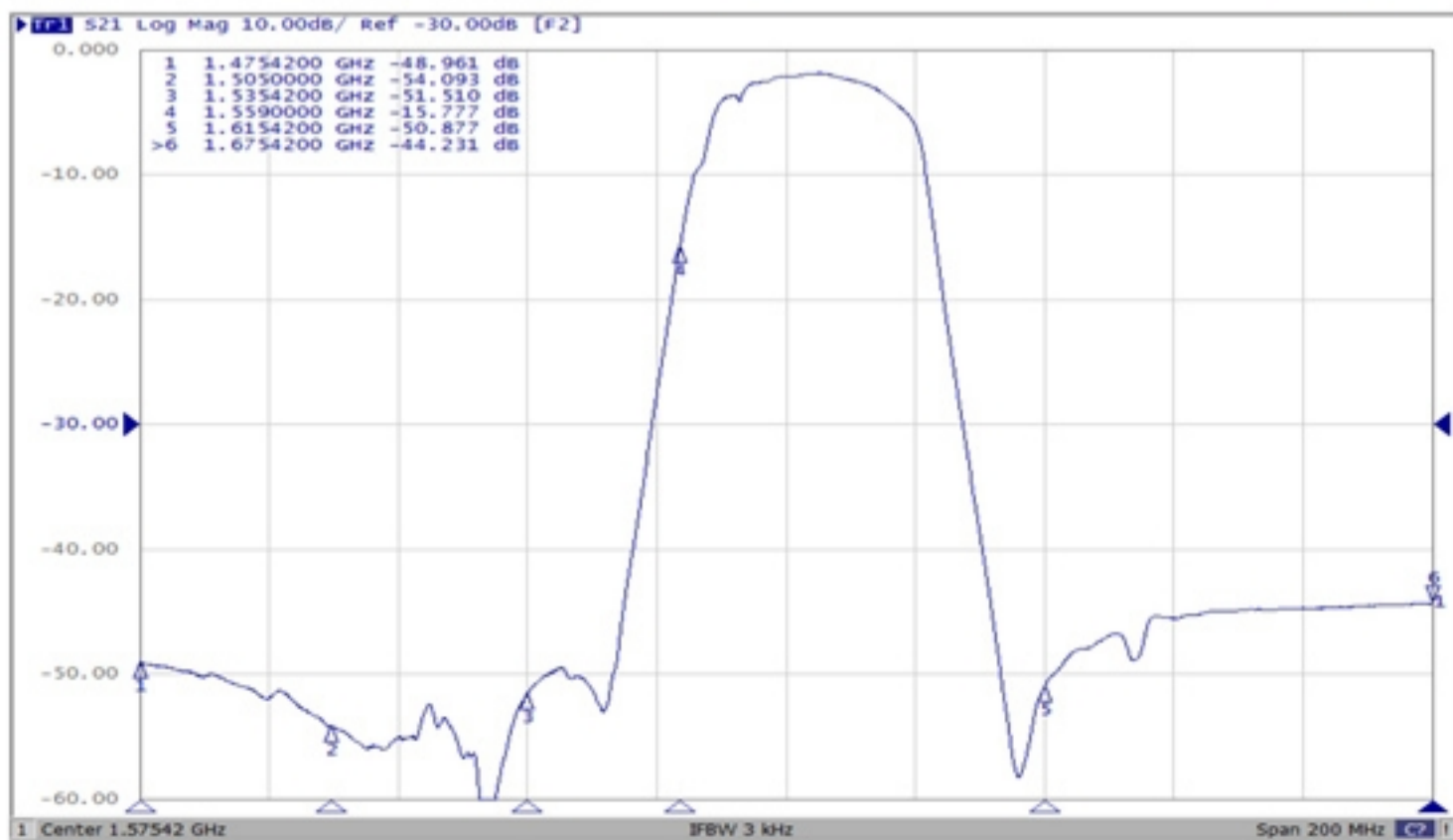
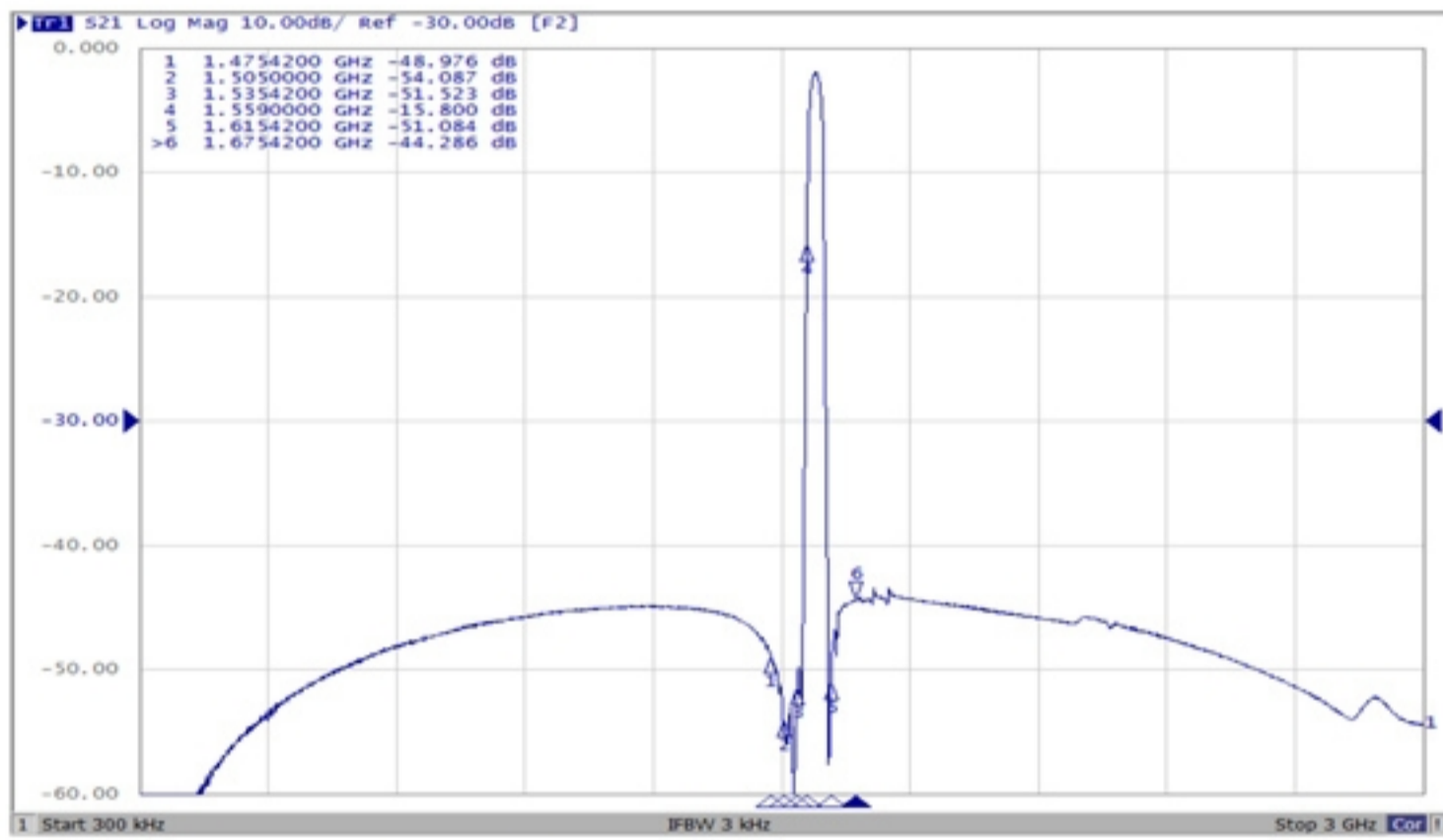

# Reflection Functions:

## S11

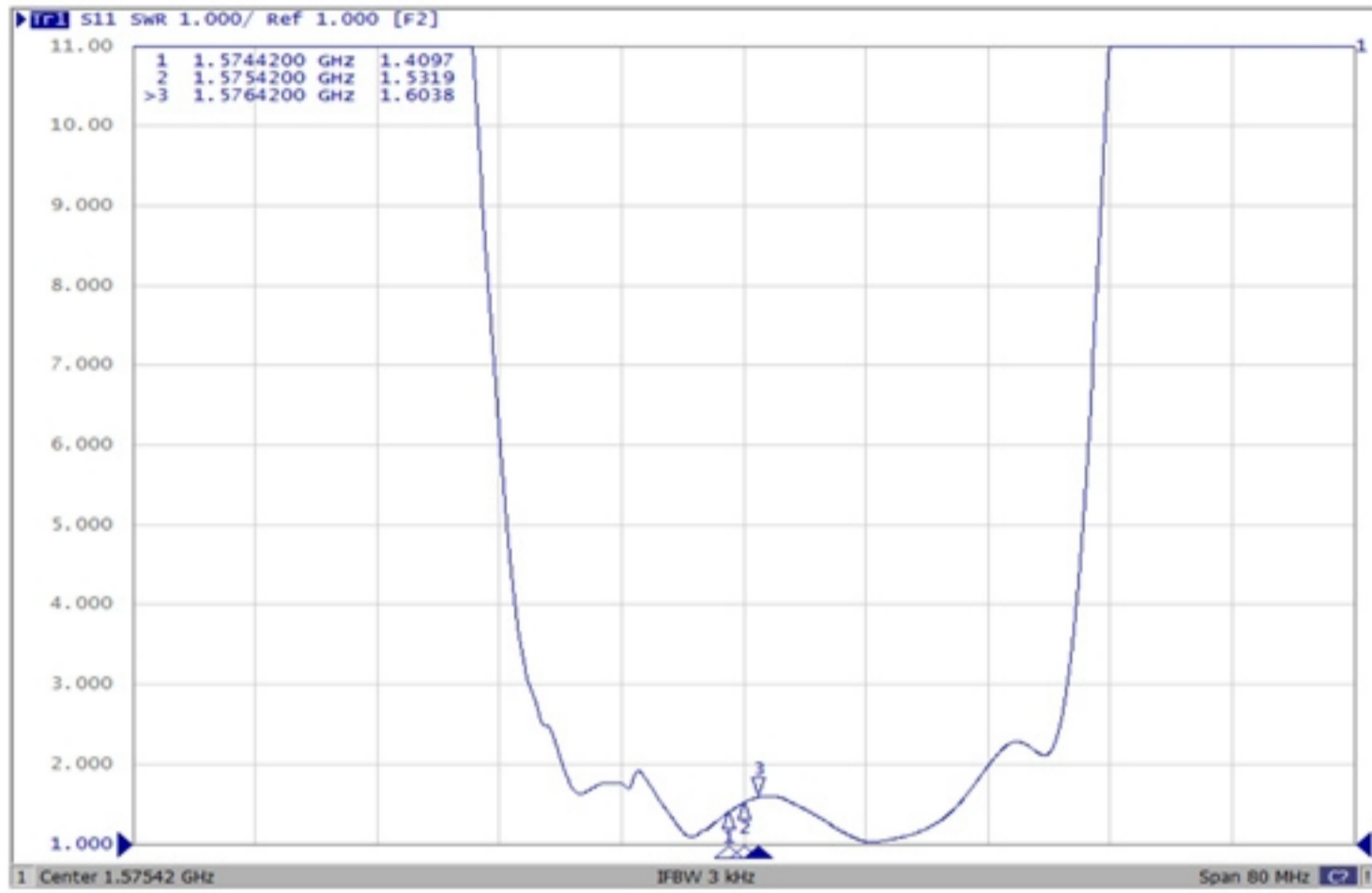

## S22

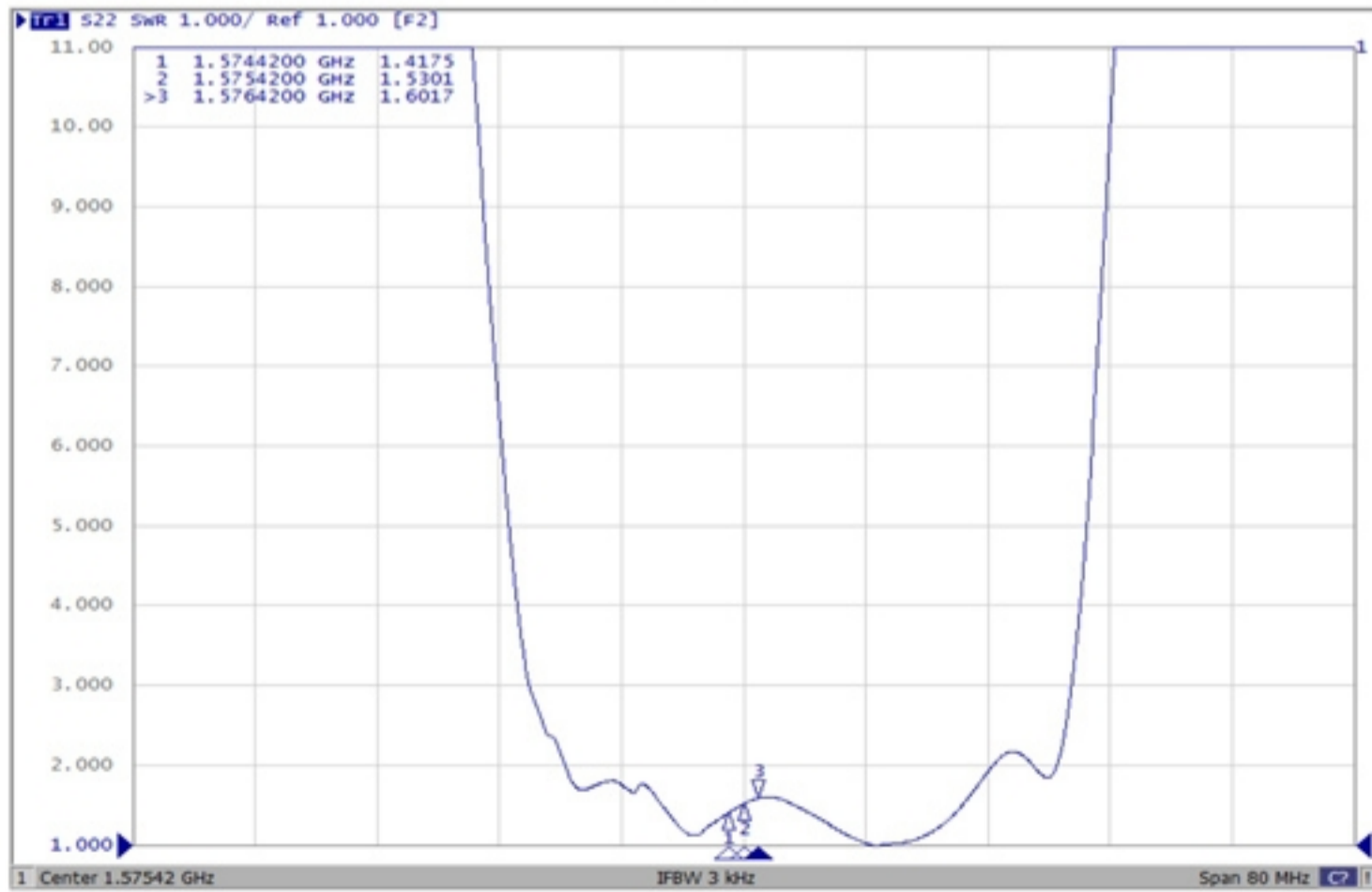

**E. OUTLINE DRAWING:**

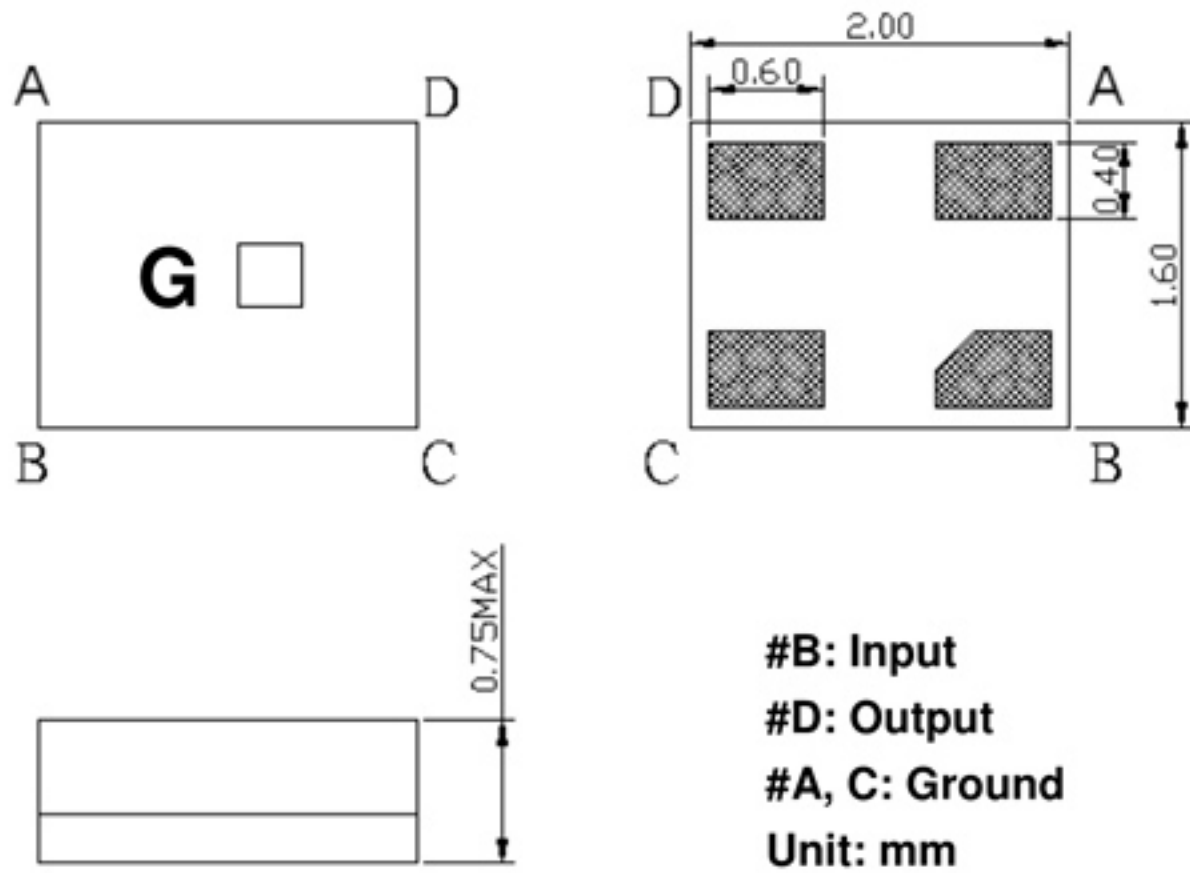

☐ : Year/Month Code (Follow the table)

YEAR/Month	1	2	3	4	5	6	7	8	9	10	11	12
2018	A	B	C	D	E	F	G	H	J	K	L	M
2019	N	P	Q	R	S	T	U	V	W	X	Y	Z
2020	a	b	c	d	e	f	g	h	j	k	i	m
2021	n	p	q	r	s	t	u	v	w	x	y	z
2018	A	B	C	D	E	F	G	H	J	K	L	M
2019	N	P	Q	R	S	T	U	V	W	X	Y	Z
2020	a	b	c	d	e	f	g	h	j	k	i	m
2021	n	p	q	r	s	t	u	v	w	x	y	z

**F. PCB Footprint:**

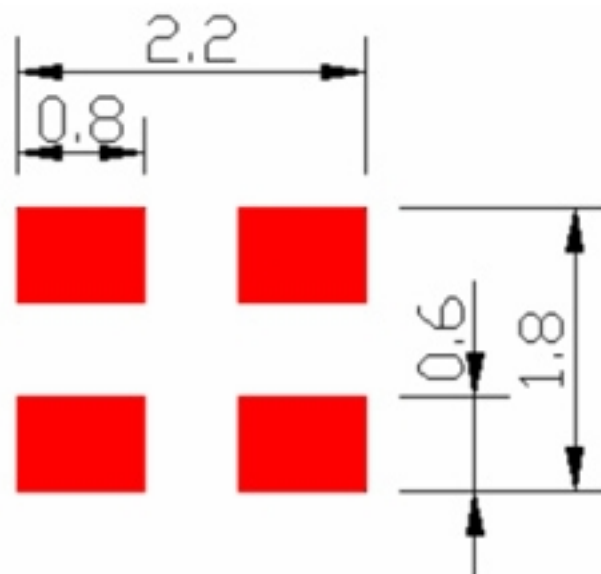

**G. PACKING: (Ref. WI-75M03)**

**1. REEL DIMENSION**

**(Please refer to FR-75D10 for packing quantity)**

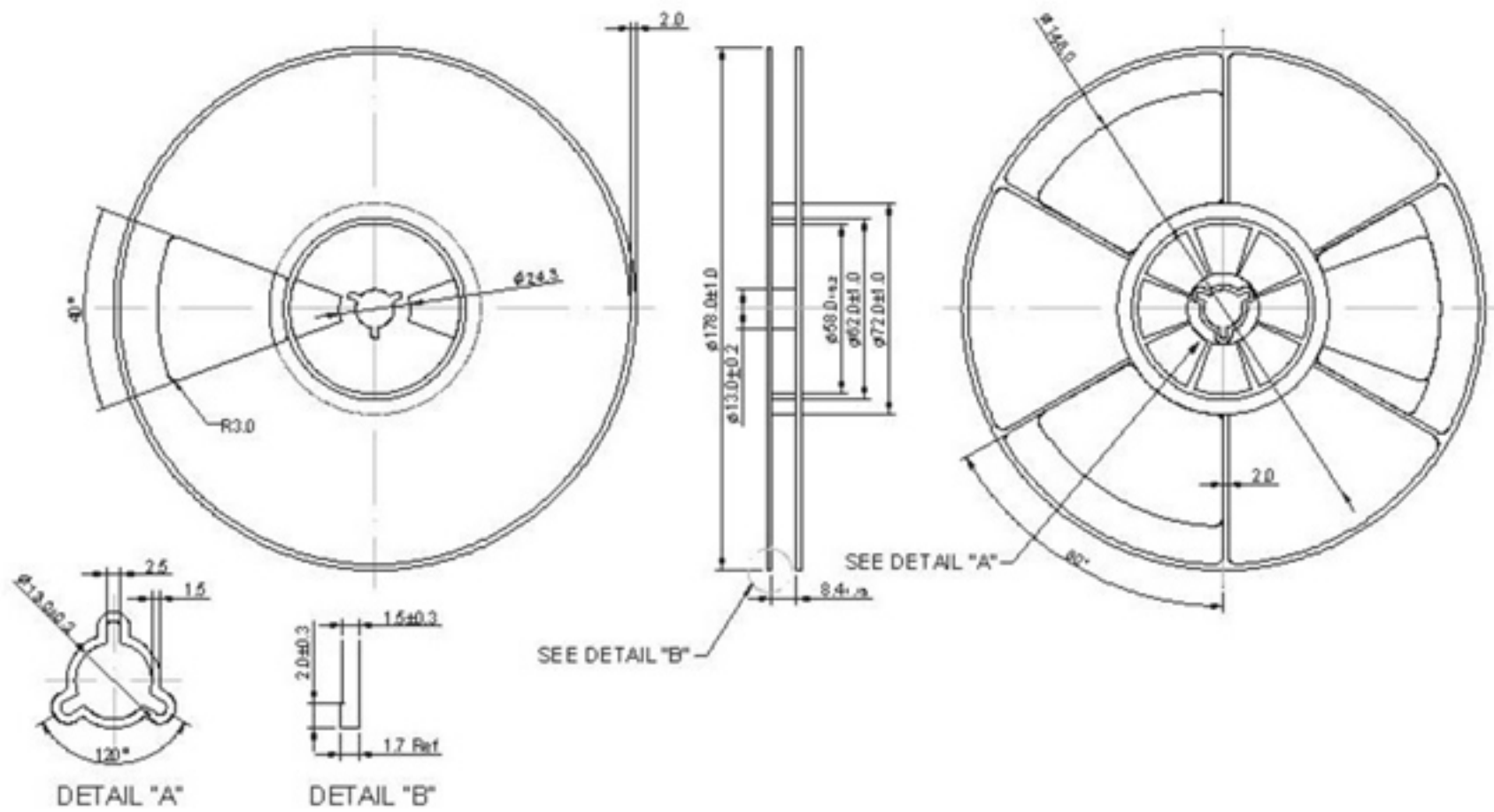

**2. TAPE DIMENSION**

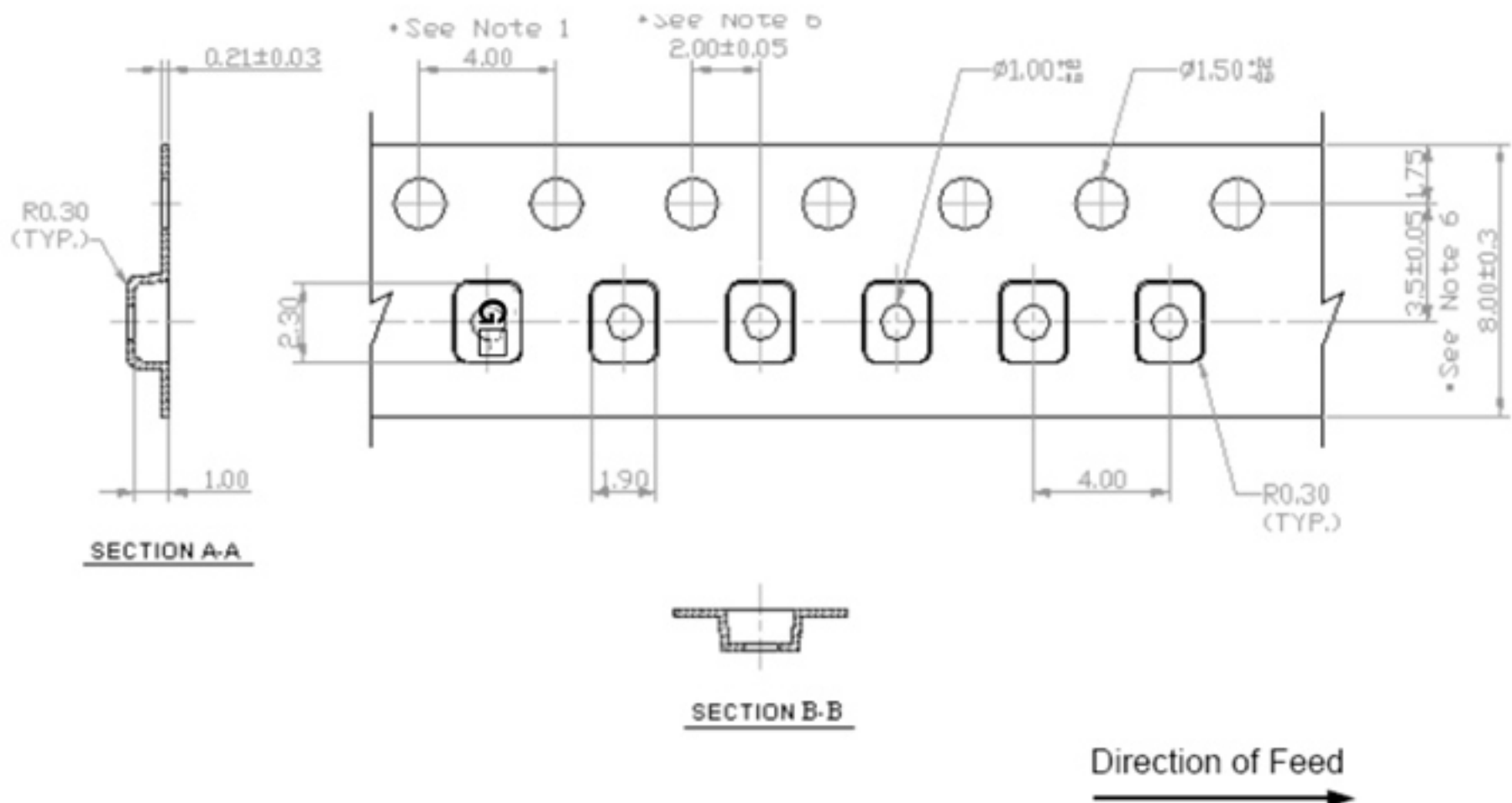

### H. Recommended Reflow Profile:

1. Preheating shall be fixed at  $150\sim 180^{\circ}\text{C}$  for 60~90 seconds.
2. Ascending time to preheating temperature  $150^{\circ}\text{C}$  shall be 30 seconds min.
3. Heating shall be fixed at  $220^{\circ}\text{C}$  for 50~80 seconds and at  $260^{\circ}\text{C} +0/-5^{\circ}\text{C}$  peak (20~40sec).
4. Time: 2 times.

